

ACCESSORY USER'S GUIDE 2024



FEATURED ACCESSORIES



DESIGNER™
EMBELLISHMENT
ATTACHMENT

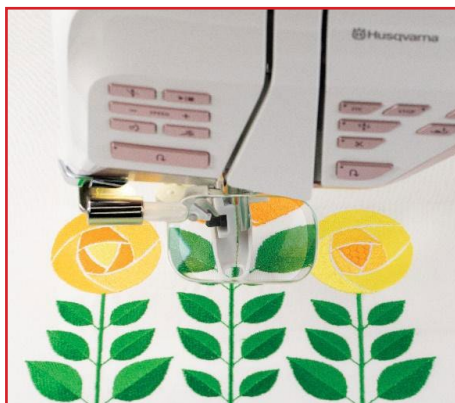

MAGNIFYING LENS SET

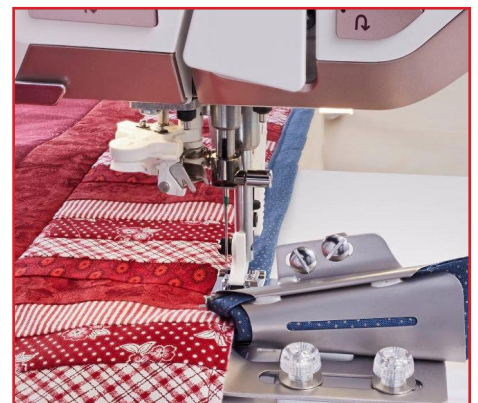

5/8" QUILT BINDER

YOU AND YOUR SEWING MACHINE

Welcome to the HUSQVARNA® VIKING® world of clever, creative accessories that will save you time and make your sewing and quilting easier and more professional. These tools will open the door to your own sewing studio with more possibilities than you could ever imagine! Most of the accessories have been developed out of the joyful creativity in our own sewing studio in Huskvarna, Sweden where ideas are born and improved. Visit our interactive sewing room at **www.husqvarnaviking.com**! where you will find hints and instructions for various sewing techniques from our own Sewing Stars. If you are looking to sew the perfect gift, garment or something for your home, there are plenty of ideas to download. Let us inspire you at **www.husqvarnaviking.com**!

This User's Guide groups HUSQVARNA® VIKING® accessories into sewing categories, plus there are accessory kits for special sewing categories. Be sure to experiment with your accessory feet for additional applications and visit the website for even more ideas. HUSQVARNA® VIKING® presser feet and accessories fit virtually all HUSQVARNA® VIKING® sewing machines. Look at page 5 to determine the machine group number for your HUSQVARNA® VIKING® sewing machine model. Look through the following pages for inspiration on how easy it is to develop your sewing skills and create exciting projects with accessories from HUSQVARNA® VIKING®.

TABLE OF CONTENT

HUSQVARNA® VIKING® Sewing and Embroidery Machines	4
Utility Garment Sewing	6
Home Dec Sewing	21
Decorative/Crafting Sewing	28
Heirloom Sewing	46
Quilting	56
Embroidery	76
Additional Accessories	90
Overlock Sewing and Embellishing	97
Overlock Sewing and Coverstitch	114
Luggage	124
Notions	126
Scissors	128
Needles	135



Designer Epic | 3

Husqvarna VIKING

Designer Epic | 3

Husqvarna VIKING

110 100 90 80 70 60 50 40 30 20 10 0 10 20 30 40 50 60 70 80 90 100 110 120 130 140 150 160 170 180 190 200 210 220 230 240 250 260 270 280 290 300 310 320 330 340 350 360 370 380 390 400 410 420 430 440 450 460 470 480 490 500 510 520 530 540 550 560 570 580 590 600 610 620 630 640 650 660 670 680 690 700 710 720 730 740 750 760 770 780 790 800 810 820 830 840 850 860 870 880 890 900 910 920 930 940 950 960 970 980 990 1000 1010 1020 1030 1040 1050 1060 1070 1080 1090 1100 1110 1120 1130 1140 1150 1160 1170 1180 1190 1200 1210 1220 1230 1240 1250 1260 1270 1280 1290 1300 1310 1320 1330 1340 1350 1360 1370 1380 1390 1400 1410 1420 1430 1440 1450 1460 1470 1480 1490 1500 1510 1520 1530 1540 1550 1560 1570 1580 1590 1600 1610 1620 1630 1640 1650 1660 1670 1680 1690 1700 1710 1720 1730 1740 1750 1760 1770 1780 1790 1800 1810 1820 1830 1840 1850 1860 1870 1880 1890 1900 1910 1920 1930 1940 1950 1960 1970 1980 1990 2000 2010 2020 2030 2040 2050 2060 2070 2080 2090 2100 2110 2120 2130 2140 2150 2160 2170 2180 2190 2200 2210 2220 2230 2240 2250 2260 2270 2280 2290 2300 2310 2320 2330 2340 2350 2360 2370 2380 2390 2400 2410 2420 2430 2440 2450 2460 2470 2480 2490 2500 2510 2520 2530 2540 2550 2560 2570 2580 2590 2600 2610 2620 2630 2640 2650 2660 2670 2680 2690 2700 2710 2720 2730 2740 2750 2760 2770 2780 2790 2800 2810 2820 2830 2840 2850 2860 2870 2880 2890 2900 2910 2920 2930 2940 2950 2960 2970 2980 2990 3000 3010 3020 3030 3040 3050 3060 3070 3080 3090 3100 3110 3120 3130 3140 3150 3160 3170 3180 3190 3200 3210 3220 3230 3240 3250 3260 3270 3280 3290 3300 3310 3320 3330 3340 3350 3360 3370 3380 3390 3400 3410 3420 3430 3440 3450 3460 3470 3480 3490 3500 3510 3520 3530 3540 3550 3560 3570 3580 3590 3600 3610 3620 3630 3640 3650 3660 3670 3680 3690 3700 3710 3720 3730 3740 3750 3760 3770 3780 3790 3800 3810 3820 3830 3840 3850 3860 3870 3880 3890 3900 3910 3920 3930 3940 3950 3960 3970 3980 3990 4000 4010 4020 4030 4040 4050 4060 4070 4080 4090 4100 4110 4120 4130 4140 4150 4160 4170 4180 4190 4200 4210 4220 4230 4240 4250 4260 4270 4280 4290 4300 4310 4320 4330 4340 4350 4360 4370 4380 4390 4400 4410 4420 4430 4440 4450 4460 4470 4480 4490 4500 4510 4520 4530 4540 4550 4560 4570 4580 4590 4600 4610 4620 4630 4640 4650 4660 4670 4680 4690 4700 4710 4720 4730 4740 4750 4760 4770 4780 4790 4800 4810 4820 4830 4840 4850 4860 4870 4880 4890 4900 4910 4920 4930 4940 4950 4960 4970 4980 4990 5000 5010 5020 5030 5040 5050 5060 5070 5080 5090 5100 5110 5120 5130 5140 5150 5160 5170 5180 5190 5200 5210 5220 5230 5240 5250 5260 5270 5280 5290 5300 5310 5320 5330 5340 5350 5360 5370 5380 5390 5400 5410 5420 5430 5440 5450 5460 5470 5480 5490 5500 5510 5520 5530 5540 5550 5560 5570 5580 5590 5600 5610 5620 5630 5640 5650 5660 5670 5680 5690 5700 5710 5720 5730 5740 5750 5760 5770 5780 5790 5800 5810 5820 5830 5840 5850 5860 5870 5880 5890 5900 5910 5920 5930 5940 5950 5960 5970 5980 5990 6000 6010 6020 6030 6040 6050 6060 6070 6080 6090 6100 6110 6120 6130 6140 6150 6160 6170 6180 6190 6200 6210 6220 6230 6240 6250 6260 6270 6280 6290 6300 6310 6320 6330 6340 6350 6360 6370 6380 6390 6400 6410 6420 6430 6440 6450 6460 6470 6480 6490 6500 6510 6520 6530 6540 6550 6560 6570 6580 6590 6600 6610 6620 6630 6640 6650 6660 6670 6680 6690 6700 6710 6720 6730 6740 6750 6760 6770 6780 6790 6800 6810 6820 6830 6840 6850 6860 6870 6880 6890 6900 6910 6920 6930 6940 6950 6960 6970 6980 6990 7000 7010 7020 7030 7040 7050 7060 7070 7080 7090 7100 7110 7120 7130 7140 7150 7160 7170 7180 7190 7200 7210 7220 7230 7240 7250 7260 7270 7280 7290 7300 7310 7320 7330 7340 7350 7360 7370 7380 7390 7400 7410 7420 7430 7440 7450 7460 7470 7480 7490 7500 7510 7520 7530 7540 7550 7560 7570 7580 7590 7600 7610 7620 7630 7640 7650 7660 7670 7680 7690 7700 7710 7720 7730 7740 7750 7760 7770 7780 7790 7800 7810 7820 7830 7840 7850 7860 7870 7880 7890 7900 7910 7920 7930 7940 7950 7960 7970 7980 7990 8000 8010 8020 8030 8040 8050 8060 8070 8080 8090 8100 8110 8120 8130 8140 8150 8160 8170 8180 8190 8200 8210 8220 8230 8240 8250 8260 8270 8280 8290 8300 8310 8320 8330 8340 8350 8360 8370 8380 8390 8400 8410 8420 8430 8440 8450 8460 8470 8480 8490 8500 8510 8520 8530 8540 8550 8560 8570 8580 8590 8600 8610 8620 8630 8640 8650 8660 8670 8680 8690 8700 8710 8720 8730 8740 8750 8760 8770 8780 8790 8800 8810 8820 8830 8840 8850 8860 8870 8880 8890 8900 8910 8920 8930 8940 8950 8960 8970 8980 8990 9000 9010 9020 9030 9040 9050 9060 9070 9080 9090 9100 9110 9120 9130 9140 9150 9160 9170 9180 9190 9200 9210 9220 9230 9240 9250 9260 9270 9280 9290 9300 9310 9320 9330 9340 9350 9360 9370 9380 9390 9400 9410 9420 9430 9440 9450 9460 9470 9480 9490 9500 9510 9520 9530 9540 9550 9560 9570 9580 9590 9600 9610 9620 9630 9640 9650 9660 9670 9680 9690 9700 9710 9720 9730 9740 9750 9760 9770 9780 9790 9800 9810 9820 9830 9840 9850 9860 9870 9880 9890 9900 9910 9920 9930 9940 9950 9960 9970 9980 9990 10000 10010 10020 10030 10040 10050 10060 10070 10080 10090 10100 10110 10120 10130 10140 10150 10160 10170 10180 10190 10200 10210 10220 10230 10240 10250 10260 10270 10280 10290 10300 10310 10320 10330 10340 10350 10360 10370 10380 10390 10400 10410 10420 10430 10440 10450 10460 10470 10480 10490 10500 10510 10520 10530 10540 10550 10560 10570 10580 10590 10600 10610 10620 10630 10640 10650 10660 10670 10680 10690 10700 10710 10720 10730 10740 10750 10760 10770 10780 10790 10800 10810 10820 10830 10840 10850 10860 10870 10880 10890 10900 10910 10920 10930 10940 10950 10960 10970 10980 10990 11000 11010 11020 11030 11040 11050 11060 11070 11080 11090 11100 11110 11120 11130 11140 11150 11160 11170 11180 11190 11200 11210 11220 11230 11240 11250 11260 11270 11280 11290 11300 11310 11320 11330 11340 11350 11360 11370 11380 11390 11400 11410 11420 11430 11440 11450 11460 11470 11480 11490 11500 11510 11520 11530 11540 11550 11560 11570 11580 11590 11600 11610 11620 11630 11640 11650 11660 11670 11680 11690 11700 11710 11720 11730 11740 11750 11760 11770 11780 11790 11800 11810 11820 11830 11840 11850 11860 11870 11880 11890 11900 11910 11920 11930 11940 11950 11960 11970 11980 11990 12000 12010 12020 12030 12040 12050 12060 12070 12080 12090 12100 12110 12120 12130 12140 12150 12160 12170 12180 12190 12200 12210 12220 12230 12240 12250 12260 12270 12280 12290 12300 12310 12320 12330 12340 12350 12360 12370 12380 12390 12400 12410 12420 12430 12440 12450 12460 12470 12480 12490 12500 12510 12520 12530 12540 12550 12560 12570 12580 12590 12600 12610 12620 12630 12640 12650 12660 12670 12680 12690 12700 12710 12720 12730 12740 12750 12760 12770 12780 12790 12800 12810 12820 12830 12840 12850 12860 12870 12880 12890 12900 12910 12920 12930 12940 12950 12960 12970 12980 12990 13000 13010 13020 13030 13040 13050 13060 13070 13080 13090 13100 13110 13120 13130 13140 13150 13160 13170 13180 13190 13200 13210 13220 13230 13240 13250 13260 13270 13280 13290 13300 13310 13320 13330 13340 13350 13360 13370 13380 13390 13400 13410 13420 13430 13440 13450 13460 13470 13480 13490 13500 13510 13520 13530 13540 13550 13560 13570 13580 13590 13600 13610 13620 13630 13640 13650 13660 13670 13680 13690 13700 13710 13720 13730 13740 13750 13760 13770 13780 13790 13800 13810 13820 13830 13840 13850 13860 13870 13880 13890 13900 13910 13920 13930 13940 13950 13960 13970 13980 13990 14000 14010 14020 14030 14040 14050 14060 14070 14080 14090 14100 14110 14120 14130 14140 14150 14160 14170 14180 14190 14200 14210 14220 14230 14240 14250 14260 14270 14280 14290 14300 14310 14320 14330 14340 14350 14360 14370 14380 14390 14400 14410 14420 14430 14440 14450 14460 14470 14480 14490 14500 14510 14520 14530 14540 14550 14560 14570 14580 14590 14600 14610 14620 14630 14640 14650 14660 14670 14680 14690 14700 14710 14720 14730 14740 14750 14760 14770 14780 14790 14800 14810 14820 14830 14840 14850 14860 14870 14880 14890 14900 14910 14920 14930 14940 14950 14960 14970 14980 14990 15000 15010 15020 15030 15040 15050 15060 15070 15080 15090 15100 15110 15120 15130 15140 15150 15160 15170 15180 15190 15200 15210 15220 15230 15240 15250 15260 15270 15280 15290 15300 15310 15320 15330 15340 15350 15360 15370 15380 15390 15400 15410 15420 15430 15440 15450 15460 15470 15480 15490 15500 15510 15520 15530 15540 15550 15560 15570 15580 15590 15600 15610 15620 15630 15640 15650 15660 15670 15680 15690 15700 15710 15720 15730 15740 15750 15760 15770 15780 15790 15800 15810 15820 15830 15840 15850 15860 15870 15880 15890 15900 15910 15920 15930 15940 15950 15960 15970 15980 15990 16000 16010 16020 16030 16040 16050 16060 16070 16080 16090 16100 16110 16120 16130 16140 16150 16160 16170 16180 16190 16200 16210 16220 16230 16240 16250 16260 16270 16280 16290 16300 16310 16320 16330 16340 16350 16360 16370 16380 16390 16400 16410 16420 16430 16440 16450 16460 16470 16480 16490 16500 16510 16520 16530 16540 16550 16560 16570 16580 16590 16600 16610 16620 16630 16640 16650 16660 16670 16680 16690 16700 16710 16720 16730 16740 16750 16760 16770 16780 16790 16800 16810 16820 16830 16840 16850 16860 16870 16880 16890 16900 16910 16920 16930 16940 16950 16960 16970 16980 16990 17000 17010 17020 17030 17040 17050 17060 17070 17080 17090 17100 17110 17120 17130 17140 17150 17160 17170 17180 17190 17200 17210 17220 17230 17240 17250 17260 17270 17280 17290 17300 17310 17320 17330 17340 17350 17360 17370 17380 17390 17400 17410 17420 17430 17440 17450 17460 17470 17480 17490 17500 17510 17520 17530 17540 17550 17560 17570 17580 17590 17600 17610 17620 17630 17640 17650 17660 17670 17680 17690 17700 17710 17720 17730 17740 17750 17760 17770 17780 17790 17800 17810 17820 17830 17840 17850 17860 17870 17880 17890 17900 17910 17920 17930 17940 17950 17960 17970 17980 17990 18000 18010 18020 18030 18040 18050 18060 18070 18080 18090 18100 18110 18120 18130 18140 18150 18160 18170 18180 18190 18200 18210 18220 18230 18240 18250 18260 18270 18280 18290 18300 18310 18320 18330 18340 18350 18360 18370 18380 18390 18400 18410 18420 18430 18440 18450 18460 18470 18480 18490 18500 18510 18520 18530 18540 18550 18560 18570 18580 18590 18600 18610 18620 18630 18640 18650 18660 18670 18680 18690 18700 18710 18720 18730 18740 18750 18760 18770 18780 18790 18800 18810 18820 18830 18840 18850 18860 18870 18880 18890 18900 18910 18920 18930 18940 18950 18960 18970 18980 18990 19000 19010 19020 19030 19040 19050 19060 19070 19080 19090 19100 19110 19120 19130 19140 19150 19160 19170 19180 19190 19200 19210 19220 19230 19240 19250 19260 19270 19280 19290 19300 19310 19320 19330 19340 19350 19360 19370 19380 19390 19400 19410 19420 19430 19440 19450 19460 19470 19480 19490 19500 19510 19520 19530 19540 19550 19560 19570 19580 19590 19600 19610 19620 19630 19640 19650 19660 19670 19680 19690 19700 19710 19720 19730 19740 19750 19760 19770 19780 19790 19800 19810 19820 19830 19840 19850 19860 19870 19880 19890 19900 19910 19920 19930 19940 19950 19960 19970 19980 19990 20000 20010 20020 20030 20040 20050 20060 20070 20080 20090 20100 20110 20120 20130 20140 20150 20160 20170 20180 20190 20200 20210 20220 20230 20240 20250 20260 20270 20280 20290 20300 20310 20320 20330 20340 20350 20360 20370 20380 20390 20400 20410 20420 20430 20440 20450 20460 20470 20480 20490 20500 20510 20520 20530 20540 20550 20560 20570 20580 20590 20600 20610 20620 20630 20640 20650 20660 20670 20680 20690 20700 20710 20720 20730 20740 20750 20760 20770 20780 20790 20800 20810 20820 20830 20840 20850 20860 20870 20880 20890 20900 20910 20920 20930 20940 20950 20960 20970 20980 20990 21000 21010 21020 21030 21040 21050 21060 21070 21080 21090 21100 21110 21120 21130 21140 21150 21160 21170 21180 21190 21200 21210 21220 21230 21240 21250 21260 21270 21280 21290 21300 21310 21320 21330 21340 21350 21360 21370 21380 21390 21400 21410 21420 21430 21440 21450 21460 21470 21480 21490 21500 21510 21520 21530 21540 21550 21560 21570 21580 21590 21600 21610 21620 21630 21640 21650 21660 21670 21680 21690 21700 21710 21720 21730 21740 21750 21760 21770 21780 21790 21800 21810 21820 21830



HUSQVARNA® VIKING®
SEWING AND EMBROIDERY
MACHINES

To determine which presser feet and accessories fit your model of HUSQVARNA® VIKING® sewing machine, identify your model from the illustrations on this page. The number in a square will identify each of the accessories that will fit your HUSQVARNA® VIKING® sewing machine. Step by step instructions teach you how to use each foot, plus project ideas are pictured for your inspiration. If your sewing machine model is not included below, visit our **website www.husqvarnaviking.com** for more information.

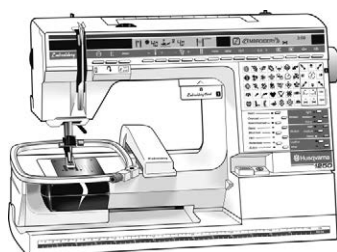

① ORCHIDEA™, I250, #I+, I200, I100, I090, I070, I070 S, I050.

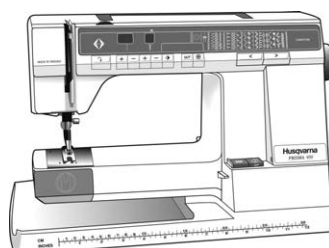

② 990 S, 990, 980, 960, 950 S, 950, 945, 940.

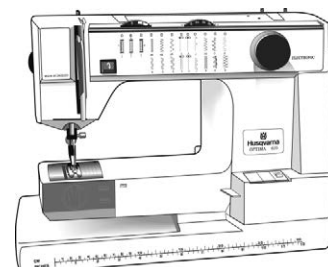

③ 630, 620, 610, 190, 185, 180, 150, 120.

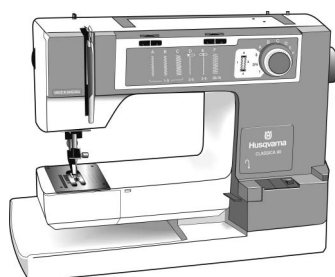

④ 105, 100, 95, 90.

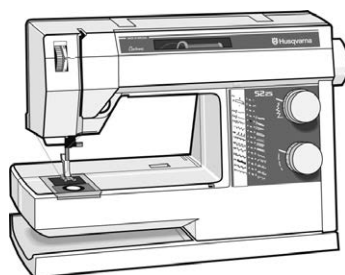

⑤ PRELUDE™ 360, PRELUDE™ 340, DAISY™ 335, 330, 325, 320, 315, 310, HUSQVARNA® VIKING® 250, 230, 225/215, 210, 205, SCANDINAVIA™ 100, ONYX™ 25, 15 EDEN ROSE™ 250M, TRIBUTE™ 140M, 145M, EMERALD™ 122, 118, 116.

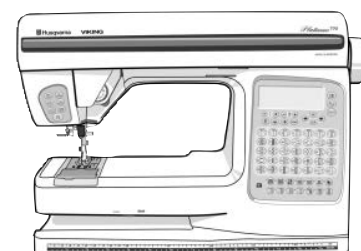

⑥ PLATINUM™ 955 E, 950 E, PLATINUM™ Plus 775, 770, 755 Quilt, 750 Quilt, 735, 730, 715, ROSE™ 605, 600, IRIS™, LILY™ 555, 550, 545, 540, 535, 530, HUSQVARNA® VIKING® 500, INTERLUDE™ 445, 435, FREESIA™ 425, 415, HUSQVARNA® VIKING® 400, 350, SCANDINAVIA™ 400, 300, 200, EMERALD™ 203, 183, DESIGNER JADE™ 35, JADE™ 20, OPAL™ 650, 670, TRIBUTE™ 145C, TRIBUTE™ 150C.

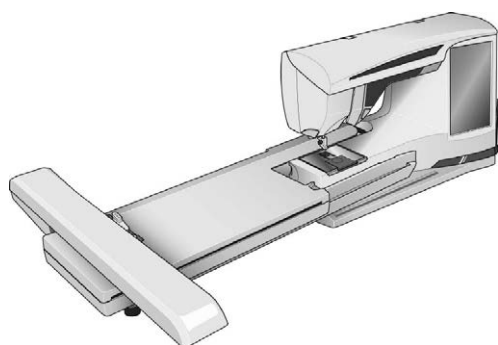

⑦ DESIGNER DIAMOND Royale™, DESIGNER DIAMOND deLuxe™, DESIGNER DIAMOND™, DESIGNER SAPPHIRE™85, DESIGNER RUBY Royale™, DESIGNER RUBY deLuxe™, DESIGNER RUBY™, DESIGNER TOPAZ™ 50, 40, 30, 25, 20, DESIGNER™ SE, DESIGNER™ SE Limited Edition, DESIGNER™ I, II, QUILT DESIGNER™, QUILT DESIGNER™ II, SAPPHIRE™ 965Q, 960Q, 930, 875Q, 870Q, 855, 850, 835, 830, DESIGNER BRILLANCE™ 80, BRILLANCE™ 75Q, OPAL™ 690Q, EDEN ROSE™ 250C, TRIBUTE™ 140C.

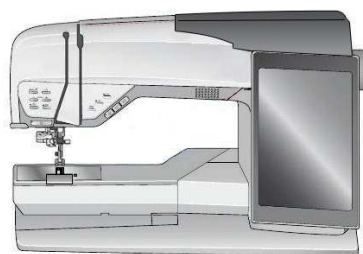

⑧ DESIGNER EPIC™, EPIC™ 980Q, DESIGNER RUBY™ 90.

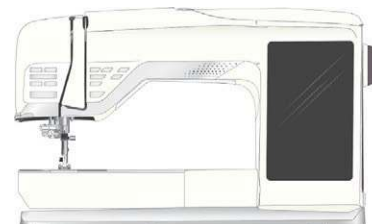

⑨ DESIGNER EPIC 2™, EPIC™ 95Q, DESIGNER EPIC™ 3



UTILITY GARMENT SEWING

HUSQVARNA® VIKING® accessories make fashion and garment sewing techniques such as seam finishing, buttonholes, hems, topstitching, zippers and more, easy to sew with professional results. Visit the Sewing Room at www.husqvarnaviking.com for more tips and techniques.



CLEAR SEAM GUIDE FOOT FOR IDF SYSTEM

413034845

① ② ③ ④ ⑤ ⑥ ⑦ ⑧

920614096

⑨

The Clear Seam Guide Foot guides your stitching perfectly when joining fabrics. The presser foot is designed to help you keep the seam allowance at the same distance from the edge throughout the project. The presser foot has a metal guide at 5/8 inch distance from the center needle position, which is the most used seam allowance when sewing clothes. It has four more markings for various seam allowances.

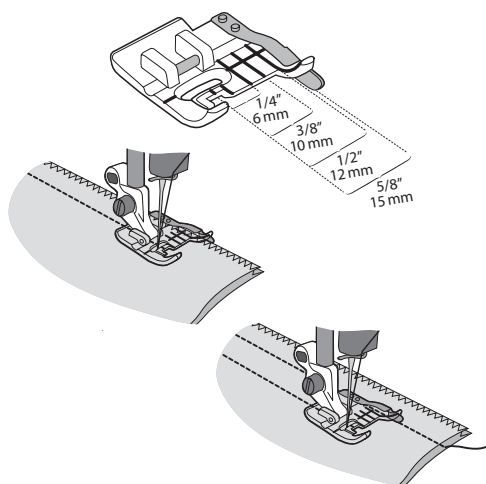

1. Snap on the Clear Seam Guide Foot
2. Engage the IDF system (920614096 only).
3. Select a straight stitch.
4. For joining fabrics together; place fabric right sides together.
5. Place the fabric under the presser foot with the metal guide at the edge of the fabric for 5/8 inch seam allowance.
6. Start to sew. The guide will follow the edge of the fabric and the seam will be sewn with the perfect straight seam allowance.
7. Use the 4 other red markings on the presser foot for a narrower seam allowances.



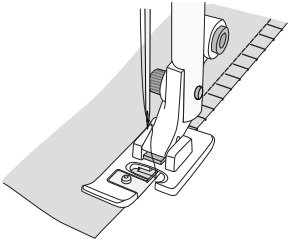

EDGING FOOT J

412380645

① ② ③ ④ ⑤ ⑥ ⑦ ⑧

68011495

⑨

The J Foot is used for overcast stitches that stitch to the side and can pucker or curl the fabric to prevent the fabric from curling under. The tiny wire on the edge of the foot prevents the curling of the fabric edge. Consult the HUSQVARNA® VIKING® machine display which recommends the J Foot for many overedge stitches.

1. Snap on the Edging Foot J.
2. Select an overcast or overedge stitch and turn the hand wheel by hand to be sure the needle does not hit the foot. Adjust stitch width as needed.
3. Sew.

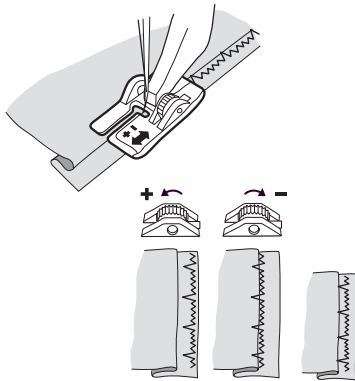

ADJUSTABLE BLIND HEM FOOT

412976645

① ② ③ ④ ⑤ ⑥ ⑦ ⑧

The Adjustable Blind Hem Foot can be moved from side to side to fine tune the amount of fabric caught by the blind hem stitch.

1. Snap on Adjustable Blind Hem Foot.
2. Fold and press hem as instructed for blind hem.
3. Place hem under foot and turn the orange dial on the blind hem foot to the right or left to adjust the foot from side to side until the wide zigzag stitch of the blind hem barely catches the fold of the fabric.





ROLLER FOOT

412990245

① ② ③ ④ ⑤ ⑥ ⑦ ⑧ ⑨

The Roller Foot sews fabrics with uneven levels, leathers, velvets, and fabric with nap or loops. Straight stitch, zigzag and other forward motion utility and decorative stitches.

1. Snap on Roller Foot.
2. Select stitch and sew.

The little wheels ride smoothly over a variety of fabric types.



NON-STICK GLIDE FOOT H

412796145

① ② ③ ④ ⑤ ⑥ ⑦ ⑧

68011500

⑨

When sewing foam, plastic, plastic coated fabrics, leather and imitation leathers, the Non-stick Glide Foot H feeds over the fabric without sticking. Use it for general sewing and buttonholes on plastic and leather type fabrics.

1. Snap on the Non-stick Glide Foot H.
2. Select desired stitch and sew.

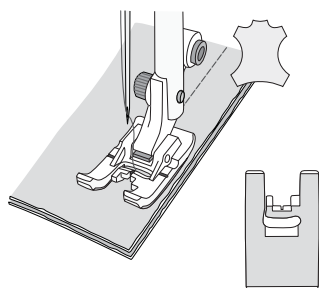



FLAT FELLED FOOT 9 MM

413185545

① ② ③ ④ ⑤ ⑥ ⑦ ⑧ ⑨

9 mm Flat-felled seams such as the typical jeans seams, are extremely durable and popular. 9 mm flat-felled seams are often used in home dec items. They add a decorative touch when sewn with a contrasting thread. Best results will be achieved on medium to heavy weight fabrics.

Method One:

1. Snap on the Flat-Felled Foot 9 mm Foot.
2. Place the wrong sides of the fabrics together and overlap the raw edges by using the red markings on the foot as a guide. The lower fabric should follow the marking on the right side of the foot and the upper fabric should follow the red marking on the right front side. (This will result in a double row of stitching on the right side of the garment. If you want a single row of stitching on the garment, stitch right sides of the fabric together.)
3. Stitch fabric together with a straight stitch
4. Press the seam allowance to the left
5. Use the guides on the front of the Flat-Felled Foot to fold the wider seam allowance around the narrower seam allowance. Stitch in place using a straight stitch.

Method Two:

If you have a seam allowance of 15 mm ($\frac{3}{8}$ ") included in your pattern, use the outer right markings on the Flat-Felled Foot as a guide for both layers. Cut off 6mm from the top seam allowance. Then continue with step 4.

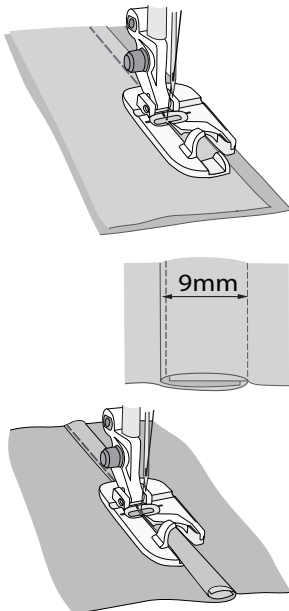



SENSOR ONE-STEP BUTTONHOLE FOOT 11 ◀

412815102

① ⑥ ⑦

Not for

415, 350, EMERALD™ series, EDEN ROSE™ 250M, TRIBUTE™ 140M, 145M. DESIGNER EPIC™ 3 JADE™ series

68007010

⑧

68020445

⑨

The Sensor One-Step Buttonhole Foot measures buttonhole length and sews the button size that has been entered into the machine. The middle mark gives a 9/16" (15 mm) buttoning edge. The Sensor one-step Buttonhole Foot measures as it sews, making every buttonhole the same size. The button size is adjusted in 2 mm steps.

1. Snap on the Sensor One-Step Buttonhole Foot. Plug the cord into the socket near the light on the machine. Line up the white range on the side of the wheel with the white marking line on the foot.
2. Set the button size on your HUSQVARNA® VIKING® sewing machine.
3. Lower the presser foot and sew. Line up the white range on the side of the wheel before you sew the next buttonhole to sew it in exactly the same size.
4. Use red lines on foot to sew every buttonhole the same distance from edge of project.



GATHERING FOOT

920571096

⑨

412797145

① ② ③ ④ ⑤ ⑥ ⑦ ⑧

Gather fabric or gather and attach a ruffle in one step. Suitable for light to medium weight fabrics. Straight stitch, (left needle position), length 3 to 6. The longer the length, the more fabric will gather. Snap on Gathering Foot.

For gathered fabric:

Place fabric under Gathering Foot and sew. Increase upper tension for tighter gathers.

To gather and attach gathered fabric in one step:

1. Place fabric to be gathered under the presser foot right side up.
2. Place fabric to have ruffle attached to it in the groove of the foot right side down.
3. Sew, guiding the under fabric but do not hold it back. Keep the top fabric in the groove moving it steadily as needed. Increase the stitch length, upper tension and presser foot pressure for more gathers.

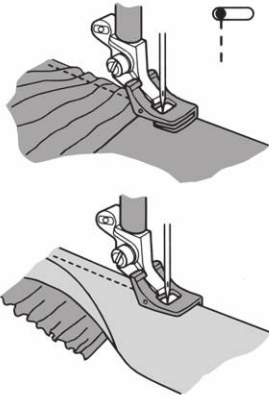

NARROW ZIPPER FOOT

412565745

① ② ③ ④ ⑤ ⑥ ⑦ ⑧ ⑨

Snap on the Narrow Zipper Foot to stitch extra close to zipper teeth, snaps, snap tape, beads, etc. This foot can be snapped on to the right or the left of the needle and the grooves on the underside grip specialty fabrics for excellent feeding. To sew a lapped zipper into a seam:

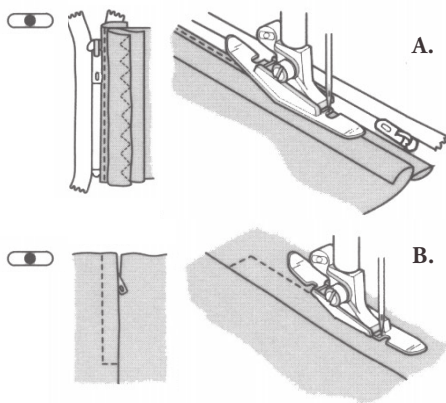

1. Baste the zipper seam.
2. Select center needle position straight stitch. Snap on the Narrow Zipper Foot to the left of the needle.
3. Form a narrow fold of the seam allowance on one side and place the zipper right side up under the folded edge. Start stitching from the bottom of the zipper, along the narrow edge and up to the fabric edge. Illustration A
4. Fold over the opposite fabric edge and seam allowance over the zipper.
5. Snap on Narrow Zipper Foot to the right of the needle. From the right side, stitch below the bottom of the zipper and up to the fabric edge. Illustration B
6. Remove the basted seam with a seam ripper.



INVISIBLE ZIPPER FOOT

920458096

--	--

① ② ③ ④ ⑤ ⑥ ⑦ ⑧ ⑨

An invisible zipper is always inserted before stitching the garment seam. The Invisible Zipper Foot has two grooves underneath the foot to accommodate the zipper coils and hold them in place as you stitch. Buy a zipper that is at least 1 ¼" (3 cm) longer than the zipper opening.

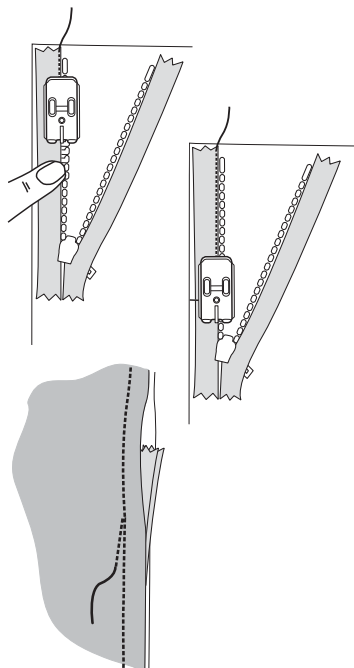

1. Mark the length of the zipper opening on the seam allowance and on the zipper. The excess length should be at the bottom of the zipper. Snap on the Invisible Zipper Foot. Select center needle position straight stitch. Length 2.5–3.0.
2. Unzip the zipper.
3. Place the right part of the zipper on the fabric right sides together. The coil should be on the seam line and the top stop of the zipper ¾" (2 cm) below the cut edge of the fabric.
4. Finger press up the zipper coils and lower the presser foot with the zipper coils in the right opening under the foot. Adjust needle position to align the needle with the needle guide on the front of the foot. Backstitch and sew. Stop at the mark on the zipper and seam allowance and backstitch to tie off.
5. Place the left part of the zipper right sides together with the left side of the garment. Lower the presser foot with the left opening over the zipper teeth. Make sure that the needle is perfectly aligned with the needle guide in front of the foot again. Sew in the same way as the first side.
6. Pull up the zipper pull. Place the fabric with the zipper right sides together. Snap on the regular Zipper Foot E to the left of the needle. Adjust needle position to the right. Pin the rest of the fabric below the zipper right sides together. Sew the seam from the lower edge and up to the zipper overlapping the backstitched seam. If the zipper is too long, whipstitch across the zipper teeth 1 ¼" (3 cm) below the inserted zipper length. Cut away excess zipper below the whipstitching.



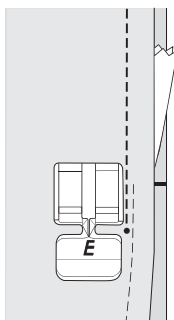
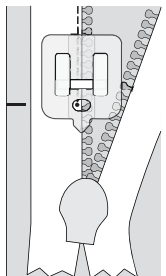
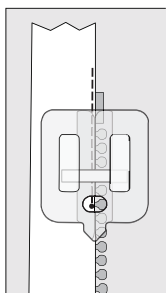

CLEAR INVISIBLE ZIPPER FOOT

413286545



① ② ③ ④ ⑤ ⑥ ⑦ ⑧ ⑨

Invisible Zippers (sometimes called concealed zippers) are most often seen in the center back of a dress, in the side or back of pants and skirts, and in some home dec projects. As the name implies, the zipper is hidden in a seam, becoming virtually invisible. This zipper application is often thought of as very difficult to do, however it's really one of the easiest, especially when sewn with the HUSQVARNA® VIKING® Clear Invisible Zipper Foot.

1. An invisible zipper is always inserted before stitching the garment seam.
2. Mark the length of the zipper opening on the seam allowances and on the zipper. The excess length should be at the bottom of the zipper.
3. Snap on the Clear Invisible Zipper Foot
4. Select center needle position straight stitch. Length 2.5-3.0.
5. Place the right part of the zipper on the right side of the seam, right sides together. The coil should be placed on the seam line, starting about $\frac{3}{4}$ " (2cm) below the cut edge of the fabric.
6. Carefully press the zipper teeth slightly to the right and lower the presser foot, so that the coil lies in the groove to the right of the needle.
7. Starting at the top, sew the zipper in place. Stop at the mark on the zipper and seam allowance and tie-off.
8. Place the second zipper tape on the left side of the opening, right sides together. Make sure both coils are level.
9. Pin the zipper in place. Open the zipper.
10. Lower the presser foot with the left groove over the zipper teeth. Sew in the same way as the first guide.
11. Close the zipper. Place the fabric with the zipper right sides together. Pin the rest of the fabric below the zipper right sides together.
12. Snap on the regular Zipper Foot E to the left of the needle. Adjust the needle position as needed.
13. Sew the seam from the lower edge and up to the zipper overlapping the backstitched seam.
14. Press the seam open

Note: Buy an invisible zipper that is at least 1 $\frac{1}{4}$ " (3cm) longer than the zipper opening.



BUTTON FOOT WITH PLACEMENT TOOL

412934545

① ② ③ ④ ⑤ ⑥ ⑦ ⑧ ⑨

Not for

EMERALD™ series, EDEN ROSE™ 250M, TRIBUTE™ 140M, 145M. ONYX™ series.

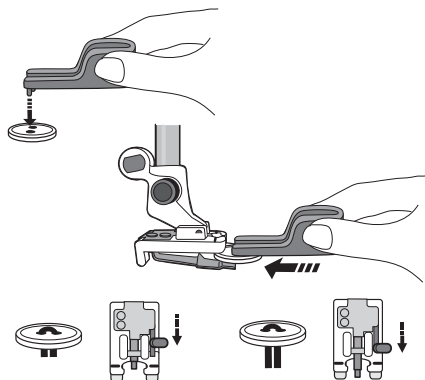

This presser foot for sewing on buttons raises the button slightly off the fabric to give a slight thread shank to enable easy buttoning, and prevent the button from being sewn too tightly to the fabric.

Press presser foot extra lift if available on your machine to make attaching the presser foot easier.

1. Thread with matching sewing thread on top and in the bobbin. Snap on the Button Foot.
2. Slide the Retractable Thread Shank Guide into the desired position. All the way back will give you no thread shank. The first position will give you a shorter shank for light weight fabrics. The second position (all the way forward) will give you a longer thread shank for heavier fabrics.
3. For a button smaller than 1/4" (6 mm), use the Placement Tool. Insert the Button Placement Tool into the holes of the button. Note: Avoid using a button higher than 1/8" (3 mm).
4. Insert the Button Placement Tool with the button in place into the slot in the foot. The button will automatically be placed in the correct position for sewing.
5. Remove the Button Placement Tool.
6. Select "Button Sewing" on your SEWING ADVISOR™ feature. Adjust the Stitch Width if necessary according to the width between the holes in the button.
7. Sew on your button following the instructions in your User's Guide.



LEFT EDGE TOPSTITCH FOOT

920569096

① ② ③ ④ ⑤ ⑥ ⑦ ⑧ ⑨

The Left Edge Topstitch Foot guides your top stitching and edge stitching perfectly. Use the inner right side of the presser foot to guide the fabric. Together with the underside of the foot which is designed to glide along the folded edge, you will get a beautiful top stitch on your project. Use the Left Edge Topstitch Foot for hemming bulky projects such as curtains, etc. It will allow you to have the bulk of the fabric to the left of the free arm for easier sewing.

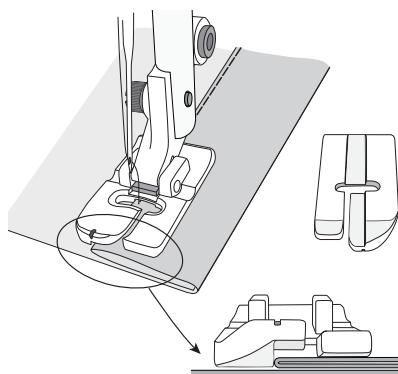



RUFFLER FOOT

920032096

⑤ ⑥ ⑦ ⑧ ⑨

Not for

EMERALD™ series, EDEN ROSE™ 250M, TRIBUTE™ 140M, 145M, ONYX™ series.

The Ruffler creates tiny pleats or gathers in light to medium weight fabrics.

Ruffler set up:

1. Remove the ankle/shank.
2. Replace the needle clamp screw with the longer screw included with the ruffler.
3. Place the Ruffler on the machine ankle/shank with the fork over the needle clamp screw. Secure the Ruffler on the ankle with the accessory thumb screw.
4. Set machine for straight stitch only.
5. Reduce presser foot pressure as needed.
6. The adjusting lever (J) sets how often the Ruffler will pleat. Set it at 1 for a pleat each stitch, 6 a pleat every 6th stitch, and 12 a pleat every 12th stitch. Set it to 0 for no pleats, the Ruffler action is disengaged for normal straight stitching.
7. The adjusting screw (I) sets how full the ruffles will be. Experiment stitching on scraps of the same fabric to be ruffled. Turn the screw to the right for more and the left for less fabric fullness in the ruffle.
8. Stitch length 2.5-3. Experiment with other length settings because the stitch length will also affect the fullness of the ruffle. The shorter the stitch the less distance between the pleats. Width must always be 0 for straight stitch.

Sew:

1. Place the fabric to be ruffled into the guide slots (G), then between the two black blades of the Ruffler (E & F) beyond the point of the needle.
2. Lower the presser foot and sew at an even medium speed.

Create ruffle and stitch to flat fabric at the same time:

1. Place the flat fabric right side up under ruffler.
2. Place the fabric to be ruffled right side down into the guide slot and blades as in step 1 above.
3. Sew. The flat fabric is moved by the feed teeth as the top fabric is ruffled and stitched to it.

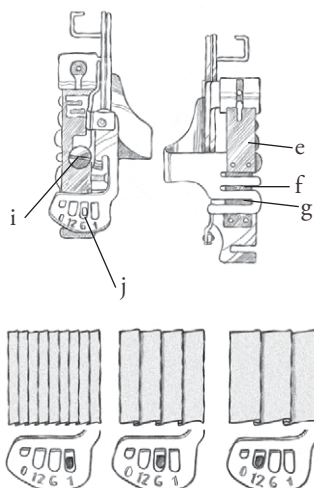

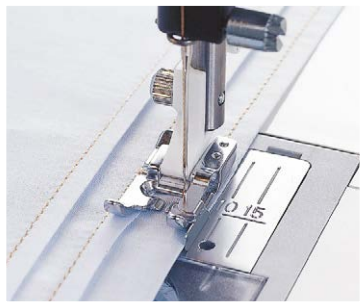

EDGE STITCHING FOOT

412796745

① ② ③ ④ ⑤ ⑥ ⑦ ⑧

920570096

⑨

The Edge Stitching Foot guides topstitching and edge stitching perfectly. Stitch folded tucks accurately.

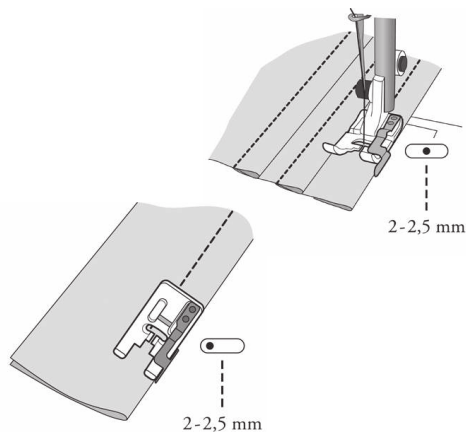

1. Snap on the Edge Stitching Foot.
2. Place project under foot with the flange guide at the edge of the project.
3. Select straight stitch (or desired stitch) and adjust needle position so the stitching row will be sewn at desired distance from edge. (Adjust the straight stitch needle positions from side to side with the width adjustment.)
4. For additional parallel rows of topstitching, adjust needle position and sew.

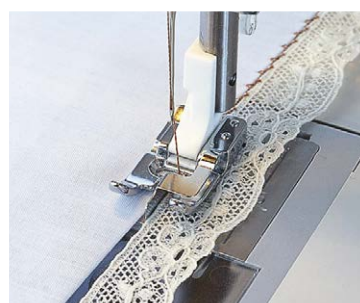

EDGE / JOINING FOOT

412796845

① ② ③ ④ ⑤ ⑥ ⑦ ⑧

920565096

⑨

Guides topstitching. Guides trims that are sewn to an edge or when two trims are sewn together. Edge/stitch: Straight stitch, left needle position, length 2-4.

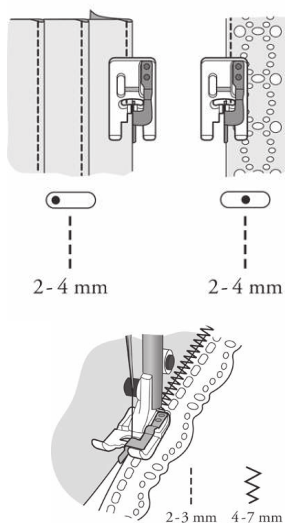

1. Snap on the Edge/Joining Foot.
2. Place edge of fabric against flange/guide. Sew. Topstitch: Straight stitch, center needle position, length 2-4.
3. Snap on Edge/Joining Foot.
4. Place flange/guide at line to topstitch. Sew. Joining: 3 step zigzag, or bridging stitch, length 2-3, width 4-7.
5. Place two pieces of fabric or trim, one on each side of the guide/flange of the foot.
6. Sew. Keep fabric/trim against the flange/guide to join them.

JOIN AND FOLD EDGING FOOT

413248845

① ② ③ ④ ⑤ ⑥ ⑦ ⑧ ⑨

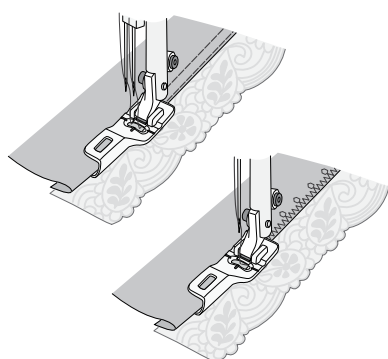

Use the Join and Fold Edging Foot together with different types of edging, such as lace, embroidered trims or various fabrics, along with the beautiful HUSQVARNA®VIKING® stitches to create beautiful edgings. Make lingerie in a snap, add lace to create beautiful handkerchiefs or delicate table toppers. This foot will easily guide the edging and the base fabric through the openings in the front of the foot, fold the base fabric and simultaneously sew the edging in place.

1. Thread your sewing machine with regular sewing or decorative thread through the needle and regular sewing thread in the bobbin.
2. Select the stitch you would like to use. For example: the edging could be sewn onto the base fabric using a straight stitch and a 4mm twin needle or a right justified wide decorative stitch. Note: Decorative stitches that use forward motion work best. (Avoid stitches with too much backward motion.)
3. Fold a ¼" (6mm) hem of base fabric to the wrong side, then finger press or iron.
4. Insert the folded edge of base fabric with the right side up into the left fabric guide, and the edging (right side up) into the right guide. Slide the folded fabric edge and the edging into the foot, prior to attaching the foot onto the sewing machine.
5. Make sure the base fabric and the edging slide easily through the openings.
6. Snap on the Join and Fold Edging Foot to the sewing machine.
7. Sew carefully, not too fast. If your machine has a speed control, reduce the sewing speed to easily guide the fabric and edging as you sew. Hold the fabric in your left hand and the edging in your right hand and sew.







HOME DEC
SEWING

- 22 Sewing for your home is a wonderful way to express yourself in fabric and fiber. HUSQVARNA® VIKING® has developed accessories to make sewing home decorating techniques and finishes such as welting and binding fast, easy and professional.



DOUBLE WELT CORD FOOT

412627145

① ② ③ ④ ⑤ ⑥ ⑦ ⑧ ⑨

Not for
ONYX™ series.

The Double Welt Cord Foot is used to make trim, to cover raw edges in place of braid or trim on your upholstery and home dec projects, or as a decorative touch on pillows, cushions and other home accessories. Create any color of trim when the color you need is not readily available.

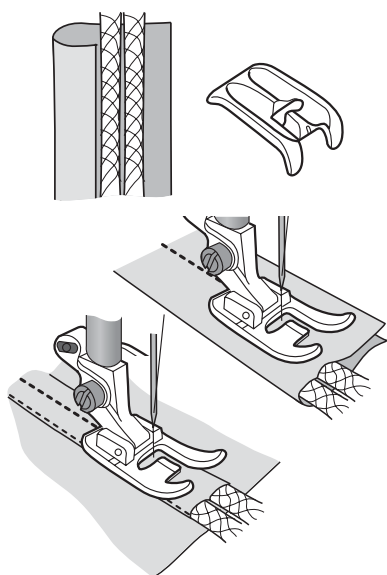

1. Purchase ¼" (6 mm) Cotton Filler Cord at least two times the length of the finished length of double welt trim.
2. Cut bias strip wide enough to wrap around two cords plus seam allowance.
3. Snap on the Double Welt Cord Foot. Select center needle straight stitch, stitch length 3.0. Place the cords side by side on the wrong side of the bias strip and wrap the fabric around the cords. Place the fabric and cords under the Double Welt Cord Foot with raw edges of the fabric to the right. Place the right cord in the left groove on the underside of the foot. Keep the cords against the fold as you sew.
4. Wrap the excess fabric to the underside and straight stitch between the cords through all layers. Trim the excess fabric on the wrong side near the stitching.
5. To sew the double welt cord trim to fabric, lay it in place on the project and straight stitch over the row of stitching in step 4.
6. For the edges of upholstery, use small upholstery finishing tacks or a staple gun to attach the double welt cord trim to cover raw edges.



SINGLE WELT CORD FOOT

412627045

① ② ③ ④ ⑤ ⑥ ⑦ ⑧ ⑨

Snap on the Single Welt Cord Foot to easily, quickly, accurately make and insert welted cording into your upholstered and home dec projects. Whether the welt cord is purchased pre-covered or you cover it yourself, this accessory foot gives you a professional finish. It sews like the piping foot but is designed for larger sizes of cording.

To cover welt cording:

1. Use ¼" (6 mm) Cotton Filler Cord. Cut strips of bias or cross grain fabric wide enough to cover the cord plus seam allowance.
2. Snap on the Single Welt Cord Foot. Select center needle straight stitch, stitch length 3.
3. Place the cording on the wrong side of the fabric strip and wrap the fabric strip around the cord.

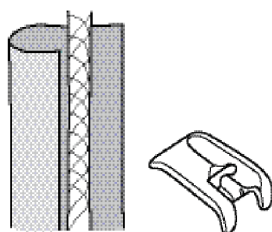

4. Place the fabric and cord under the Single Welt Cord Foot with the cording in the groove on the underside of the foot.
5. Sew to cover the cording with the fabric.

To stitch covered welt cord into a seam:

1. Snap on the Single Welt Cord Foot. Select center needle position straight stitch, stitch length 3.
2. Place the covered welt cord on the right side of the fabric along the seam line. Place it under the Single Welt Cord Foot with the welt cord in the groove of the foot. Stitch the welt cord to the fabric. Clip the seam allowance of the welt cord at curves and corners.
3. Place the second piece of fabric right sides together with the first. The welt cord will be between the two layers. Place the welt cord in the groove and stitch with the first stitching line up. Touch the width to adjust the needle position slightly to the right to cover the first stitching.



10 MM HEMMER

412990045



⑧ ⑨

BRILLIANCE™ series, DESIGNER DIAMOND™ series, DESIGNER RUBY™ series, DESIGNER TOPAZ™ series, SAPPHIRE™ series, OPAL™ series, DESIGNER JADE™ 35, JADE™ 20, DESIGNER SAPPHIRE™ 85, EDEN ROSE™ 250C, TRIBUTE™ 140C, 145C, 150C.

**Rolls a 10 mm double hem in light to medium weight fabrics.
Straight stitch, length 2.5. Snap on the A-foot.**

1. Snap 10 mm Hemmer onto needle plate of machine.
2. Place fabric into the scroll/guide of the 10 mm Hemmer, rolling it up to the needle.
3. Sew. Do not help the fabric roll. Simply guide it.

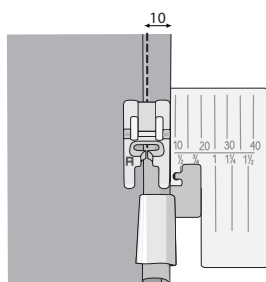



1/4" (6 MM) BIAS BINDER

412989545

① ② ③ ④ ⑤ ⑥ ⑦ ⑧ ⑨

To bind edges with 1/4" (6 mm) Bias Binding, cut a 1" (24 mm) wide bias strip of light weight fabric, or use packaged narrow double fold Bias Binding. Straight stitch, length 2.5, or zigzag or decorative stitch at desired length.

1. Snap on Bias Binder.
2. Cut the end of the bias tape to a point. Insert the bias tape from the outside of the funnel guide, into the slot and pull it down under the foot.
3. Place the edge to be bound into the groove on the left side of the funnel guide.
4. Adjust needle position as needed or to adjust the position of the binder funnel/guide, loosen the screw on the top of the foot and position the funnel guide as needed.

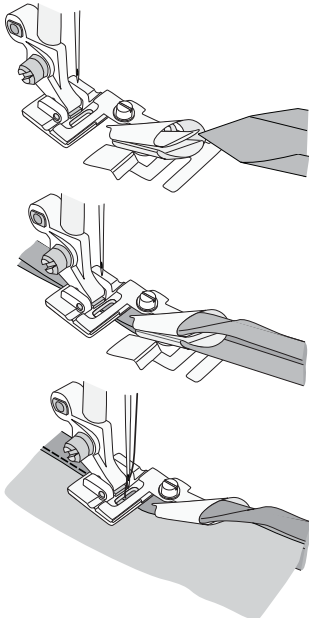

ADJUSTABLE BIAS BINDER

412985045

① ② ③ ④ ⑤ ⑥ ⑦ ⑧ ⑨

Make beautiful edge finishes with your favorite bias tape. Adjustable to fit bias tapes in different widths, from 1/4" (6 mm) to 3/4" (20 mm).

1. Thread with sewing thread on top and in the bobbin.
2. Snap on the Adjustable Bias Binder.
3. Use the screw on the right side of the bracket to adjust the width of the opening to fit the bias tape.
4. Cut the end of the bias tape to a 45 degree angle. Insert the bias tape from the outside of the bracket, into the slot that matches its width, and pull it down under the foot.
5. Place the edge to be bound into the groove on the left side of the bracket.
6. Loosen the screw on the top, in the back of the foot and adjust the bracket as needed.
7. Select a narrow zigzag, a straight stitch or a decorative stitch. Sew slowly, keeping the fabric to be bound, snugly in the groove as you sew.

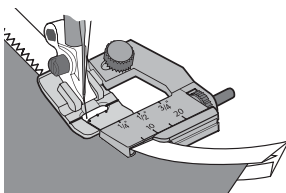
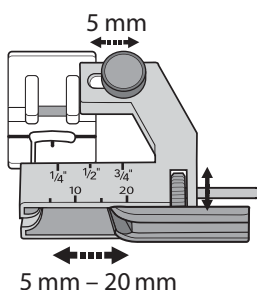

5 MM NARROW HEM FOOT

411851745

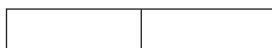

① ② ③ ④ ⑤ ⑥ ⑦ ⑧ ⑨

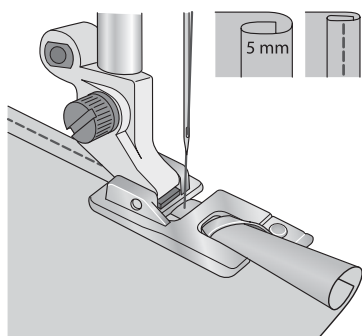

Stitch a Narrow Hem in medium weight fabrics. Suitable for napkin edges, curtains, ruffles. Straight stitch, length 2.5 to 3 (can be used with decorative stitches) Snap on foot. Stitch a Narrow Hem in very lightweight fabrics such as silk scarves, batiste napkins, shirt hems, ruffles and lingerie. Straight stitch, length 2.

1. Snap on Narrow Hem Foot.
2. Press a double hem (the width of the tunnel on the underside of the foot) in the first inch of the hem.
3. Place under the presser foot and stitch several stitches along the edge of the hem.
4. Stop with the needle in the fabric, raise the presser foot and pull the fabric edge up into the scroll/guide on the foot. Lower the presser foot, continue to sew. Do not help the fabric edge to roll, simply hold it vertically.





MEGA PIPING FOOT

413195145

① ② ③ ④ ⑤ ⑥ ⑦ ⑧ ⑨

The Mega Piping Foot is perfect for inserting thick home dec piping into seams and on edges for a tailored finish. The trim is sewn between the two layers of fabric in one step. You can also create your own piping for a custom finish. This foot can be snapped on to the right or the left of the needle which makes it possible to both create and sew the piping into the seam and to beautifully topstitch along the piping.

To make piping with your fabric:

1. Snap on the Mega Piping Foot to the right side of the needle.
2. Cut fabric into strips on the bias or crosswise grain. Cut fabric wide enough to cover the cording, including seam allowances.
3. Lay the cording on the wrong side of the fabric strip and wrap the fabric around the cord.
4. Place the fabric and the cord under the Mega Piping Foot with the cord to the left of the foot.
5. Select left needle position straight stitch. Sew.

Hint: When you sew this piping into a project, adjust the needle position so the second row of stitches is one needle position closer to the cord, to cover the first stitching.

To stitch piping into a seam:

1. Snap on the Mega Piping Foot to the right side of the needle.
2. Place the piping along the seam line on the right side of the fabric and stitch in place with the piping to the left of the foot.
3. Place the second piece of fabric on top with the right sides together.
4. Put fabric and piping layers under the Mega Piping Foot with the cord to the left of the foot.
5. Select left needle position straight stitch. Sew.

Hint: Notch the seam allowance of the piping on curves and corners to reduce bulk and make the seam lay flat.

Topstitching

Snap the Mega Piping Foot to the left side of the needle. Open the seam and fold so the piping is along the fabric edge.

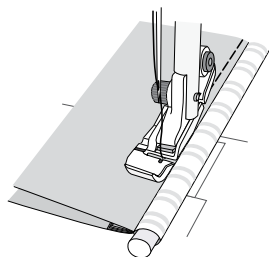
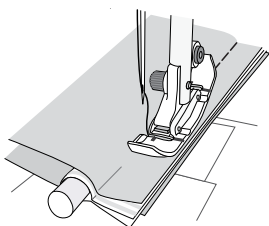
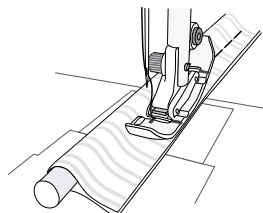

CLEAR PIPING FOOT

413097145

① ② ③ ④ ⑤ ⑥ ⑦ ⑧ ⑨

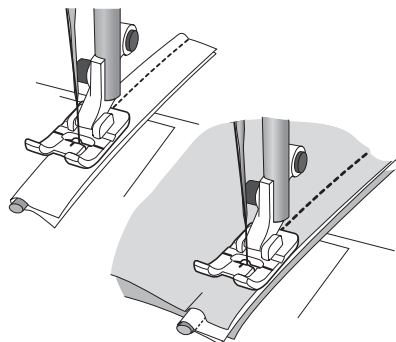

Insert packaged piping into seams and edges for a tailored finish. Cover cord with fabric for specialty piping. The clear view allows you to see the piping placement and see exactly where you are stitching. The clear view enables you to see the first row of stitching and adjust your needle position to stitch next to the original row. Straight Stitch, length 2.5.

1. To make piping from your fabric: Snap on the Clear Piping Foot.
2. Cut bias or crosswise grain strips wide enough to cover the cording plus seam allowances.
3. Lay the cording on the wrong side of the fabric strip and wrap the fabric over the cord.
4. Place the fabric and cord under the Clear Piping Foot with the cord in the groove on the underside of the foot.
5. Sew. The groove will guide the cord so the fabric covers it evenly. Hint: When you sew this piping into a garment, adjust the needle position so it stitches one setting closer to the cord, to cover the first stitching.

To stitch piping into a seam:

1. Snap on the Clear Piping Foot.
2. Place the piping along the seam line on the right side of the fabric and stitch in place with piping in the groove of the foot.
3. Place the second piece of fabric on top with the right sides together.
4. Put fabric and piping layers under the piping foot with the piping in the groove on the underside of the foot. Sew. The groove on the underside of the foot will guide the piping as you sew. (Hint: Notch the seam allowance of the piping on curves and corners.)





DECORATIVE/CRAFTING
SEWING



Express your creativity with embellishments, trims, beads, and “sew” much more. HUSQVARNA® VIKING® accessory feet make it easy. Add the beauty and texture of embellishment to any garment, gift or craft to make it your own.

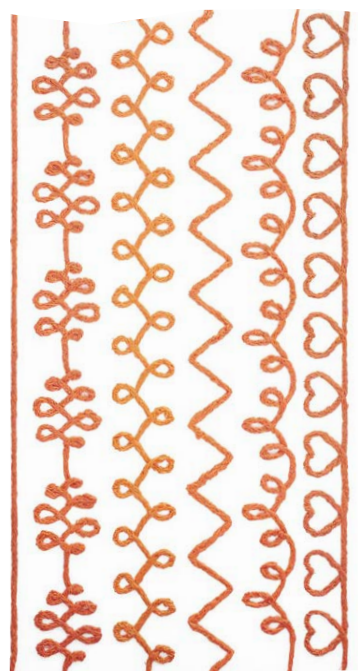

YARN EMBELLISHMENT FOOT SET

920403096

⑧*⑨*

DESIGNER DIAMOND™ series, DESIGNER RUBY™ series, DESIGNER™ SE, DESIGNER™ SE Limited Edition, SAPPHIRE™ 960Q, SAPPHIRE™ 965Q, DESIGNER BRILLIANCE™ 80, BRILLIANCE™ 75Q, DESIGNER SAPPHIRE™ 85.

With the HUSQVARNA® VIKING® Yarn Embellishment Foot Set, you can easily create decorative yarn embellishment when sewing. The embellishment is created when sewing using the specially designed stitches for this foot together with yarn. The effect of the embellishment can be changed dramatically by using the different types of yarn.

The presser foot is designed to be used with specially designed stitches. These stitches can be downloaded at www.husqvarnaviking.com.

Note: No stitches except for the specially designed stitches can be used.

The yarn foot is equipped with an adjustment wheel. The wheel is used to fine tune the red line so that it matches the center needle position on the foot.

When the needle is centered at the redline, it is more likely that the yarn foot will pick up a wider range of yarn.

Contents

- A. Yarn guides (for DESIGNER DIAMOND™ series, DESIGNER RUBY™ series, SAPPHIRE™ 960Q, except for DESIGNER™ SE)
- B. Yarn guides (for DESIGNER™ SE and DESIGNER™ SE Limited Edition).
- C. Yarn Foot
- D. Yarn threader
- Stitches to download

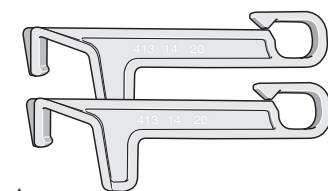

A.

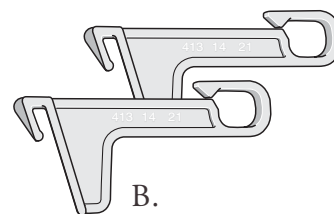

B.

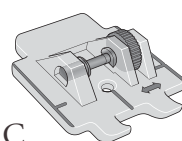

C.

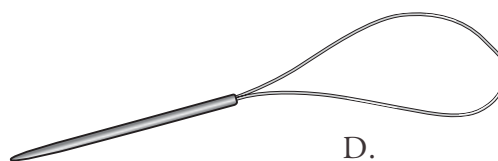

D.

*8 and 9 requires Yarn Guide Set 920453096

PREPARING THE MACHINE FOR COUCHING

1.

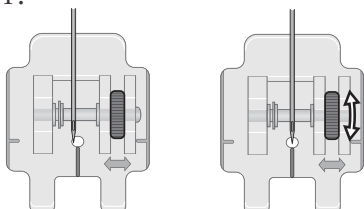

2.

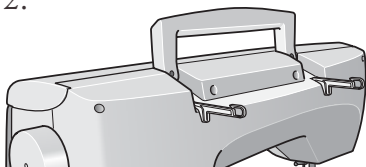

3.

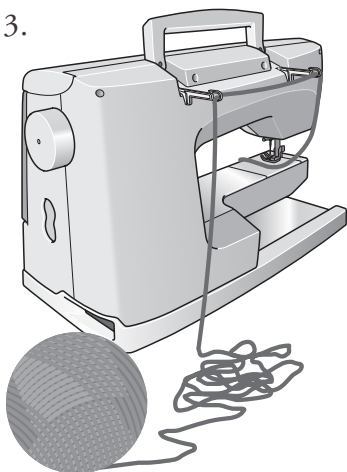

4.

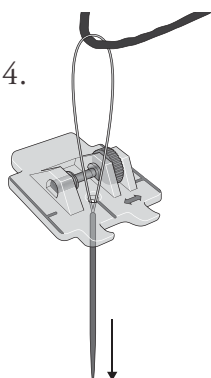

5.

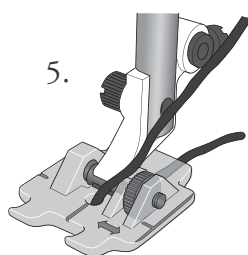

1. Thread the machine with a thread that matches the decorative yarn or use transparent thread.
2. Attach the yarn guides to your machine in the notches under the handle at the rear side of the machine (See ill. 2).
3. Pull out as much yarn as you need from the ball of yarn and place it as shown in ill. 3. Make sure to pull out the yarn continuously to avoid too much strain on the yarn.
4. Place the yarn in the yarn guides (See ill. 3). It is very important that the yarn runs smoothly while you are sewing.
5. Thread the yarn from above through the hole in the Yarn foot using the yarn threader (see ill. 4). We recommend using yarn with even thickness. For best result the yarn should fill the hole in the foot but still run easily through it.
6. Snap the foot onto the machine. (See ill. 5).
7. Select the stitch you want to sew. Before starting to sew, use the adjustment wheel to make sure the redline on the foot is matching the needle. (See ill. 1).

Tips: Draw a line on the fabric with a fabric marker, for easier guidance.

Note: Some yarn work better than other. Yarn with a looser structure will often give a better result.

Where to find the stitches for download

To download the stitches, go to www.husqvarnaviking.com.

Find the Yarn Embellishment Foot Set.

Click on the link to download the stitches.



YARN GUIDE SET

920453096



⑧ ⑨

These guides work with the Yarn Embellishment Foot Set 920403096 to create wonderful embellished designs when used with the specially designed yarn embellishment stitches found on your machine.

These guides are also used in conjunction with the Yarn Couching Feet Set 920215096. You can create decorative yarn embellishment both free hand and with embroidery.



CIRCULAR ATTACHMENT

920344096

⑧ ⑨

DESIGNER DIAMOND™ series, DESIGNER RUBY™ series, DESIGNER TOPAZ™ series, SAPPHIRE™ series, OPAL™ series, EDEN ROSE™ 250C, BRILLIANCE™ series, TRIBUTE™ 140C, 145C, 150C, DESIGNER JADE™ 35, 20, DESIGNER SAPPHIRE™ 85, ONYX™ series.

Your Circular Attachment is the perfect tool when you want to make unique embellishments on your sewing projects, garments and quilts. You can sew simple circles, flowers, or parts of circles to create unique borders or graphic patterns. Combine circles in different sizes and create large patterns. Almost all utility or decorative stitches* can be used when stitching with this attachment so you are free to use your favorite. The possibilities available with the Circular Attachment are as unending as the circles it creates!

** Stitches with a default stitch width wider than 7 mm, and stitches with backward feeding cannot be used. For group 9 disengage the IDF and use with stitches no wider than 9mm.*

In the package you will find:

- A. Circular Attachment with Size Guide
- B. Pivot Pin
- C. Three different templates: one for sewing circles (1), one for a four-petal flower (2) and one for a six-petal flower (3). The numbers on the templates correspond to the diameter of the circle (in cm)
- D. CD with User Instructions in 11 languages, a tutorial and ideas on how to combine circles using the templates

With the Circular Attachment, you can sew circles with a diameter measuring from 6 cm up to 26 cm (2½" to 10¼"). The diameters of the circles are printed in both centimeters and inches.

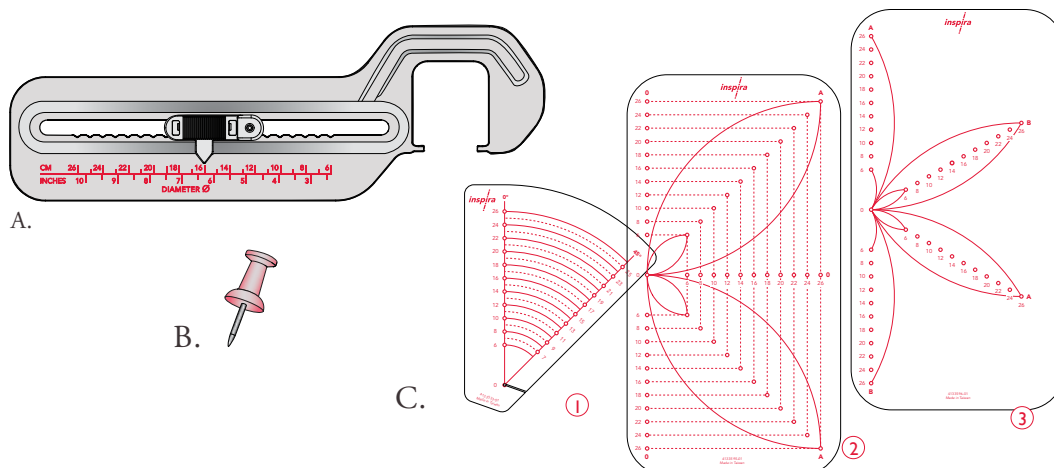

TIPS AND HINTS

Extension/Quilter's Table

When using the Circular Attachment, we recommend using an extension/quilter's table. This will give extra support to the fabric and makes it easier to control and guide the fabric. Extension/Quilter's tables are available as extra accessories.

Stitch Selection

Utility and decorative stitches give wonderful results with this attachment, however, stitches with a default stitch width wider than 7 mm, and stitches with backward feeding cannot be used.

Tip: The shorter the stitch, the easier it is to get a nicely joined circle. When about to close the circle, slow down the sewing speed and if necessary, adjust the stitch length to fill the gap.

Appliqués

You can make appliqués with the circular attachment. Use fabric that does not fray or make raw edge appliqués. You can also simply stitch your appliqué in place with a straight stitch, cut away the excess fabric, and finish by sewing a satin stitch over the raw edges. When using several layers of fabric, it is even more important to guide the fabric carefully making sure that all the layers feed together equally.



CIRCULAR ATTACHMENT TEMPLATE SET

920727096

For

920344096 and 920392096

Expand the design possibilities of the circular attachment even further with the circular attachment template set. Create large hearts, tulips and leaves easily with the 3 included templates.

- Create tulips, leaves and hearts in several different sizes.
- Stitch large scale appliqués or designs using built in stitches.
- All three templates have clear markings and easy to follow instructions are included.

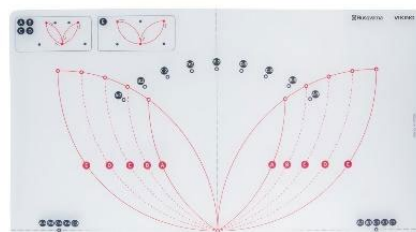
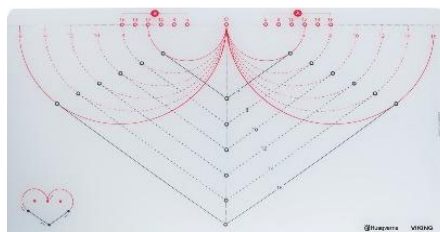
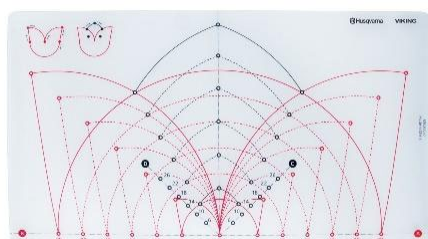



GIMPING FOOT

412580545

① ② ③ ④ ⑤ ⑥ ⑦ ⑧ ⑨

Not for

EMERALD™ 122, 118 and 116 machines,
EDEN ROSE™ 250M, TRIBUTE™ 140M, 145M.

Use the Gimping Foot to create a dimensional satin stitch technique. Gimp thread is guided by the foot as the stitch is sewn over it.

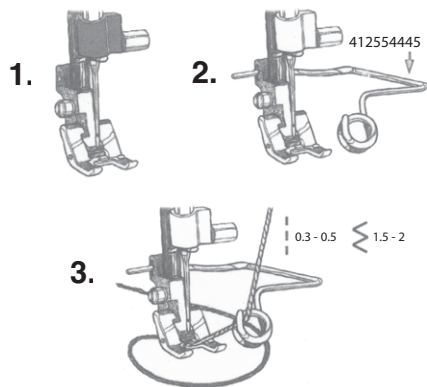

1. Thread a 40 weight rayon thread on top, embroidery bobbin thread in the bobbin.
2. Insert the gimp thread into the guide on the foot. Place the spool or length of gimp thread so it will feed smoothly into the foot as you sew.
3. Select a narrow satin stitch. (Follow the instructions for appliqué with the width just wide enough for the zigzag to stitch over the gimp.) On computer machines, select the preprogrammed satin stitch and fine tune the length and width to sew over the gimp. On other machines; select a zigzag stitch, length 0.3–0.5, width 1.5–2.
4. Mark a design onto your fabric and sew over it. The design will be outlined in dimensional satin stitch.

Note: Gimping/Braiding Guide (412554445) sold separately. (see next page)



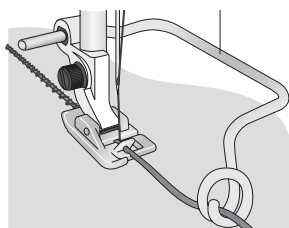
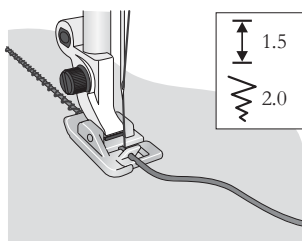
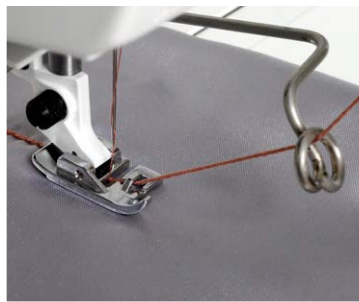

NARROW BRAID/CORD FOOT

411850945

① ② ③ ④ ⑤ ⑥ ⑦ ⑧ ⑨

Not for

EMERALD™ 122, 118 and 116 machines,
EDEN ROSE™ 250M, TRIBUTE™ 140M, 145M.

Couch or stitch yarn and narrow braids and trims to embellish garments, gifts, and crafts. Zigzag stitch, length 1.5, width as wide as the trim or yarn. Snap on Narrow Braid Foot.

1. Place the yarn or trim into the hook/guide on the front of the foot and under the foot.
2. Stitch the braid in place. The Gimping/Braiding guide accessory (412554445) will guide the yarn or trim as you sew. Use stabilizer as needed.

GIMPING/BRAIDING GUIDE

412554445

① ② ③ ④ ⑤ ⑥ ⑦ ⑧ ⑨

Not for

EMERALD™ 122, 118 and 116 machines,
EDEN ROSE™ 250M, TRIBUTE™ 140M, 145M, DESIGNER
EPIC™ 3.

Guides trims, braids, and cords into the Braiding Foot, Narrow Braiding Foot or Gimping Foot.

1. Place straight end of the Gimping/ Braiding Guide into the slot at the top of the presser foot ankle. Tighten the guide screw to hold it in place (on some models).
2. Thread the braid, cord or trim into the curly-Q end of the guide and into the foot.
3. Support the braid, cord or trim as it enters the guide as you sew.





MINI PIPING FOOT

413183045

① ② ③ ④ ⑤ ⑥ ⑦ ⑧ ⑨

Insert package piping into seams and edges for a tailored finish. Cover cord with fabric for specialty piping. The clear view allows you to see the piping placement and see exactly where you are stitching and enables you to see the first row of stitching and adjust your needle position to stitch next to the original row. Straight stitch, length 2.5.

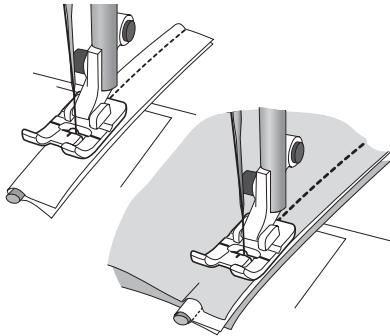

To make piping from your fabric:

1. Snap on the Mini Piping Foot
2. Cut bias or crosswise grain strips wide enough to cover the cording plus seam allowances.
3. Lay the cording on the wrong side of the fabric strip and wrap the fabric over the cord.
4. Place the fabric and the cord under the Mini Piping Foot with the cord in the groove on the underside of the foot.
5. Sew. The groove will guide the cord so the fabric covers it evenly.

Hint: When you sew this piping into a garment or other project, adjust the needle position so it stitches one position closer to the cord, to cover the first stitching.

To stitch piping into a seam:

6. Snap on the Mini Piping Foot
7. Place the piping along the seam line of the right side of the fabric and stitch in place with the piping in the groove of the foot.
8. Place the second piece of fabric on top with the right sides together.
9. Put fabric and piping layers under the Mini Piping Foot with the piping in the groove on the underside of the foot. Sew. The groove on the underside of the foot will guide the piping as you sew.

Hint: Notch the seam allowance of the piping on curves and corners.





BRAIDING FOOT

412989845

① ② ③ ④ ⑤ ⑥ ⑦ ⑧ ⑨

Couch or stitch braid or cord for decorative embellishment. Stabilize as needed. Straight stitch, length 2.5 or Zigzag stitch, length 2 to 4, width wide enough to go over braid or cord (or use decorative stitch).

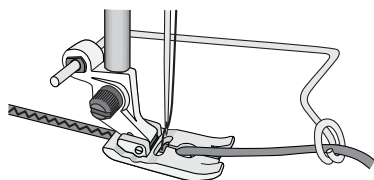

1. Thread braid from top of foot into the guide hole and under the foot.
2. Lower the Presser Foot and stitch. The Gimping /Braiding Guide accessory (412554445) will guide the braid as you sew.



YARN COUCHING FEET SET

920215096

--	--

⑦ ⑧* ⑨*

With HUSQVARNA® VIKING® Yarn Couching Feet Set you can easily create decorative yarn embellishment both when sewing free-motion and embroidering. Two different feet will suit a variety of yarn. A detailed instruction is included with the product.

1. Thread the machine with thread that matches the yarn.
2. Attach the proper yarn guides for your machine to the notches under the handle on the rear side of the machine.
3. Pull out as much yarn as you need from the ball of yarn.
4. Place the yarn in the yarn guides. It is very important that the yarn flows smoothly while you are sewing.
5. Choose Yarn Couching Foot 1 or 2, depending on the size of the yarn. For best result the yarn should fill the hole in the foot and still run easily through it. We recommend using yarn with even thickness.
6. Thread the yarn from above through the hole in the foot using the yarn threader.
7. Snap on the foot to the machine.

* 8 and 9 must use Yarn Guide Set 920453096

MULTI-LINE DECORATIVE FOOT

920616096

⑤ ⑥ ⑦ ⑧ ⑨

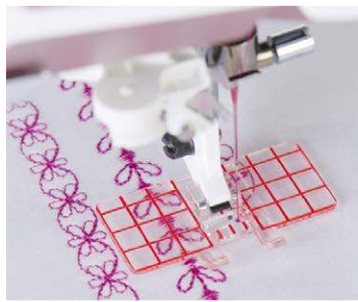

Use the Multi-line decorative Foot to create evenly spaced borders with decorative stitches or as a guide when sewing Omnimotion and side-motion stitches. Guidelines are provided for accurately turning corners of 1/4" (6mm) and 1/2" (12mm) measurements.

Decorative Borders

1. Thread your machine with sewing thread or decorative thread on top and sewing thread in the bobbin.
2. Choose a decorative stitch.
3. Snap on the Multi-line Decorative Foot.
4. Mark a line on the fabric with a water soluble pen where the center of the stitching will be.
5. Place Tear-Away Stabilizer under the fabric.
6. Line up the presser foot on the marked line using the red center line on the foot. Sew the first row of your decorative stitching.
7. Choose another decorative stitch.
8. Move your fabric to the left. Decide what distance you'd like to have between the rows.
9. Use the horizontal red lines to match up the start of each row.
10. Sew the next line of stitching using the red lines on the foot as a guide while sewing.
11. Mirror image the stitch and move your fabric to the right side of the center stitch. Sew the seam on the right side. Illustration 1
12. Continue with more stitches to create a wider border.
13. Tear away the stabilizer.

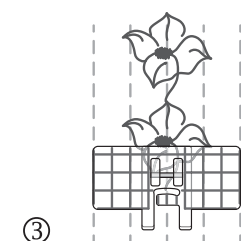
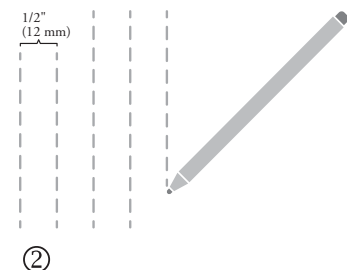
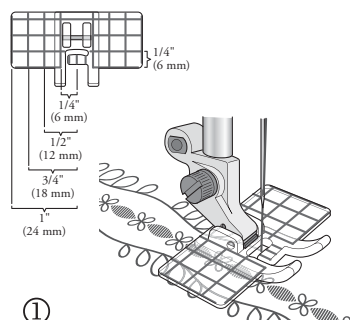

Omnimotion or side-motion stitches

1. Thread your machine with sewing thread or decorative thread on top and sewing thread in the bobbin.
2. Choose an Omnimotion or side-motion stitch.
3. Snap on the Multi-line Decorative Foot.
4. To ensure a straight line of stitching draw a line on the fabric with your water soluble where the center of the stitching will be. Continue to mark one or two lines on each side of the drawn line. Illustration 2
5. Place the fabric with Tear-Away Stabilizer under the presser foot.
6. Sew carefully and let the machine control the feeding.
7. Keep the marked lines and the vertical red lines on both sides of the presser foot parallel to each other when sewing. Illustration 3
8. Tear away the stabilizer.

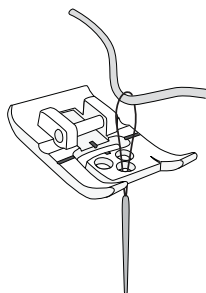

THREE HOLE YARN FOOT

413187045

① ② ③ ④ ⑤ ⑥ ⑦ ⑧

920615096

⑨

Embellish your project with different types of decorative cords or yarn using beautiful HUSQVARNA® VIKING® decorative stitches and the Three Hole Yarn Foot. This foot will easily guide the cords or yarn through the openings in the front of the foot back through the groove under the presser foot. The decorative cords or yarn will be stitched over creating a beautiful braid embellishment.

1. Thread your machine with a regular sewing thread or decorative thread on top and regular sewing thread in the bobbin.

2. Select a 7/9 mm (depending on machine) decorative stitch.

Note: Decorative stitches that use forward motion work best (avoid stitches with too much backward motion).

3. Thread decorative cords or yarn into the holes from the top of the foot, using the Yarn Threader, prior to attaching the foot onto the sewing machine.

4. Make sure the cords or yarn slide easily through the openings. (If the yarn is too thick it will create too much tension and the feeding might be affected.)

5. Snap on the Three Hole Yarn Foot.

6. Engage IDF system (920615096 only).

7. Place the threaded cords or yarn under the presser foot with a 5 cm (2") tail.

8. Place a tear away stabilizer underneath the fabric and place your fabric under the presser foot.

9. Sew carefully, not too fast. If your machine has a speed control reduce the sewing speed to easily guide the fabric and yarn as you sew.



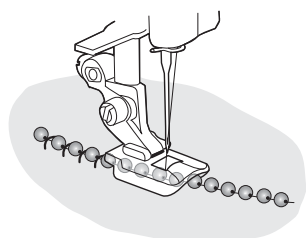



MINI BEAD FOOT 4 MM

412701145





① ② ③ ④ ⑤ ⑥ ⑦ ⑧ ⑨

Not for

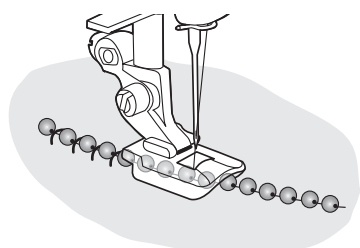
EMERALD™ series, EDEN ROSE™ 250M, TRIBUTE™ 140M, 145M, ONYX™ series.

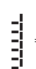
1. Snap on the Mini Bead Foot.
2. Thread with Polyester invisible thread on top and sewing thread in a color matching the fabric in the bobbin.
3. Select one of following stitches depending on which one is available on your HUSQVARNA® VIKING® Sewing machine:
 -  • Heirloom Appliqué stitch, length 4.0, stitch width 4.0,
 -  • Overcast stitch, length 9.0, width 5.0.
 -  • Overcast stitch, length 5.0, width 4.0.
4. Place 4 mm string pearls under the foot, laying them in the groove on the underside of the Mini Bead Foot. Place stabilizer under the fabric. Lower the presser foot. Turn the handwheel to make some stitches by hand carefully. Stitch pearls to a scrap of fabric first to test thread tension, presser foot pressure, stitch length and width according to the beads. Make adjustments if needed. Stitch slowly. (With some stitches it may be necessary to adjust stitch length while sewing, or program a stitch for the best result.)



 = 4,5 mm
  = 3,0 mm
  = 4,0 mm
  = 3,0 mm

CLEAR 2-3 MM EMBELLISHMENT FOOT

413030445

① ② ③ ④ ⑤ ⑥ ⑦ ⑧ ⑨

Not for

EMERALD™ 122, 118 and 116 machines, EDEN ROSE™ 250M, TRIBUTE™ 140M, 145M.

Embellish your work with small pearls.

1. Thread the machine with polyester invisible thread on top and regular sewing thread in the bobbin.
2. Snap on the Clear 2-3 mm Embellishment Foot.
3. Select one of the following stitches depending on which is available on your HUSQVARNA® VIKING® sewing machine.
 - Zigzag stitch length 4.0 mm, width 3.0 mm
 - Heirloom appliqué stitch length 4.5 mm, width 3.0 mm
4. Place the 2-3 mm string of pearls under the foot laying them in the groove on the underside of the Clear 2-3 mm Embellishment foot.
5. Stitch pearls to a piece of scrap fabric first to test the thread tension. If needed lower the thread tension.
6. Embellish your project with the pearls. Stitch slowly. (With some stitches it might be necessary to adjust stitch length while sewing)



FANCY TRIM FOOT

412823845

--	--

① ② ③ ④ ⑤ ⑥ ⑦ ⑧ ⑨

Not for

EMERALD™ 122, 118 and 116 machines, EDEN ROSE™ 250M, TRIBUTE™ 140M, 145M, ONYX™ series

Decorate your project with glittery sequins by using the Fancy Trim Foot. This foot will easily guide the sequins through a groove at the front of the foot, while your sewing machine stitches your fancy trim in place invisible. Only circle round sequins can be used.

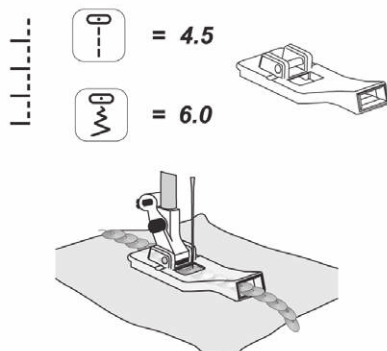

1. Thread with invisible thread on top and regular sewing thread in the bobbin. Snap on the Fancy Trim Foot and select a Hand Look Appliqué Stitch. Adjust the stitch length to 4.5 and the width according to the width of your sequins. Make sure to use Tear-Away stabilizer underneath your fabric.
2. Slide the sequins into the groove at the front of the presser foot. Make sure you have pulled a piece of the sequin trim under the foot and through to the back of the foot before you start to sew. Snap on the foot.
3. Start sewing on a scrap of your fabric, since different fabrics behave in different ways. Sew slowly to prevent sewing through the sequins.

SPECIALTY BOBBIN CASE

920211096

⑤ ⑥ ⑦

Not for

EMERALD™ series, EDEN ROSE™ 250M, TRIBUTE™ 140M, 145M, ONYX™ series.

920452096

⑧ ⑨

Create beautiful bobbin work, also called reversed decorative stitch embroidery with the HUSQVARNA® VIKING® Specialty Bobbin Case.

1. Lower the feed teeth, remove the stitch plate and replace the standard bobbin case with the Specialty Bobbin Case. Slide stitch plate back in place and raise feed teeth.
2. Depending on what type of decorative thread you are using for your projects there are different ways of working with the Specialty Bobbin Case.

For heavy or specialty threads:

Wind the bobbin with the decorative thread slowly – HUSQVARNA® VIKING® logo facing out. Place the bobbin in the Specialty Bobbin Case with the HUSQVARNA® VIKING® logo facing up. For less texture use thinner specialty threads, and adjust the bobbin tension screw if needed so the thread pulls evenly. Place bobbin and pull specialty thread into the bobbin tension.

For heavier yarns and textured specialty threads:

Wind the bobbin evenly clockwise by hand. Bypass bobbin tension. For the most textured bobbin work, do not pull the heavy thread or yarn into the bobbin tension or the thread cutter, but go directly into the bypass slot. Place the bobbin in the Specialty Bobbin Case. To bring up the bobbin thread hold the top thread, and turn the hand wheel towards you.

3. For both techniques thread the top with regular sewing thread. Use the recommended size needle for your fabric. Snap on B- or S foot.
4. Place the right side of the fabric facing down and place Tear Away Stabilizer on top. Select stitches where the density is less tight. Play around with the straight stitch, zigzag and other decorative stitches. Lengthen the stitches for best result. Select slow speed and stitch at an even speed for best results. Increase top tension slightly if needed. Before sewing on your project, try on a scrap of fabric until your adjustments are set. Hint: The heavier the thread, the longer the stitch length. Choose a stitch that does not stitch forward and back over itself.





RIBBON FEET SET

920239096

--	--

① ② ③ ④ ⑤ ⑥ ⑦ ⑧ ⑨

With HUSQVARNA® VIKING® Ribbon Feet Set you can easily create decorative ribbon embellishment. Three different feet will accomodate a variety of ribbons (from 6-13.5 mm).

Sewing using the ribbon feet

1. Use iron-on-stabilizer or tear-away-stabilizer to stabilize the fabric when sewing. Depending on the thickness of the fabric, more or less stablizer may be needed. Always test on a scrap piece of the fabric you are using.
2. Thread the machine with thread that matches your ribbon.
3. Select straight stitch (other stitches might damage the presser feet and/or cause the needle to break).
4. Choose Ribbon Foot 1, 2, or 3 depending on the width of your ribbon. For best result, the ribbon should fill the slot in the foot and still run easily through it. We recommend using ribbons with even an thickness.
5. Thread the ribbon from the front through the slot in the foot. Pull out about 1" (2 cm) of the ribbon behind the foot.
6. Snap the foot onto the machine.
7. When sewing, place the ribbon over your shoulder or to the right of the machine. It is very imortant that the ribbon flows easily while you are sewing.

Free-motion sewing with ribbons

To free-motion stitch, your machine must have a special free-motion function. This function is available for models in group 1 and 7-9.

1. Prepare the machine as described to the left.
2. Set the machine for free-motion sewing (please consult your User's Guide for instructions).
3. Hold the ribbon end when beginning to sew. Guide the fabric lightly. Turn the fabric to change sewing direction.

Hints

- Use light weight "flat" ribbons, for example, organza (ribbons with coarse texture will not feed smoothly through the foot).
- For different looks, cut your own ribbons from fabric straight or on the bias.
- When doing a spiral or a swirl, sew from the inside out.



3 MM SHELL ROLLED HEM FOOT

411852045

① ② ③ ④ ⑤ ⑥ ⑦ ⑧ ⑨

Not for

EMERALD™ 122, 118 and 116 machines,
EDEN ROSE™ 250M, TRIBUTE™ 140M, 145M.

2 MM SHELL ROLLED HEM FOOT

411852445

① ② ③ ④ ⑤ ⑥ ⑦ ⑧ ⑨

Not for

EMERALD™ 122, 118 and 116 machines,
EDEN ROSE™ 250M, TRIBUTE™ 140M, 145M.

Stitch a rolled hem in sheer and very lightweight fabrics for evening wear, lingerie, scarves. Zigzag stitch, length 10.0, width 4-6 can also use stitch {length 10.0, width 3-5. ◀

1. Snap on 2 mm Shell Rolled Hem Foot.
2. Press a rolled hem (the width of the tunnel on the underside of the foot) in the first inch of the hem.
3. Place the hem under the presser foot and stitch several stitches along the edge of the hem.
4. Stop with the needle in the fabric, raise the presser foot and pull the fabric edge up into the scroll/guide on the foot.
5. Lower the presser foot, continue to sew. Do not help the fabric edge to roll, simply hold it vertically.

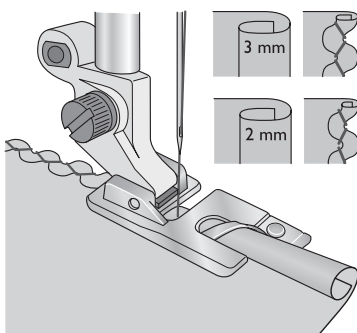

7-HOLE CORD FOOT WITH THREADER

412989945

① ② ③ ④ ⑤ ⑥ ⑦ ⑧

11-HOLE CORD FOOT WITH THREADER

920621096

⑨

Create one-of-a-kind trims and stitch them in place in one step. Couch or stitch up to 7/11 decorative threads at once for quick embellishment using a decorative stitch or zigzag stitch wide enough to stitch over threads. Stabilize as needed.

1. Thread decorative thread into holes from the top of the foot. The more holes you thread, the wider the decorative embellishment. Wrap lengths of thread on an empty spool to prevent tangles.
2. Snap on 7/11-Hole Cord Foot. Place threads under the foot. If using the 11 - Hole Cord foot engage the IDF System
3. Mark a design on your fabric, stabilize as needed, sew. The decorative threads will be stitched down creating a beautiful braid embellishment.

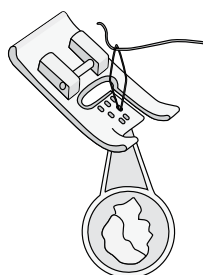



HEIRLOOM
SEWING

Before the invention of the sewing machine, beautiful hand sewing techniques created “one-of-a-kind” heirloom garments. Heirloom sewing techniques give you a feeling of tradition, romance and times long past. With the Heirloom accessories, you can easily sew the same techniques on your HUSQVARNA® VIKING® Sewing Machine in a fraction of the time.



TRANSPARENT B FOOT

920622096

⑤ ⑥ ⑦ ⑧ ⑨

Satin stitch appliqué, taper stitches and decorative stitches. Length as desired. The tunnel on the underside of the foot feeds smoothly over the stitches. Because it is clear and has red guidelines, visibility and accuracy is improved. Use stabilizer as needed.

1. Snap on foot.
2. Set decorative or satin stitch.
3. Sew.

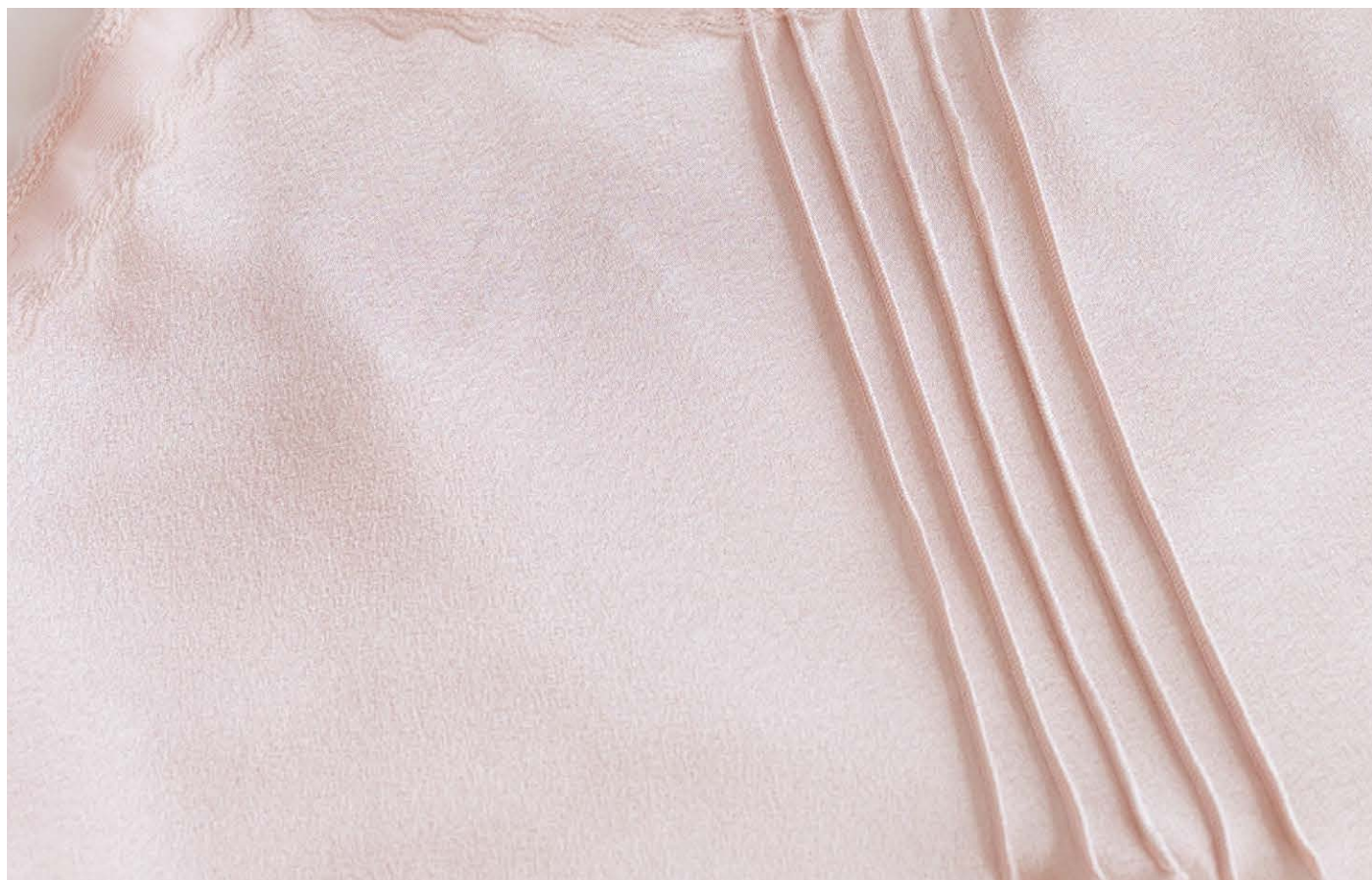

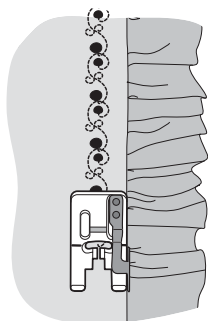

CLEAR B EDGE STITCHING FOOT

920624096

⑤ ⑥ ⑦ ⑧ ⑨

The Clear B Edge Stitching Foot guides decorative stitching along an edge perfectly. The tunnel on the bottom of the foot allows stitches to form perfectly and feed flawlessly. The flange along the edge of the foot keeps the distance between the edge of the fabric and the stitching consistent. Anytime your SEWING ADVISOR™ feature or GraphicDisplay recommends the “B” foot, use the Clear B Edge Stitching Foot when sewing along an edge.

1. Snap on the Clear B Edge Stitching Foot.
2. Place your project under the foot with the flange guide at the edge of the project.
3. Select the decorative stitch of your choice.
4. Sew.

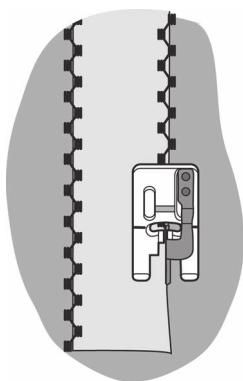

CLEAR B EDGE/JOINING FOOT

920623096

⑤ ⑥ ⑦ ⑧ ⑨

The Clear B Edge/Joining Foot guides decorative stitching over a seam, or marked line. The tunnel on the bottom of the foot allows the stitches to form perfectly and feed flawlessly. The flange in the center of the foot keeps the stitches aligned perfectly with the seam or marked line. Anytime your SEWING ADVISOR™ feature or GraphicDisplay recommends the “B” foot, use the Clear B Edge/Joining Foot when sewing along a seam or marked line.

1. Snap on the Clear B Edge/Joining Foot.
2. Place the seam or marked line under center flange of the foot.
3. Select the decorative stitch of your choice.
4. Sew, keeping the flange, aligned with the seam or line as you sew.



SPECIALTY CANDLEWICKING FOOT

413162345

① ⑥ ⑦ ⑧ ⑨

Not for

IRIS™, SCANDINAVIA™ and EMERALD™ series.

Sew beautiful heirloom candlewicking techniques! The foot has a deep tunnel on the underside to feed over built up stitching.

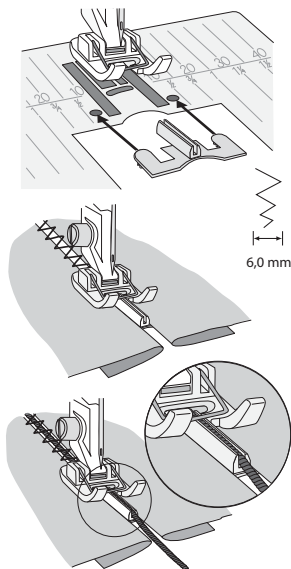

SPANISH HEMSTITCH FOOT

413064845

--	--

⑧

BRILLIANCE™ series, DESIGNER DIAMOND™ series, DESIGNER RUBY™ series, DESIGNER TOPAZ™ series, SAPPHIRE™ series, OPAL™ series, DESIGNER JADE™ series, EDEN ROSE™ 250C, TRIBUTE™ 140C, 145C, 150C.

Spanish Hemstitching is a delightful addition to any project. It is used to join two finished edges. It works well to attach borders, edging to a skirt or curtain or to piece fabric, for example to achieve the width needed for a tablecloth. For the above models, the Spanish Hemstitch Distance Plate snaps on to the standard needle plate.

1. Snap the Distance Plate onto the needle plate by placing the little prongs into the holes in the plate. Be sure that the plate doesn't cover the feed teeth. Snap on the Spanish Hemstitch Foot.
2. Thread with a decorative thread on top and in the bobbin.
3. Select a zigzag, three step zig zag. Adjust stitch width to make sure that the needle catches the fabric edges. **Note: Avoid using stitches with too much side motion and stitches with too much motion forward and back.**
4. You need to have a finished edge. If necessary, press under a 3/8" (1 cm) seam allowance on the fabric edges that will be stitched together.
5. Place the pressed edge of the pieces on each side of the Distance Plate.
6. Lower the presser foot.

Start with a long thread tail of both top and bobbin thread. Hold these threads as you begin sewing until the needle catches on the fabric. Because of the nature of the stitching, it will stitch on "air" for several stitches before it goes over and catches the fabric edge. Once the needle has caught the fabric, you can let go of the threads. Sew, holding the edges gently together in front of the foot. Optional: Place a decorative thread in the groove of the Distance Plate.



9 GROOVE PIN TUCK FOOT

412370045

① ② ③ ④ ⑤ ⑥ ⑦ ⑧* ⑨*

Sew quick tucks in very light weight fabrics. Use with Twin Needle. Straight stitch, length 1.5-2.0.

1. Snap on Pin Tuck Foot. Insert and thread 1.6 twin needle.
2. Sew. Tucks are formed by twin needle sewing as fabric tunnels into the groove on underside of foot.
3. Place tuck in outside groove of foot to guide next tuck.

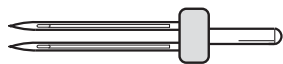

TWIN NEEDLE

920721096: 1.6mm, Size 70

* Not suitable for use with Automatic Needle Threader



7 GROOVE PIN TUCK FOOT

412362845

① ② ③ ④ ⑤ ⑥ ⑦ ⑧*

Sew quick tucks in light weight fabrics. Use with Twin Needle. Straight stitch, length 2.0.

1. Snap on Pin Tuck Foot. Insert and thread 1.6 or 2.0 twin needle.
2. Sew. Tucks are formed by Twin Needle sewing as fabric tunnels into the groove on underside of foot.
3. Place tuck in outside groove of foot to guide next tuck.



TWIN NEEDLE

920721096: 1.6 mm, Size 70

920655096: 2 mm, Size 80

* Not suitable for use with Automatic Needle Threader



5 GROOVE PIN TUCK FOOT WITH RAISED SEAM PLATE

412369945

⑧* ⑨*

DESIGNER DIAMOND™ series, DESIGNER RUBY™ series, DESIGNER TOPAZ™ series, SAPPHIRE™ series, OPAL™ series, BRILLIANCE™ series, EDEN ROSE™ 250C, TRIBUTE™ 140C, 145C, DESIGNER JADE™ series, DESIGNER SAPPHIRE™ 85.

Sew quick tucks in light to medium weight fabrics. Use with twin needle. Straight stitch, length 2.5.

1. Snap on Pin Tuck Foot. Insert and thread 2.0 twin needle.
2. Sew. Tucks are formed by twin needle sewing as fabric tunnels into the groove on underside of foot.
3. Place tuck in outside groove of foot to guide next tuck.

* Not suitable for use with Automatic Needle Threader

TWIN NEEDLE

920655096: 2 mm, Size 80





3 GROOVE PIN TUCK FOOT WITH RAISED SEAM PLATE

412992845

⑧ * ⑨ *

For

DESIGNER DIAMOND™ series, DESIGNER RUBY™ series, DESIGNER TOPAZ™ series, SAPPHIRE™ series, OPAL™ series, BRILLIANCE™ series, EDEN ROSE™ 250C, TRIBUTE™ 140C, 145C, DESIGNER JADE™ series, DESIGNER SAPPHIRE™ 85.

Sew quick tucks in medium weight fabrics. Use with Twin Needle. Straight stitch, length 2.5.

1. Snap on foot. Insert and thread 2.0 or 2.5 twin needle.
2. Pintucks are formed by Twin Needle sewing as fabric tunnels into the groove on underside of foot.
3. Place tuck in outside groove of foot to guide next tuck.

Note: Snap on Raised Seam Plate for heavier fabrics or to place cord in tucks. For corded tucks, place cord or yarn in guide on raised seam plate.

Note: Use the Edge/Quilting Guide (412601945) for evenly spaced tucks.

* Not suitable for use with Automatic Needle Threader

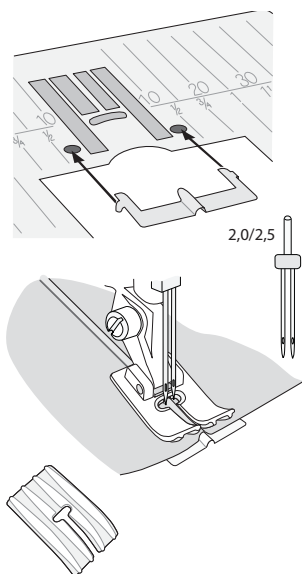

TWIN NEEDLE

920655096: 2 mm, Size 80



920546096: 2.5 mm, Size 80





3 GROOVE PIN TUCK FOOT WITH RAISED SEAM PLATE

412845645

① ② ③ ④ ⑤ ⑥ ⑦

Not for

DESIGNER DIAMOND™ series, DESIGNER RUBY™ series, DESIGNER TOPAZ™ series, SAPPHIRE™ series, OPAL™ series, EDEN ROSE™ 250M, TRIBUTE™ 140M, JADE™ series, BRILLIANCE™ series, DESIGNER SAPPHIRE™ 85, ONYX™ series.

Sew quick tucks in medium weight fabrics. Use with Twin Needle. Straight stitch, length 2.5.

1. Snap on foot. Insert and thread 2.0 or 2.5 twin needle.
2. Pintucks are formed by Twin Needle sewing as fabric tunnels into the groove on underside of foot.
3. Place tuck in outside groove of foot to guide next tuck.

Note: Snap on Raised Seam Plate for heavier fabrics or to place cord in tucks. For corded tucks, place cord or yarn in guide on raised seam plate.

Note: Use the Edge/Quilting Guide (412601945) for evenly spaced tucks.

* Not suitable for use with Automatic Needle Threader

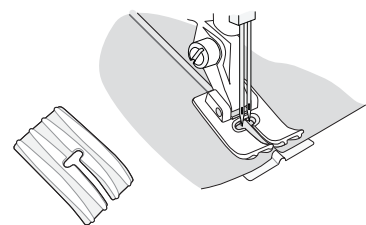

TWIN NEEDLE

920655096: 2 mm, Size 80

920546096: 2.5 mm, Size 80

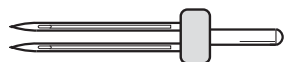

MARKING FOOT

411850345

① ② ③ ④ ⑤ ⑥ ⑦ ⑧ ⑨

Not for

EMERALD™ 122, 118 and 116 machines, EDEN ROSE™ 250M, TRIBUTE™ 140M, 145M.

Transfer pattern markings with thread tacks. Use decoratively to create open/ladder seams or loops that can be fringe or animal hair. Zigzag stitch, length 1.5-2.5, width 3 or satin stitch, length 0.8-1.0, width 3.0. Snap on Marking Foot. Reduce tension slightly.

Tailor Tacks:

1. Sew several stitches to mark. Do not tie off. Stitches will loop and be easy to remove

Open/ladder seams:

1. Stitch two pieces of fabric right sides together.
2. Pull the fabrics to expose the open seam created by the looping threads.
3. Press seam allowances away from the open work and stitch down if desired.

Decorative Loops or Fringe:

1. Stitch with Marking Foot following desired design.
2. Finger press loops to one side and stitch along base of loops with a straight stitch to anchor them. (For fringe, cut at center of loops.)



EDGE/QUILTING GUIDE

412601945

⑤ ⑥ ⑦ ⑧ ⑨

Not For
DESIGNER EPIC™ 3

The Edge Quilting guide is used for wide seam allowances, pintucks, topstitching, or channel quilting.

1. Slide the guide into the clip on the ankle.
2. Adjust from side to side to the correct position.







QUILTING

Historically, machine quilting was stitched for functional use but also offered quilters the opportunity to express their creativity. During the last decade, quilting by machine has developed into an art form. Quilters express their creativity with fabrics, fibers, threads, beautiful stitches and free-motion artistry. HUSQVARNA® VIKING® listens and has designed accessories and presser feet that will encourage your quilting expertise and enjoyment.



EXTENSION TABLE WITH ADJUSTABLE GUIDE

57 ◀

920361096

For DESIGNER DIAMOND™ series, DESIGNER RUBY™ series, DESIGNER TOPAZ™ series, BRILLIANCE™ series, SAPPHIRE™, OPAL™ series and DESIGNER SAPPHIRE™ 85, EDEN ROSE™ 250C, TRIBUTE™ 140C, 145C, 150C.

920437096

⑧ ⑨

Not For DESIGNER EPIC™ 3



920808096
DESIGNER EPIC™ 3

Designed and manufactured for HUSQVARNA® VIKING® Sewing Machines this extension table attaches to your machine the same way as your accessory box and substantially increases your work area. It is very stable, and because no legs are needed, you have the clearance underneath the extension table for circular items. The Adjustable Guide with ruler has both centimeters and inches to allow you to sew hems, borders and more with perfect accuracy. The ruler printed right on the extension table measures from the needle in both centimeters and inches so you always have the measurements you need right at hand.



EXTENSION TABLE

920459096

For DESIGNER JADE™ 35, 20.

920790096

For ONYX™ 25, 15.

This sturdy extension table has adjustable legs and allows you to convert the free arm to an extended flat bed to easily support large projects.



QUILTER'S TABLE

413112001

For DESIGNER DIAMOND™ series, DESIGNER RUBY™ series, DESIGNER TOPAZ™ series, BRILLIANCE™ series, SAPPHIRE™, OPAL series and DESIGNER SAPPHIRE™ 85, EDEN ROSE™ 250C, TRIBUTE™ 140C, 145C, 150C.

920633096

⑧ ⑨

Not For DESIGNER EPIC™ 3

Convert the free arm of your HUSQVARNA® VIKING® Sewing Machine to an extended flat bed so you can sew large projects and quilts easily.

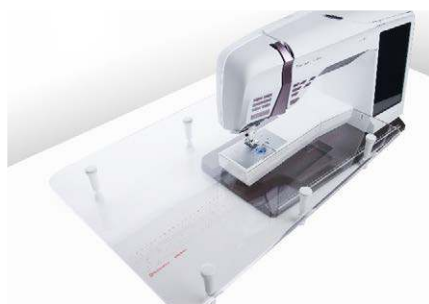

1. When opening package, remove the white adhesive protective paper from the Lexan table.
2. If required wipe the surface with a soft damp cloth to remove any residue from the adhesive protect paper / film.
3. Hold table with HUSQVARNA® VIKING® label and measuring tape right side up. Place screws in holes from the top. Screw the legs onto the underside of the table. Screw the feet into the legs of the table.
4. Slide the table onto the free arm of the machine and screw the feet up or down to adjust the height.



INTERCHANGEABLE DUAL FEED

920219096

⑤ ⑥ ⑦

Not for

EMERALD™ series, EDEN ROSE™ 250M,
TRIBUTE™ 140M, and 145M, ONYX™ SERIES

The Dual Feed Foot with changeable presser feet is designed to feed layers of fabric and/or batting evenly. It is perfect for quilting, sewing velvet, stretch fabrics, imitation leathers and fabrics need precise pattern matching. Snap on the Changeable Straight Stitch Foot. Select the center needle straight stitch. Adjust it up to a maximum stitch length of 6. Snap on the Changeable Zigzag Foot and select stitches up to a maximum of 7 mm wide and 6mm long.

1. Remove the presser foot ankle by unscrewing the ankle screw.
2. Place the Dual Feed Foot onto your machine from the back, positioning the fork over the needle clamp screw. Screw the Dual Feed Foot onto the presser foot bar with the presser foot ankle screw. Reduce presser foot pressure to 3.

Snap-on and remove the changeable presser foot

3. With presser foot bar in the up position, place the presser foot under the Dual Feed Foot.
4. Push the changeable foot upwards so that it snaps into place.
5. To remove the changeable foot, push the front of the foot upwards until the foot snaps off.

How to attach the guide

The two guides included with the Dual Feed Foot will help you sew parallel rows of stitching side by side as in channel quilting or tucking. There is one guide for the left side, and one for the right.

6. Insert the guide into the hole in the back of the dual feed.
7. Adjust the space between the foot and the guide by pulling it to the left or to the right.



WALKING FOOT

416358301

For

EMERALD™ SERIES, EDEN ROSE™ 250M, TRIBUTE™
140M, 145M.

The Walking Foot makes it easy to sew several fabric layers such as quilting, match plaids or stripes, or sew napped or slippery fabrics.

The feed dogs of the walking foot work with the feed dogs of the machine to keep the fabric layers moving together. The Even Feed Foot securely grips the top layer or layers of fabric while the sewing machine feeds the fabric from below. Plaids, stripes, and quilt layers stay perfectly aligned and leather, suede and vinyl flow easily through your machine.

1. Remove the presser foot and presser foot ankle.
2. Position the arm of the Walking Foot over the needle clamp screw and attach to the shank of the machine with the screw. Tighten securely.
Note: As the needle goes up and down, the feed dogs also move up and down, pulling the upper layer of fabric evenly along with the lower fabric.
3. Select the straight, zigzag, or other desired stitch. Do not select stitches with many backward stitches.
4. Place fabrics under the Walking Foot and stitch.

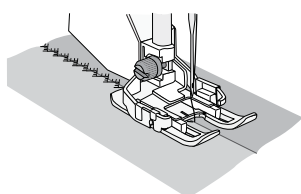
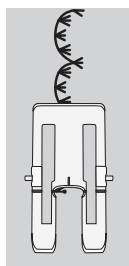

CHANGEABLE OPEN TOE FOOT

(for 920219096 Interchangeable Dual Feed)

413237845

⑤ ⑥ ⑦ ⑧

Not for

EMERALD™ 122, 118 and 116 machines,
EDEN ROSE™ 250M, TRIBUTE™ 140M, 145M, ONYX™
series.

The Interchangeable Dual Feed with Changeable Presser Feet is designed to feed layers of fabric and/or batting evenly. It is perfect for quilting, sewing velvet, some stretch fabrics, imitation leathers and fabrics which need accurate pattern matching. Use the Changeable Open Toe Foot when sewing Satin stitch appliqué, Taper stitches and Decorative stitches. The tunnel on the underside of the foot feeds smoothly and the open front gives greater visibility and a great overview of the stitches.

1. Attach the Interchangeable Dual Feed to your machine:
 - a. Remove the presser foot ankle by unscrewing the ankle screw.
 - b. Place the Interchangeable Dual Feed onto your machine from the back, positioning the fork over the needle clamp screw. Screw the Interchangeable Dual Feed onto the presser foot bar with the presser foot ankle screw.
 - c. With presser foot bar in the up position, place the Changeable Open Toe Foot under the Interchangeable Dual Feed.
2. Push the Changeable Open Toe Foot upwards so that it snaps into place.
3. Choose a decorative or a satin stitch.
4. Sew. The red markings on the foot will help you guiding the fabric as you sew.

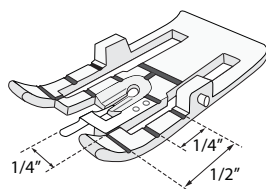

CHANGEABLE QUILTERS GUIDE FOOT

(for Interchangeable Dual Feed)

413155545

⑤ ⑥ ⑦ ⑧

Not for EMERALD™ 122, 118 and 116 machines,
EDEN ROSE™ 250M, TRIBUTE™ 140M, 145M, ONYX™
serie.

Use the Changeable Quilter's Guide Foot when stitching in the ditch along a seam line. The foot has guidelines to make it easy to accurately turn corners for 1/4" (6mm) or 1/8" (3mm) seams.

The Dual Feed with Changeable Presser Feet is designed to feed layers of fabric and/or batting evenly. It is perfect for quilting, sewing velvet, some stretch fabrics, imitation leathers and fabrics which need accurate pattern matching.

1. Stitching in the ditch means stitching in the finished seam line.
2. Snap on the Changeable Quilter's Guide Foot. Select the center needle straight stitch and adjust it up to a maximum stitch length of 6.
3. Place the fabric to be stitched under the presser foot aligning the guide in the center of the foot with the seam line.
4. To pivot 1/4 (6mm) from the end: Select the Needle Up/Down to activate the needle down. Sew the seam. Stop sewing when the front line on the foot is even with the edge of the fabric. Raise the presser foot, pivot and continue sewing.
5. The Changeable Dual Feed Foot makes feeding several layers smooth and easy.

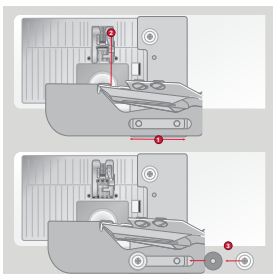

QUILT BINDER

920507096

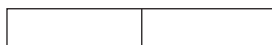

⑧ ⑨**

BRILLIANCE™ series, DESIGNER DIAMOND™ series*, DESIGNER RUBY™ series*, DESIGNER TOPAZ™ series*, SAPPHIRE™ series*, OPAL™ series*, EDEN ROSE™ 250C*, TRIBUTE™ 140C*, 145C*, 150C* DESIGNER SAPPHIRE™ 85.

The Double Fold 1/2" (12mm) binder will turn a light weight woven fabric strip into a binding and attach it to the project edges all in one step when fitted with 412964206 or 412964207 stitch plate.

To bind edges with the 1/2" (12mm) Quilt Binder, cut a 1 3/4" (45mm) wide strip of light weight woven fabric.

** When used with 920568096 Quilt Binder Foot for IDF System.

1. Attach the Interchangeable Dual Feed or attach the quilt binder foot for IDF system.
2. Set the machine for straight stitch or hand look quilt stitch.
3. Place the attachment plate on the stitch plate of the machine. Align pin on the back of attachment plate to the top opening on the stitch plate of the machine. Screw the attachment plate in place with one thumb screw.
4. Place the binder on the attachment plate and adjust the binder to line up. Attach the binder in place with the two thumb screws and washers.
5. Measure the length of your project and add at least 6" (15cm).
6. Cut enough 1 3/4" (45mm) strips to equal that number and join the strips together. Cut the end of the strip into a point.
7. Slide the fabric strip into the binder with the wrong side facing you using tweezers.
8. When the fabric is through the end of the binder, hold the folded strip with your left hand and continue to feed it into the binder as shown while the fabric forms a double fold tape.
9. Raise the presser foot and pull the strip under the foot and straight back 2.5" (5-6cm) behind the needle.
10. Slide the fabric to be bound right side up into the slot of the binder. Adjust the stitch position to right or left to reach the desired needle position.

How to sew a quilt binder corner:

Sew to the edge of the quilt, tie off and then pull the quilt out from binder. Keep the quilt close to the binder when folding the corners. Finger press the folded fabric.

* When fitted with 412964206 or 412964207 stitch plate

Create a mitered corner:

1. Fold and pinch the top mitered corner, pin in place with a long pin. Repeat in the same way on the back of the quilt.
2. To continue sewing the binding, pull the fabric strip back through the binder and at the same time place the quilt back under the presser foot and into the binder again.
3. To insure that the fold is right on both top and back, pull the quilt forward and back again a couple of times.
4. Lower the needle to hold the binding in place and remove the needles. Pull out long thread tails behind the presser foot before start to sew. Backstitch and sew the binder in place. Repeat on the other corners.

How to end the binding:

1. Sew the binding all the way around the quilt edges. When the edges off the binding almost meet, cut the excess of fabric in the beginning of binding as illustration.
2. Continue to sew, overlapping the binding one more time. Remove the quilt from the binder and trim excess leaving 1" (2.5cm) tail. Fold back the opening and pin in place. Sew a seam over the folded edge.

NOTE: See detailed instructions included with the attachment.



5/8" QUILT BINDER

920726096



⑧ ⑨

BRILLIANCE™ SERIES, DESIGNER DIAMOND™ SERIES*, DESIGNER RUBY™ SERIES*, DESIGNER TOPAZ™ SERIES*, SAPPHIRE™ SERIES*, OPAL™ SERIES*, EDEN ROSE™ 250C*, TRIBUTE™ 140C*, 145*, 150C*.

* When fitted with 412964206 or 412964207

Creates an easy to apply double folded 5/8" binding to finished garments, home décor and quilt projects.

- Easy to add a double layer of binding similar to traditional methods.
- Uses a 3" (80mm) wide strip of fabric to create a finished binding 5/8" (15mm) wide.
- Includes feet for both IDF and non IDF machines



CHANGEABLE 1/4" GUIDE FOOT

(for Interchangeable Dual Feed)

413238345

⑤ ⑥ ⑦ ⑧

Not for

EMERALD™ 122, 118, 116 machines,

EDEN ROSE™ 250M, TRIBUTE™ 140M, 145M, ONYX™ series.

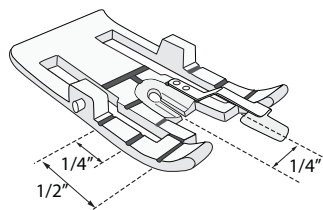

The Interchangeable Dual Feed with Changeable Presser Feet is designed to feed layers of fabric and/or batting evenly. It is perfect for quilting, sewing velvet, some stretch fabrics, imitation leathers and fabrics which need accurate pattern matching. Use the Changeable 1/4" Guide Foot for straight stitch and hand look quilt stitch. The guide will help you keep 1/4" (6mm) distance.

1. Attach the Interchangeable Dual Feed to your machine:
 - a. Remove the presser foot ankle by unscrewing the ankle screw.
 - b. Place the Interchangeable Dual Feed onto your machine from the back, positioning the fork over the needle clamp screw. Screw the Interchangeable Dual Feed onto the presser foot bar with the presser foot ankle screw.
 - c. With presser foot bar in the up position, place the Changeable 1/4" Guide Foot under the Interchangeable Dual Feed.
2. Push the Changeable 1/4" Guide Foot upwards so that it snaps into place.

Piecing:

3. Because this foot has a small opening to better form the stitches for piecing, you can only use the center needle position straight stitch or the hand look quilt stitch.
4. To begin sewing at the edge of the fabric, place your fabric under the foot, aligning the raw edges with the guide on the foot.
5. Sew the seam, keeping the edges aligned with the guide.

Quilting:

6. The red markings on the foot will help you to align the fabric at the start of your sewing, at corners and at the end of your fabric.
7. Sew with the guide riding in the pieced seam (ditch) of the quilt. When you come to a corner, stop when the 1/4" red marking on the foot reaches the seam.
8. With the needle in the fabric, pivot and continue sewing.



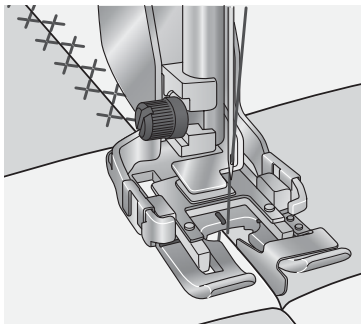

CHANGEABLE DECORATIVE GUIDE FOOT

(For Interchangeable Dual Feed)

413340845

⑤ ⑥ ⑦ ⑧

Not for

EMERALD™ 122, 118 and 116 machines,
EDEN ROSE™ 250M, TRIBUTE™ 140M, 145M, ONYX™
serie.

The Interchangeable Dual Feed with Changeable Presser Feet is designed to feed layers of fabric and/or batting evenly. It is perfect for quilting, sewing velvet, most stretch fabrics, imitation leathers and fabrics which need accurate pattern matching. Use the Changeable Decorative Guide Foot when stitching in the ditch along a seam line sewing any decorative stitch. The metal guide in the center of the foot helps you when guiding your fabric.

1. Attach the Interchangeable Dual Feed to your machine:
 - a. Remove the presser foot ankle by unscrewing the ankle screw.
 - b. Place the Interchangeable Dual Feed (Foot) onto your machine from the back, positioning the fork over the needle clamp screw. Screw the Interchangeable Dual.
2. Feed (Foot) onto the presser foot bar with the presser foot ankle screw.
 - a. With presser foot bar in the up position, place the Changeable Decorative Guide Foot under the Interchangeable Dual Feed (Foot).
3. Push the Changeable Decorative Guide Foot upwards so that it snaps into place.
4. Select a decorative stitch of your choice.
5. Place the fabric to be stitched under the presser foot aligning the guide in the center of the foot with the seam line. (Stitching in the ditch means stitching in the finished seam line.) Illustration.
6. Sew, keeping the guide aligned with the seam as you sew.



QUILTER'S PRESSER FEET KIT

413035302

⑤ ⑥ ⑦

Not for

EMERALD™ 122, 118 and 116 machines,
EDEN ROSE™ 250M, TRIBUTE™ 140M, 145M, ONYX™
series.

Content: Dual Feed Foot with Guide, Open Toe Stippling Foot, Clear 1/4" Piecing Foot with Guide. Everything you need to get started with quilting.



ADJUSTABLE 1/4" FOOT

920455096

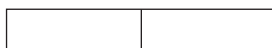

① ② ③ ④ ⑤ ⑥ ⑦ ⑧ ⑨

The Adjustable 1/4" Foot is designed to help you achieve a 1/4" (6mm) or scant 1/4" (less than 6mm) seam when piecing.

The needle hole in the foot is oval shaped allowing you to adjust the needle position.

The distance between the center needle position and the guide is 1/4" (6mm).

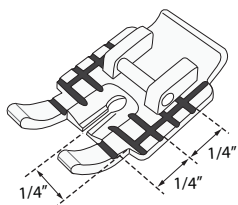

1. Snap-on the Adjustable 1/4" Foot.*
2. Select a straight stitch.
 - a. For a 1/4" (6mm) seam; select a centered the needle position.
 - b. For a scant 1/4" seam; adjust the needle position one or two steps to the right.
3. Place the fabric pieces right sides together under the presser foot, aligning the edges of the fabric with the edge of the foot.
4. Sew the fabric pieces together guiding the fabric so that the edges touch the guide.
5. Press the seam allowance.

Note: Depending on the weight of your fabric and thread it may be necessary to adjust the needle position to achieve your desired seam allowance. Move the needle to the right to decrease the seam allowance and to the left to increase it. You can safely move the needle three steps in either direction, but not more.

*Do not use the Straight Stitch Plate when using the Adjustable 1/4" Foot.



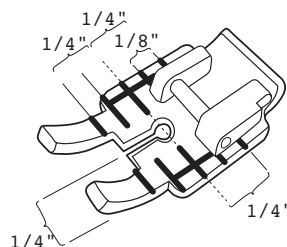
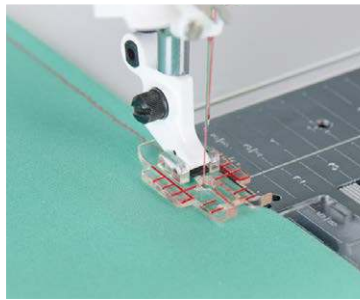

CLEAR ADJUSTABLE 1/4" PIECING FOOT

920651096

--	--

⑤ ⑥ ⑦ ⑧ ⑨

For clear visibility when 1/4" (6 mm) and 1/8" (3 mm) seams with straight stitch are desired. Guidelines to turn corners for 1/4" (6 mm) or 1/8" (3 mm) seams.

1. The Clear 1/4" Piecing Foot can be used whenever you require a 1/4" (6 mm) or 1/8" (3 mm) seam. It is ideal when you are stitching 1/4" (6 mm) away from an appliqué, embroidery etc., for example in echo quilting. The Clear 1/4" Piecing Foot works well when stitching in the center of the fabric.
2. Snap on the Clear 1/4" Piecing Foot. Thread with sewing thread or invisible thread on top and sewing thread in the bobbin. Touch Needle Stop Down.
3. The Clear 1/4" Piecing Foot has red marks on the foot. They will help you to align the fabric at the start of your sewing, at corners and at the end of your fabric.
4. To begin 1/4" (6 mm) from the edge of the fabric, place your fabric under the foot, aligning edge of the fabric with the front red mark on the foot. This mark is 1/4" (6 mm) from the needle. To begin sewing 1/8" (3 mm) from the edge of the fabric, align the fabric with the second line from the front.
5. To pivot 1/4" (6 mm) from the end, stop sewing when the front line on the foot is even with the edge of the fabric you are quilting around. The needle will be in the down position, DESIGNER™ Series machines will automatically stop in Pivot Position. On other models, raise the presser foot. Turn the fabric.

You will be positioned 1/4" (6 mm) from the edge of the appliqué, embroidery, etc. you are quilting around and be ready to begin sewing.

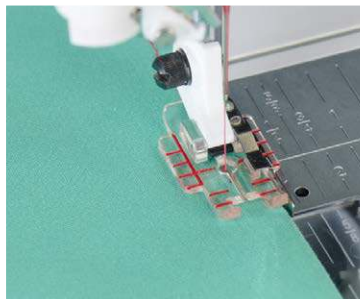

CLEAR ADJUSTABLE 1/4" PIECING FOOT WITH GUIDE

920652096

--	--

⑤ ⑥ ⑦ ⑧ ⑨

For straight stitch and hand look quilting stitches. Guide will help you keep the 1/4" (6 mm) distance. Clear means you have good visibility to view the sewing. For beginners as well as for experienced quilters.

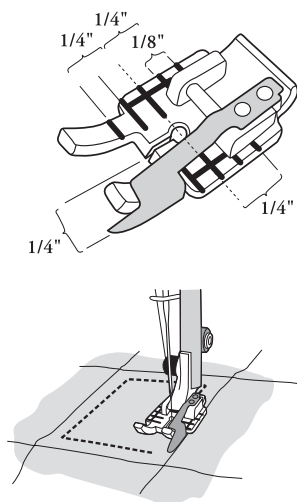

1. For piecing, select Woven Medium, Seam on your SEWING ADVISOR™ feature or center needle position straight stitch. Because this foot has a small opening to better form the stitches for piecing, you can use straight stitch only or the hand look quilt stitch.
2. The Clear 1/4" (6 mm) Piecing Foot with Guide has red marks on the foot. They will help you to align the fabric at the start of your sewing, at corners and at the end of your fabric.
3. To begin sewing at the edge of the fabric, place your fabric under the foot, aligning the raw edges with the guide on the foot. Sew the seam, keeping the edges aligned with the guide.
4. To begin sewing 1/4" (6 mm) from the edge of the fabric, line the fabric up with the line furthest to the back of the foot as show. To begin sewing 1/8" (3 mm) from the edge of the fabric, align the fabric with the next line forward.
5. To stop sewing 1/4" (6 mm) from the end, stop sewing when the front line on the foot is even with the edge of the fabric.
6. To use the Clear 1/4" (6 mm) Piecing Foot with Guide for topstitching a finished edge, align the guide on the right of the foot with the edge of the fabric. Stitch. The Handlook Quilt Stitch can be used if desired, to give a hand stitched look. If using the Handlook Quilt Stitch follow the instructions for threading in your User's Guide.



CLEAR ADJUSTABLE STITCH-IN-DITCH FOOT

920653096

⑤ ⑥ ⑦ ⑧ ⑨

For excellent visibility, and ease of use, when stitching in the ditch. Guidelines to turn corners for $\frac{1}{4}$ " (6 mm) or $\frac{1}{8}$ " (3 mm) seams. For quilting, garment construction and more.

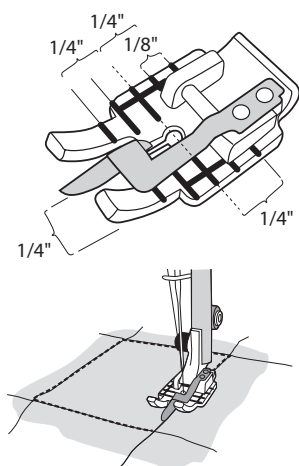

1. Stitching in the ditch means stitching in the finished seam of a quilt or binding. There is usually a higher edge to the seam. The side where the seam allowances have been pressed to, and the lower side. The side without the seam allowances.
2. Snap on the Clear Stitch-in-Ditch Foot. Thread with matching thread or invisible thread on top and thread to match your quilt back in the bobbin.
3. Place the fabric to be stitched under the presser foot aligning the guide in the center of the foot with the seam. The guide will automatically fall on the low side of the seam and will stitch flawlessly down the seam of your quilt or binding.
4. To pivot $\frac{1}{4}$ " (6 mm) from the end, stop sewing when the front line on the foot is even with the edge of the fabric.



ADJUSTABLE STITCH-IN-DITCH FOOT

920457096

① ② ③ ④ ⑤ ⑥ ⑦ ⑧ ⑨

920567096

⑨

Stitching in the ditch means stitching in the finished seam of a quilt or binding. There is usually a higher edge to the seam, the side where the seam allowances have been pressed to, and the lower side, the side without the seam allowances.

1. Snap on the Adjustable Stitch-in-Ditch Foot. Thread with matching thread or invisible thread on top and thread to match your quilt back in the bobbin.
2. Place the fabric to be stitched under the presser foot aligning the guide in the center of the foot with the seam. The guide will automatically fall on the low side of the seam and will stitch flawlessly down the seam of your quilt or binding.
3. If the stitch is not in the seam you can move the needle up to three steps to the left or right to get the stitch perfectly lined up.
4. To pivot $\frac{1}{4}$ " (6 mm) from the end, stop sewing when the front line on the foot is even with the edge of the fabric.



ADJUSTABLE 1/4" FOOT WITH GUIDE

920456096

--	--

① ② ③ ④ ⑤ ⑥ ⑦ ⑧ ⑨

920566096

⑨

Piecing: The Adjustable 1/4" Foot with Guide is designed to help you achieve a 1/4" (6mm) or scant 1/4" (less than 6mm) seam when piecing.

The needle hole in the foot is oval shaped allowing you to adjust the needle position. The distance between the center needle position and the guide is 1/4" (6mm).

1. Snap-on the Adjustable 1/4" Foot with Guide. *
2. Select a straight stitch.
 - a. For a 1/4" (6mm) seam; select a centered the needle position.
 - b. For a scant 1/4" seam; adjust the needle position one or two steps to the right.
3. Place the fabric pieces right sides together under the presser foot, aligning the edges of the fabric with the guide on the foot.
4. Sew the fabric pieces together guiding the fabric so that the edges touch the guide.
5. Press the seam allowance.

Note: Depending on the weight of your fabric and thread it may be necessary to adjust the needle position to achieve your desired seam allowance. Move the needle to the right to decrease the seam allowance and to the left to increase it. You can safely move the needle three steps in either direction, but not more.

* Do not use the Straight stitch plate when using the Adjustable 1/4" Foot with Guide.

Topstitching: The Adjustable 1/4" Foot with Guide is also wonderful for topstitching. Adjust the needle position and use the guide to place your stitching exactly where you want it on your blocks, garments or home decor projects.

1. Snap-on the Adjustable 1/4" Foot with Guide.
2. Select a straight stitch, triple straight stitch or the mock hand quilting stitch. Adjust the needle position as desired if needed.
3. Place the project under the presser foot so that the guide on the foot runs in the ditch of the seam or along the edge of the fabric. Sew.

NOTE: Red markings on the Adjustable 1/4" Foot with Guide help you align the fabric when you start sewing, at corners and at the end of your fabric.



CLEAR OPEN TOE FOOT

413031945

① ② ③ ④ ⑤ ⑥ ⑦ ⑧ ⑨

Satin Stitch Appliqué, Taper Stitches, and Decorative Stitches. Length and width as desired. The clear view through foot makes it easy to match rows of stitches perfectly. The tunnel on the underside of the foot feeds smoothly over the stitches and the open front gives greater visibility and a great overview of the stitches.

1. Snap on foot.
2. Set decorative or satin stitch.
3. For best result use a marking pen to draw lines for exact guiding of the foot.



OPEN TOE FOOT

412800945

① ② ③ ④ ⑤ ⑥ ⑦ ⑧

920564096

⑨

Satin Stitch Appliqué, Taper Stitches, and Decorative Stitches. Length and width as desired. The clear view through foot makes it easy to match rows of stitches perfectly. The tunnel on the underside of the foot feeds smoothly over the stitches and the open front gives greater visibility and a great overview of the stitches.

1. Snap on foot.
2. Set decorative or satin stitch.
3. For best result use a marking pen to draw lines for exact guiding of the foot.



CLEAR OPEN TOE FREE-MOTION FOOT

412860645 (Floating)

① ⑦ ⑧ ⑨

The Clear Open Toe Free-Motion Foot is ideal for stitching free motion on print fabrics, or when stippling around pieced or embroidered designs. It gives clear vision for free motion sewing.

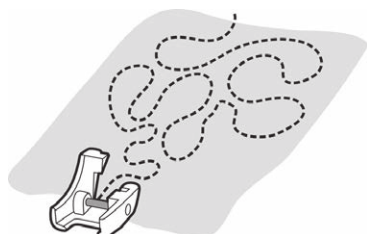

1. Snap on the Clear Open Toe Free-Motion Foot.
2. On the DESIGNER™ Models, select the V menu. The Feed teeth will drop automatically. On other models, follow your User's Guide for instructions on setting up for Free-Motion Sewing.
3. Thread with your choice of sewing or decorative thread on top and in the bobbin.
4. The stitch length setting doesn't matter because when you drop the feed teeth, the fabric is no longer being fed by the machine. You must feed (move) the fabric. The clear vision of the Clear Open Toe Free-Motion Foot will enable you to follow patterns easily. Stitch in place (don't move the fabric) for several stitches to fix start and endings.



FREE-MOTION GUIDE GRIP

412538845

Place on quilt for free-motion quilting and embroidery. No need to hoop the fabric. The friction surface on the underside of the guide grip holds the fabric taut and provides handles for moving fabric in any direction.

1. Lower the feed teeth and set machine for free motion or set presser foot pressure to the darning position.
2. Set for straight stitch or stitch of your choice.
3. Put on the Free-motion Presser Foot of your choice.
4. Place the guide grip on top of the quilt or fabric to be free-motion stitched.
5. Hold the handles and move the quilt at a steady pace for even stitches.



OPEN TOE STIPPLING FOOT

412801045 (Floating)

⑦ ⑧ ⑨

OPEN TOE FREE MOTION SPRING FOOT

920619096 (Spring action)

⑧ ⑨

413037646 (Spring action)

⑤ ⑥ ⑦

Not for

EMERALD™ 122, 118 and 116 machines,

EDEN ROSE™ 250M, TRIBUTE™ 140M, 145M, ONYX™ series.

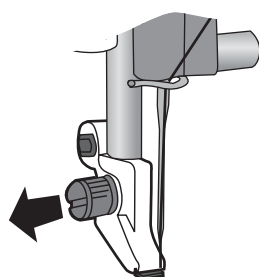
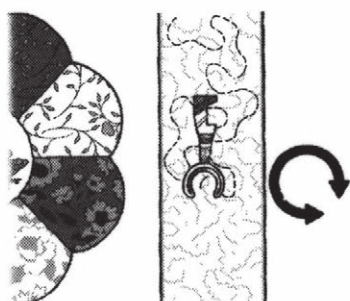
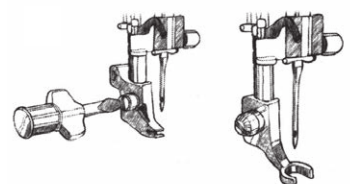

The Open Toe Free Motion Spring Foot gives clear visibility when doing free motion quilting or embroidery. Because of the open front, you can easily do stippling or follow a design in the fabric. The spring action keeps the fabric from lifting with the needle as the stitch is being formed which helps eliminate thread breakage with specialty or heavier threads. Be sure to use the appropriate needle for the thread you are using.

For SAPPHIRE™ series, select Free Motion Spring Action on the Set Menu. For DESIGNER™ series, select Sensor Q Foot on the Set Menu.

1. Remove the ankle and put on the Open Toe Free Motion Spring Foot.
2. Bring the bobbin thread to the top by taking one stitch.
3. Lower the presser foot.
4. Sew, moving the fabric as desired to quilt the fabric, or create a free motion design. Move the fabric in a smooth motion, moving the fabric faster as the speed of the machine is increased. You are creating the length of the stitch as you move the fabric.



CLOSED FREE MOTION SPRING FOOT

920620096 (Spring action)

⑧ ⑨

413385645 (Spring action)

⑤ ⑥ ⑦

Not for

EMERALD™ 122, 118 and 116 machines,
EDEN ROSE™ 250M, TRIBUTE™ 140M, 145M, ONYX™
series.

The Closed Free Motion Spring Foot gives great visibility around the foot when free motion quilting or sewing. The closed and round shape of the foot prevents threads or fabrics from getting stuck in the foot. The vertical and horizontal markings on the foot are useful as stitch guides. The spring action keeps the fabric from lifting with the needle as the stitch is being formed which helps eliminate thread breakage with specialty or heavier threads.

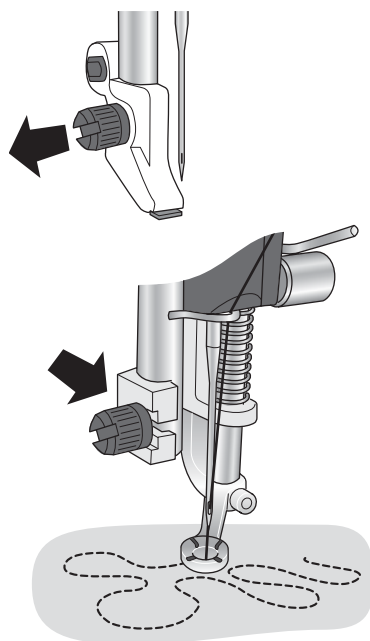

1. Loosen the presser foot ankle screw completely and remove the ankle.
Place the Closed Free Motion Spring Foot around the presser bar, attach it with the screw.
Hint: Lower the needle a little bit to make it easier to place the metal guide on the foot in the right position on the needle clamp
2. Thread your machine.
3. Choose center needle position straight stitch.
4. Set your HUSQVARNA® VIKING® sewing machine to Free Motion Spring Action mode. The feed dogs will drop automatically.
Note: When the feed dogs are dropped, the fabric is no longer fed by the machine. You must move the fabric.
5. Bring the bobbin thread to the top by taking one stitch. Hold on to both threads and sew a few stitches in place to begin.
6. Maintain a consistent speed and move the fabric in a smooth motion. You are creating the length of the stitch as you move the fabric. Use the red markings on the foot as a guide.

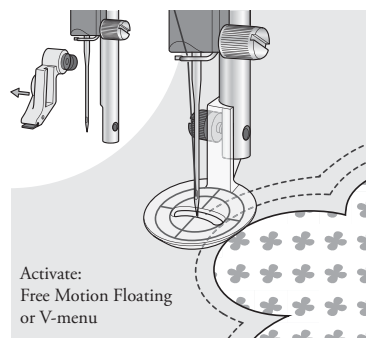

FREE MOTION ECHO QUILTING FOOT

413320245

⑦ ⑧ ⑨

The Free Motion Echo Quilting Foot is designed to give you more control when free-motion quilting. The large base ensures good surface contact with the fabric and provides better control of the stitching. The transparent base allows for 360° visibility. Vertical, horizontal and circular markings on the foot make it easy to follow a continuous line quilting pattern or design on the fabric. Sew straight lines or follow patterns with rounded edges in any direction.

1. Loosen the presser foot ankle screw completely and remove the ankle. Place the Free Motion Echo Quilting foot around the presser bar; attach it with the screw.
2. Thread your machine.
3. Select a straight stitch.
4. Set your sewing machine to Free Motion Floating mode. The feed dogs will drop automatically.
Note: When the feed dogs are dropped, the fabric is no longer fed by the machine. You must move the fabric.
5. Bring the bobbin thread to the top by taking one stitch. Hold onto both threads and sew a few stitches in place to begin.
6. Maintain a consistent speed and move the fabric in a smooth motion. You are creating the length of the stitch as you move the fabric.
7. Stitch around the quilting motif, appliqué or pattern on the fabric, maintaining a uniform distance to outline the shape.
8. Stitch a second row, maintaining a uniform distance from the first row. Use the red markings on the foot as a guide to keep your spacing even (illustration).
9. Repeat as many times as you want to create the desired effect.

Note: When sewing in Free Motion Floating mode at a low speed the presser foot will raise and lower with each stitch to hold the fabric on the stitch plate while the stitch is being performed. At a higher speed, the presser foot floats over the fabric while sewing.





RULER BASE FOR DESIGNER™ FABRIC FRAME

920631096

--	--

⑧ ⑨

The Ruler Base for the DESIGNER™ Fabric Frame gives extra stability around the needle area to support rulers and other templates while sewing and quilting. Remove the accessory tray from the machine, and place the machine onto the carriage of the DESIGNER™ Fabric Frame. Attach the Ruler Base around the arm of the machine.

Features:

- Gives extra stability round the needle area.
- Supports rulers and other templates while sewing.



FREE MOTION RULER FOOT

920508096

--	--

⑧ ⑨

BRILLIANCE™ Series, DESIGNER SAPPHIRE™ 85

The Free Motion Ruler Foot allows you to create a beautiful style of free motion quilting in conjunction with your ruler templates. The perfectly circular shape allows you to sew a constant $\frac{1}{4}$ " away from the edges of your ruler template. Red markings on the foot indicate the center of the foot, making it easy to line the foot and the ruler up when sewing. Cutouts in the front and side of the foot make it easier to see right up to the needle.

1. Loosen the presser foot ankle screw completely and remove the ankle.
2. Place the Free Motion Ruler Foot around the presser bar; attach it with the screw.
3. Thread your machine
4. Select a straight stitch
5. Set your machine to Free Motion Ruler Foot mode. The feed dogs will drop automatically. For machines without a free motion ruler foot setting use free motion floating, pivot height 0.
6. For machines without a free motion ruler foot setting use free motion floating, pivot height 0.

Note: When the feed dogs are dropped, the fabric is no longer fed by the machine. You must move the fabric.

7. Place the fabric under the foot and lower the foot.
8. Bring the bobbin thread to the top by taking one stitch. Hold onto both threads and sew a few stitches in place to begin.
9. Slide the edge of the ruler up to the foot. Place enough pressure on the ruler with your fingertips to gently glide the foot along the edge without the ruler moving.
10. Sew along the edge of the ruler. When near the end, stop the machine, lift the presser foot and slide the ruler into position to continue stitching the design.
11. When changing positions, stop the machine, and simply reposition the ruler and stitch in the direction needed to follow the ruler.



EMBROIDERY

The introduction of embroidery on HUSQVARNA® VIKING® sewing and embroidery machines has opened the doors to a new way to personalize and embellish everything you sew and to create designer “one-of-a-kind” garments and home decoration. Visit your local HUSQVARNA® VIKING® store for unique and beautiful embroidery designs and be sure to visit www.library.mysewnet.com/search for thousands more designs to choose from. There is a design for every project! To make your embroideries personal, do not miss the mySewnet Embroidery Software programs that enables you to create original, truly unique designs.



RIBBON EMBROIDERY ATTACHMENT

920600096

DESIGNER EPIC™, DESIGNER EPIC™ 2,
DESIGNER RUBY™ 90, DESIGNER EPIC™ 3.

A true innovation in the home embroidery machine. With the optional ribbon embroidery attachment your embroidery machine will guide and stitch down ribbon in embroidery mode. Adding ribbon to your embroidery designs has never been easier!

- 360° Rotation
- Holds up to 26 feet (8m) of ribbon
- Easily adjusted to work with different ribbon widths.





DESIGNER™ EMBELLISHMENT ATTACHMENT

920594096



DESIGNER EPIC™ 3, DESIGNER EPIC™ 2

The DESIGNER™ Embellishment Attachment takes the ribbon embroidery attachment to the next level. Not only will this device create wonderful ribbon embroideries, it will also couch beads and yarn to create designs never seen before in the home embroidery market.

- Easily add beads, ribbon, yarn & cord to your embroidery projects.
- The new spool design makes it easier to wind and load ribbon, beads and yarn into the attachment.
- Additional spools are available (920738096).
- Threader included for use when using the yarn/bead base. A replacement threader is also available (920739096).



FELTING EMBROIDERY SET

920402096

⑧

DESIGNER BRILLIANCE™ series, DESIGNER DIAMOND™ series, DESIGNER SAPPHIRE™ 85, DESIGNER RUBY™ series, DESIGNER TOPAZ™ series.

920617096

⑨

With the HUSQVARNA® VIKING® Felting Embroidery Set, you can create the most amazing felted embroideries. The effect is created when embroidering without threads but with a special needle that felts fibers together. The effect of the embellishment can be changed dramatically by using different types of fabric/wool.

Contents:

- A. Felting Foot
- B. Felting Bobbin
- C. Felting Needle Plate Cover
- D. Felting Needles (x5)
- E. Screw

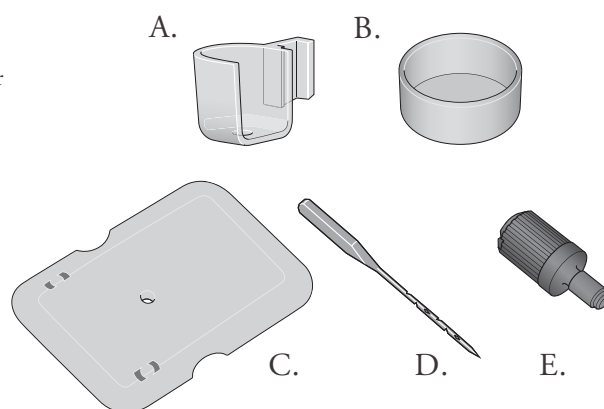

FABRICS

Just about any fabric can be felted with the Felting Embroidery Set, however, some fabrics tend to give a more favorable result when embellished or laundered.

The recommended fabrics are those that are made from natural fibers, such as wool and wool roving. The best characteristic for fabrics is a napped or textured surface.

A napped surface will adhere to a natural fiber/napped surface/or mixed fiber base.

Avoid synthetics with “wash and wear” type of weaves and finishes that have a smooth surface.

The effect differs from fabric to fabric. Always test on a piece of material before you start.

HOOPING

When embroidering with the felting needles, no threads are used. The fabric is hooped with the right side facing down.

When embroidering free-standing designs or when using wool roving, a water soluble stabilizer is needed.





FELTING TECHNIQUES

Three designs are available for download from "www.husqvarnaviking.com". Each design represents a felting technique, Free Standing, One-Layer and Multi-layer embroidery. These techniques are shown below.

To download the designs, go to www.husqvarnaviking.com

Find the Felting Embroidery Set. Click on the link to download the designs.

1. Free Standing Embroidery

2. One-Layer Embroidery

3. Multi-Layer Embroidery

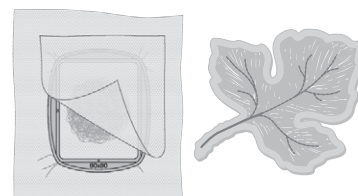

1. Free Standing Embroidery

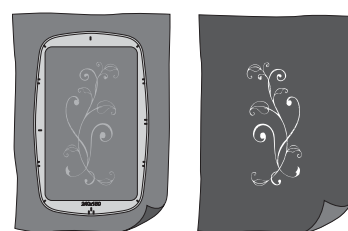

2. One-Layer Embroidery

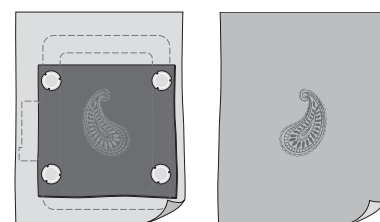

3. Mult-Layer Embroidery





LARGE METAL HOOP 240x150MM

920438096

Not for

TOPAZ™ 40, 30, 25, 20.

MEDIUM METAL HOOP 180 x 130MM

920362096

SMALL METAL HOOP 100 x 100MM

920439096

⑧ ⑨

Not for TOPAZ™ 20 or 30.

For DESIGNER DIAMOND™ series, DESIGNER RUBY™ series, DESIGNER BRILLIANCE™ 80, DESIGNER SAPPHIRE™ 85.

Some fabrics are more difficult to hoop than others or should not be hooped at all, since hooping can damage the fabric. Thick and coarse fabrics can be difficult to hoop but also thin and glossy fabrics. Hooping ready-to-wear garments is difficult or impossible due to seams, narrow areas or buttons/rivets. When using the Metal Hoop 180x130mm hooping won't be a problem! When you want to embroider on quilts or other projects where you do not want residuals from stabilizer on the back side, the Metal Hoop 180x130mm is perfect! Embroider without stabilizer. Embroidering several designs after each other or doing endless embroideries is easy, just remove the magnets and move the fabric. Ready to embroider the next design in no time!

QUILTERS METAL HOOP 200 x 200 MM

920597096

⑨

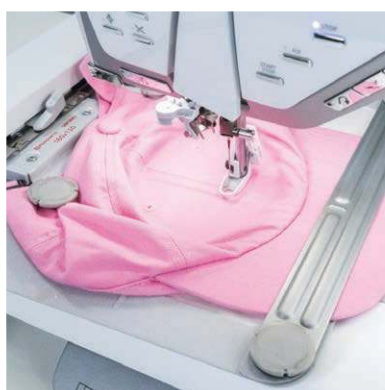

HAT HOOP ACCESSORY

920485096

With this accessory, you can monogram caps, hats and other projects. Simply attach the Hat Hoop Accessory to the 180 x 130 mm Metal Hoop and you can start embroidering letters, logos and other designs from your machine.

Use with Metal Hoop 180 x 130 mm, Part #920362096





SPECIAL TECHNIQUES HOOP

920810096

For
DESIGNER EPIC™ 3

A new innovation in embroidery hoop technology

The special techniques embroidery hoop allows you to embroider on both sides of the fabric without having to remove the project. Easily combine reverse embroidery techniques like felting and bobbin work with traditional embroidery to create one-of-a-kind designs.

- 240 x 150mm (9" x 6") embroidery area.
- Easily flip the hoop over to embroider on both sides of the fabric.
- Clear markings on the hoop showing the embroidery area.

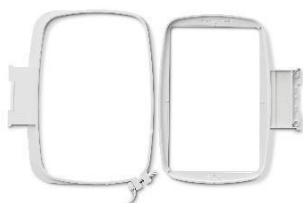

FREE ARM EMBROIDERY HOOP

920811096

For
DESIGNER EPIC™ 3.

A new innovation for HUSQVARNA VIKING™

Easily embroidery tubular garments or items with a closed end such as tote bags without having to undo any seams.

- 100 x 150 mm (4" x 6") embroidery area
- New design that allows projects to be positioned around the free arm and under the arm of the embroidery unit.
- Clear markings on the hoop showing the embroidery area.

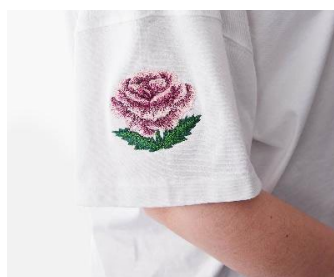



SET OF 4 MAGNETS

620132696

For
METAL HOOP

There is an extra set of four magnets available as an optional accessory. They can be used to fix the fabric more securely to the hoop when not using adhesive stabilizer.

Note: No more than 8 magnets can be used at one time.

CAUTION: MAGNETIC FIELDS CAN BE HARMFUL TO PACEMAKER WEARERS. PACEMAKER WEARERS STAY BACK A MINIMUM 12IN. (30CM).



METAL HOOP FABRIC GUIDE SET

920509096

For
ALL SIZES OF METAL HOOP

These useful guides easily attach onto any of our metal hoops and act as a barrier to keep the rest of your project out of the way while embroidering. Use the guides with the Small Metal Hoop (# 920439096) to easily embroider on small garments as they hold the excess fabric out of the way.



MEGA QUILTERS HOOP

920563096

For
DESIGNER EPIC™, DESIGNER EPIC 2™, DESIGNER RUBY™ 90, DESIGNER EPIC™ 3.

The 260 x 260 mm Mega Quilters Hoop provides a very large square area perfect for stitching embroidery designs within a quilt block. Comes complete with hoop clips for extra stability. Embroidery area is shown on the inner hoop to aid in hooping fabric.

Features:

- 260 x 260 mm embroidery area.
- Similar design to the current 360 x 260 mm embroidery hoop.
- Comes complete with hoop clips for extra stability.
- Embroidery area is shown on the inner hoop to aid in hooping fabric.

HOOPS FROM MINI TO MEGA

A variety of hoop sizes from Mini to Mega are available to stitch beautiful embroideries. Choose the smallest hoop appropriate for the size of the design for best results and easy hooping. The Mini Hoop is perfect to embroider clothing for children and dolls, or select the Mega Turnable Hoop to create one of a kind home dec or fashion embroidery.



MEGA TURNABLE HOOP

920809096

17 5/8" x 17 5/8" (450 x 450 mm)



DESIGNER™ MAJESTIC HOOP

920222096

14 1/6" x 13 3/4" (360 x 350 mm)



DESIGNER™ REGAL HOOP

68024866

18 1/4" x 10 1/4" (456 x 260 mm)



DESIGNER™ IMPERIAL HOOP

68000057

14 1/6" x 10 1/4" (360 x 260 mm)



DESIGNER™ ROYAL HOOP / II

412944501 / 68025075

14 1/4" x 8" (360 x 200 mm)



DESIGNER™ CROWN HOOP

413116501

10 1/4" x 8" (260 x 200 mm)



MEGA QUILTERS HOOP

920563096

10 1/4" x 10 1/4" (260 x 260 mm)



DESIGNER™ JEWEL HOOP/ II

412968501/68025067

9 6/13" x 6" (240 x 150 mm)



200 X 200 QUILTERS HOOP

920264096

8" x 8" (200 x 200 mm)



5" X 7" DESIGN HOOP

920644096

5" x 7" (180 x 130 mm)



DO ALL QUILTER'S HOOP

920115096

6" x 6" (150 x 150 mm)



DESIGNER™ SPLENDID SQUARE HOOP/ II

412968201/ 68023958

9 9/13" x 9 9/13" (120 x 120 mm)



SMALL SQUARE HOOP

920334096

3" x 3" (80 x 80 mm)



SPECIAL TECHNIQUES HOOP

920810096

9 6/13" x 6" (240 x 150 mm)



FREE ARM EMBROIDERY HOOP

920811096

4" x 6" (100 x 150mm)



MINI EMBROIDERY SPRING HOOP

412573901

1 7/13" x 1 7/13" (40 x 40 mm)



MEGA ENDLESS HOOP

920310096

7" x 4" (180 x 100 mm)



ENDLESS EMBROIDERY HOOP II

920310096

7" x 4" (180 x 100 mm)



200 X 200 QUILTER'S METAL HOOP

920597096

8" x 8" (200 x 200 mm)



LARGE METAL HOOP

920438096

9 6/13" x 6" (240 X 150 mm)



SMALL METAL HOOP

920439096

4" x 4" (100 x 100 mm)



METAL HOOP

920362096

7" x 5" (180 x 130 mm)



DESIGNER™ EPIC 3



DESIGNER EPIC 2™
DESIGNER EPIC™
DESIGNER RUBY™ 90

MAX. EMBROIDERY AREA		450 X 450 mm	360 x 350 mm
EMBROIDERY HOOPS	HOOP SIZE		
920809096 MEGA TURNABLE HOOP	17 5/8" x 17 5/8" (450 x 450 mm)	X	
920222096 DESIGNER™ MAJESTIC HOOP	14 1/6" x 13 3/4" (360 x 350 mm)		X
68024866 DESIGNER™ REGAL HOOP	18 1/4" x 10 1/4" (456 x 260 mm)	X	
68000057 DESIGNER™ IMPERIAL HOOP	14 1/6" x 10 1/4" (360 x 260 mm)		X
412944501 / 68025075 DESIGNER™ ROYAL HOOP / II	14 1/4" x 8" (360 x 200 mm)	68025075	412944501
413116501 DESIGNER™ CROWN HOOP	10 1/4" x 8" (260 x 200 mm)	WITH ADAPTER	X
920563096 MEGA QUILTERS HOOP	10 1/4" x 10 1/4" (260 x 260 mm)	WITH ADAPTER	X
920307096 MEGA ENDLESS HOOP	10 1/4" x 6" (260 x 150 mm)	WITH ADAPTER	X
920597096 QUILTERS METAL HOOP	8" x 8" (200 x 200 mm)	WITH ADAPTER	X
929264096 QUILTERS HOOP	8" x 8" (200 x 200 mm)	WITH ADAPTER	X
920810096 SPECIAL TECHNIQUES HOOP	9 6/13" x 6" (240 x 150 mm)	X	
920438096 LARGE METAL HOOP	9 6/13" x 6" (240 x 150 mm)	WITH ADAPTER	X
412968501 / 68025067 DESIGNER™ JEWEL HOOP / II	9 6/13" x 6" (240 x 150 mm)	68025067	412944501
920362096 METAL HOOP	7" x 5" (180 x 100 mm)	WITH ADAPTER	X
920644096 5" X 7" DESIGN HOOP	7" x 5" (180 x 130 mm)	WITH ADAPTER	X
920310096 ENDLESS EMBROIDERY HOOP II	7" x 4" (180 x 100 mm)	WITH ADAPTER	X
920115096 DO ALL QUILTERS HOOP	6" x 6" (150 x 150 mm)	WITH ADAPTER	X
412968201 / 68023958 DESIGNER™ Splendid Square Hoop II	9 9/13" x 9 9/13" (120 x 120 mm)	68023958	412944501
920811096 FREE ARM EMBROIDERY HOOP	4" x 6" (100 x 150mm)	X	
920439096 SMALL METAL HOOP	4" x 4" (100 x 100 mm)	WITH ADAPTER	X
412527401 STANDARD HOOP	4" x 4" (100 x 100 mm)		X
920334096 SMALL SQUARE HOOP	3" x 3" (80 x 80 mm)	WITH ADAPTER	X
412573901 MINI EMBROIDERY SPRING HOOP	1 7/13" x 1 7/13" (40 x 40 mm)	WITH ADAPTER	X



DESIGNER DIAMOND *Royal*™
DESIGNER DIAMOND *deLuxe*™
DESIGNER DIAMOND™
DESIGNER BRILLIANCE™ 80
DESIGNER SAPPHIRE™ 85



DESIGNER RUBY *Royal*™
DESIGNER RUBY *deLuxe*™
DESIGNER RUBY™
DESIGNER TOPAZ™ 50, 30



DESIGNER TOPAZ™ 20



DESIGNER TOPAZ™ 40, 25



DESIGNER JADE™ 35

360 x 350 mm	360 x 200 mm	260 x 200 mm	240 x 150 mm	240 x 150 mm
X				
412944501	412944501			
X	X	X		
X	X	X		
X	X	X		
X	X (excludes TOPAZ™ 30)			
412944501	412944501	412944501	412944501	412968501
X	X	X	X	
X	X	X	X	
X	X	X	X	X
X	X	X	X	X
412944501	412944501	412944501	412944501	412968201
X	X (excludes TOPAZ™ 30)		X	X
X	X	X	X	
X	X	X	X	X
X	X	X	X	X



SENSOR Q-FOOT

68017593

⑧ ⑨

413192045

⑦

The Sensor Q-Foot is used for embroidery and free-motion sewing, quilting and embroidery on especially thick or spongy fabrics. Put on the Sensor Q-Foot for free-motion Quilting with puffy battings, free-motion and built-in embroidery on fabric with batting, thick terrycloth towels, and when there is a build up of embroidery thread or couched decorative threads.

For SAPPHIRE™ series, select Free Motion Spring Action on the Set Menu. For DESIGNER™ series, select Sensor Q-Foot on the Set Menu.

1. Remove the ankle and put on the Sensor Q-Foot.
2. Bring the bobbin thread to the top by taking one stitch.
3. Lower the presser foot.
4. Sew, moving the fabric as desired to quilt the fabric, or create a free motion design. Move the fabric in a smooth motion, moving the fabric faster as the speed of the machine is increased. You are creating the length of the stitch as you move the fabric.



SNAP ON CLEAR EMBROIDERY FOOT R

412849801

① ⑦ ⑧ ⑨

Not for

1200, 1100, 1090, 1070, 1070S, 1050.

The Snap on Clear Embroidery Foot R is used for free-motion embroidery, decorative sewing and embroidery. The foot allows greater visibility for both embroidery and free-motion sewing.





EMBROIDERY CUTWORK NEEDLE KIT

920268096

① ⑥ ⑦ ⑧ ⑨

For

Embroidery machines

With HUSQVARNA®VIKING® Embroidery Cutwork Needle Kit set you can easily create cutwork embroidery. This kit will help you get started!

Contents: Cutwork Needles, Multipurpose tool/ Button reed, CD with instruction video, embroidery designs, more tips and inspiration to get you started!





ADDITIONAL ACCESSORIES

HUSQVARNA® VIKING® has developed a number of special accessories to make your sewing easier. Special stitch plates, bobbins, and “sew” much more mean time saving sewing with professional results.



MULTI FUNCTION FOOT CONTROL

920561096

⑧ ⑨

DESIGNER SAPPHIRE™ 85, DESIGNER BRILLIANCE™ 80

Control multiple functions of your machine like thread cut, tie off or reverse without taking your hands off your project.

3 customizable function switches

- 2 side levers
- 1 heel touch button

Five programmable sewing machine functions include:

- Presser foot lift
- Scissors
- Reverse
- Tie off
- Pattern begin / restart

Separate needle up / down function

Extra long 8 foot (2.5m) USB cable to suit various sewing positions

Ergonomic Design

Rubberized base for stability



CLEARANCE PLATE

413105601

① ② ③ ④ ⑤ ⑥ ⑦ ⑧ ⑨

The Clearance Plate creates a thread shank when sewing buttons in place. Each end is a different thickness for more or less thread shank. It also can be used when sewing over heavy seams to balance the height of the foot.

1. Place the Clearance Plate between button and fabric.
2. Follow instructions for button sewing and stitch button in place.

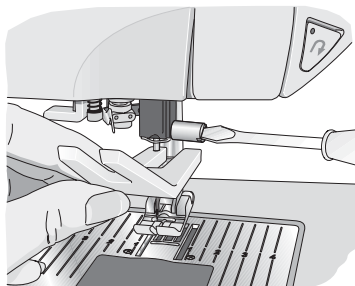



SAFETY NEEDLE GUARD

413137545

⑤ ⑥ ⑦

--	--

Not for

EMERALD™ series, EDEN ROSE™ 250M, TRIBUTE™ 140M, 145M, ONYX™ series.

The Safety Needle Guard is a safety feature used during sewing. The metal guard is attached to the presser foot bar so that any unintentional touching of the needle during sewing is prevented.



EIGHT SPOOL THREAD RACK

920505096

--	--

⑦ ⑧ ⑨ *

For *DESIGNER EPIC™ 3 use with 920827096

Snaps onto top of machine and features pins for up to eight spools of thread. Thread pins are numbered for embroidery color changes.



EIGHT SPOOL THREAD RACK HOLDERS

920515096

--	--

⑧ ⑨

Not for DESIGNER EPIC™ 3

920827096

DESIGNER EPIC™ 3

Already own the HUSQVARNA® VIKING® Eight Spool Thread Rack and have just bought a DESIGNER EPIC™ then no problem. These holders will allow you to attach the eight spool thread rack to the back of the machine.



WATERCOLORED BOBBINS 20 PACK

413198445

--	--

⑤ ⑥ ⑦

Not for EMERALD™ series, EDEN ROSE™ 250M, TRIBUTE™ 140M, 145M, JADE™ 35, 20.

4 different color bobbins to help you organize your specialty thread types.



WATERCOLORED BOBBINS 20 PACK, VERSION 2

920364096

--	--

⑤ ⑥ ⑦

Not for EMERALD™ series, EDEN ROSE™ 250M, TRIBUTE™ 140M, 145M, JADE™ 35, 20.

4 different color bobbins to help you organize your specialty thread types.



BLUE BOBBINS 8 PACK

920434096

⑧ ⑨

8 blue color bobbins to help you organize your specialty thread types.



BOBBINS 10 PACK

412061245

② ③ ④ Old style

412097545

① New style

413182545

⑤ ⑥ ⑦ Green

Not for

EMERALD™ series, EDEN ROSE™ 250M, TRIBUTE™ 140M, 145M, JADE™ 35, 20.



BOBBIN PLASTIC 15 CLASS

68001389

for

EMERALD™ 122, 118, 116, 203, TRIBUTE™ 140M 145M, EDEN ROSE™ 250M, DESIGNER JADE™ 35 and JADE™ 20.

68000175

for

EMERALD™ 203, 183 AND H-CLASS™ 100Q, ONYX™ series.



PRE-WOUND BOBBINS

140000746

⑦ PLATINUM™ MN 1000

White; box of 144.

68008984

⑦ PLATINUM™ MN 1000

Black; box of 144.

920535096

⑧ ⑨

White; pack of 10.

920536096

⑧ ⑨

Black; pack of 10.

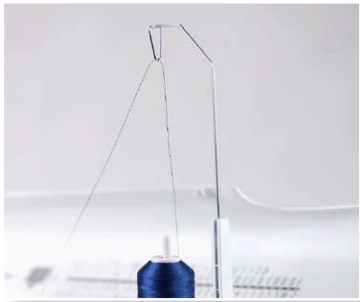

MEGA SPOOL STAND

413108301

① ② ③ ④

And for

DESIGNER DIAMOND™ series, BRILLIANCE™ series, DESIGNER RUBY™ series, DESIGNER TOPAZ™ series, SAPPHIRE™ series, DESIGNER SAPPHIRE™ 85, ONYX™ series.



THREAD NET

412397701

① ② ③ ④ ⑤ ⑥ ⑦ ⑧



ACCESSORY ANKLE

412616145

⑤ ⑥ ⑦ ⑧

Not for

EMERALD™ series,
EDEN ROSE™ 250M,
TRIBUTE™ 140M.

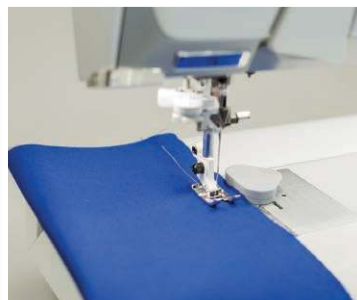

MAGNETIC SEAM GUIDE

920506096

⑧ ⑨

DESIGNER DIAMOND™ series,
DESIGNER RUBY™ series,
DESIGNER TOPAZ™ series,
SAPPHIRE™ series, BRILLIANCE™ series,
DESIGNER SAPPHIRE™ 85,
ONYX™ series.

This easy to use seam guide simply snaps onto the needle plate on either side of the presser foot to give you accurate seam allowances and straight lines. Use the markings on the needle plate as a guide to help position the magnetic seam guide.



MAGNIFYING LENS SET

920595096

⑧ ⑨

The Magnifying Lens Set easily attaches to your sewing machine and magnifies the sewing area in front of the needle. This gives much greater visibility when threading twin needles and when doing detailed sewing.

- The magnetic lens holder makes it is easy to attach, remove or adjust the magnifying lens without requiring any tools.
- Three lenses of different strengths are included to give perfect magnification to enhance the view around the presser foot and needle.
- Easily swing the magnifying lens out of the way when changing the needle or presser foot without having to physically remove the attachment.



STANDARD ZIGZAG PLATE
WITH INCH MARKINGS

412964207

For

DESIGNER DIAMOND™ series,
DESIGNER RUBY™ series, DESIGNER
TOPAZ™ series, SAPPHIRE™ series, OPAL™
series, BRILLIANCE™ series, EDEN ROSE™
250C, TRIBUTE™ 140C.



STRAIGHT STITCH PLATE
WITH INCH MARKINGS

68003153

For

DESIGNER DIAMOND™ series, DESIGNER
RUBY™ series, DESIGNER TOPAZ™ series,
SAPPHIRE™ series, OPAL™ series,
BRILLIANCE™ series, EDEN ROSE™ 250C,
TRIBUTE™ 140C.

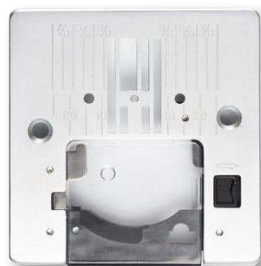

STRAIGHT STITCH PLATE
WITH INCH MARKINGS

413339345

for

H CLASS™ 100Q





OVERLOCK SEWING AND EMBELLISHING



HUSKYLOCK™ s25

Top of the line overlock with SEWING ADVISOR™ feature has 25 stitches including 5, 4, 3, 2 thread sewing, 5-thread Safety stitch, coverstitch and chainstitch, Automatic Differential Feed and more. The HUSKYLOCK™ s25 machine also has a large sewing space, large Graphic Touch Display, info system, dual LED lights and a threading guide. An extension table is also included.



HUSKYLOCK™ s21

4, 3, 2 thread overlock with 21 stitches including coverstitch and chainstitch. The HUSKYLOCK™ s21 machine has pre-programmed stitch settings, a tension release and a threading guide. An extension table is also included.



HUSKYLOCK™ s15

4, 3, 2 thread overlock with 15 stitches, differential feed, threading guide, free arm and adjustable stitch length, cutting width and presser foot pressure.



AMBER™ S|100

4, 3, 2 thread capability with 16 different stitches to help you complete any project. Both the left and right front covers open to provide complete access to the looper area, making it super easy to thread. The Differential Feed gives you perfectly even seams - no stretching or distortion on knits or puckering of finer fabrics, and it can also be used for gathering.



AMBER™ AIR S|400

One-Touch Air threading overlock with air threading loopers, built-in needle threader, differential feed, adjustable stitch length, cutting width and presser foot pressure, and 4, 3, 2 thread sewing.



AMBER™ AIR S|600

Explore more projects effortlessly with the AMBER™ Air S|600 coverlock machine. Its innovative technology can lead you anywhere with top features including One-Touch Electronic Air-Threading Loopers, Color Touch Screen, Exclusive SEWING ADVISOR™, LED Lighting, and more!

An overlock machine makes your sewing room complete. Your HUSQVARNA® VIKING® HUSKYLOCK™ machine will sew the seam, trim excess fabric and overcast the edges in one sewing step with speed and precision. There is also plenty of opportunity for creative and decorative overlock techniques. There are many HUSKYLOCK™ accessories for even more special sewing techniques. Add a little extra flair with the pearl foot, gathering foot or piping foot.



CORDED WAVY EDGE FOOT

920797096



For

HUSKYLOCK™ s21 and s25, and AMBER™ AIR s|600.

Sewing a decorative wavy edge is easy with the Corded Wavy Edge foot. The curvy, softly ruffled edge is a perfect finish for bridal veils, figure skating costumes, ballet skirts, crafts and more.

Note: For best results, use fabric with stretch. For fabric with no stretch, cut on the bias.

1. Set the machine for a 3-thread rolled edge.
2. Snap on the Corded Wavy Edge foot.
3. Insert a 0.3mm nylon fishing line (or similar) into the opening in the foot. The fishing line will be covered by the rolled edge.
4. Start to sew slowly. Make sure the fishing line is hidden in the rolled edge as you sew.

Tip: * 40 wt. rayon embroidery threads in a contrasting color in the upper and lower loopers will give a shiny colorful edge.

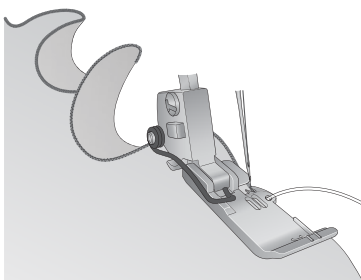



YARN APPLICATION FOOT

620117396



While stocks last

For

HUSKYLOCK™ s15 machine.

This foot is used for sewing yarns (cords, nylon gut) up to a thickness of 1.0 mm. This produces an undulating or stiffer hem (e.g. on wedding dresses and valance).

Preparing the machine

- Needle: Right needle
- Stitch type: Two thread lower looper thread wrapped rolled hem or three thread upper looper thread wrapped rolled hem
- Stitch length: 2 mm
- Differential feed lever: Normal position
- Upper knife: Working position

Sewing

1. Place the fabric under the presser foot.
2. Thread cord (or nylon gut) through slot (A) and under finger (B) of the presser foot.
3. Test sew on a piece of fabric before starting to sew.

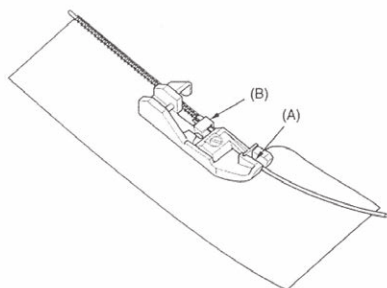

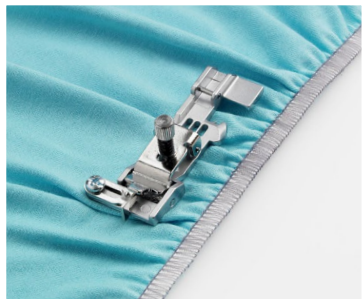

Note: To adjust the stretch of the elastic:

- Turn the tension screw to the right for more stretch.
- Turn the screw to the left for less stretch.
- Be careful not to stretch the fabric while sewing.

ELASTIC FOOT

920791096



For

HUSKYLOCK™ s21 and s25 machines and AMBER™ AIR S|600.

The Elastic Foot guides and stretches narrow elastic (1/4-1/2", 6-12 mm) as you sew it to fabric. It is great for sewing for active wear, lingerie and other elastic insertion techniques.

1. Set the overlock machine for the desired stitch.
2. Loosen the screw at the front of the Elastic Foot to release the tension on the roller. Insert the elastic into the foot.
3. Snap on the foot and pull the elastic until it reaches behind the foot.
4. Tighten the tension screw to stretch the elastic.
5. Turn the handwheel to sew the first few stitches to secure the elastic.
6. Place the fabric under the foot and sew both the elastic and the fabric together.
7. Check the stitch and adjust the tension if necessary.



ELASTIC FOOT

620116796



While stocks last

For

HUSKYLOCK™ s15 machine.

This foot is used for attaching elastic tape to the garment and the amount of contraction of the elastic tape can be adjusted as required. This foot can also be used for attaching tape to prevent stretching.

Preparing the machine

- Needle: Left or right, or both left and right
- Stitch type: Three-thread overlock or four-thread ultra stretch mock safety stitch
- Stich length: 3-5 mm
- Differential feed lever: Normal position
- Upper knife: Working or non-working position

Sewing

1. Before attaching the sewing foot to machine, pass the elastic tape through presser foot and adjust stretch with adjusting screw (A).
2. Attach presser foot to machine.
3. Sew 2 - 3 stitches while pulling the elastic tape lightly to the rear of machine.
4. Continue to sew the elastic tape onto the fabric while lightly pulling the end of elastic tape.

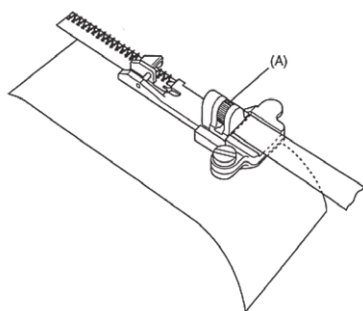

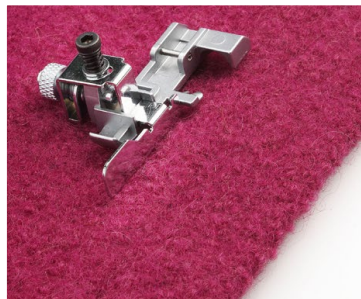

BLINDHEM & LACE FOOT

920796096

For

HUSKYLOCK™ s21 and s25 machines and AMBER™ AIR s|600.

The Blindhem Foot is perfect for sewing invisible hems and for applying lace. The hem is sewn, overcast and trimmed in one step.

Blind hem:

1. Set the overlock machine for the desired stitch.
2. Snap on the Blindhem Foot.
3. Fold and press the hem in place. Turn the hem back on itself toward the right side of the fabric. Leave ¼" (6mm) of the edge exposed.
4. Place the hem under the foot with the fold against the guide on the foot.
5. Loosen the guide screw to adjust the guide so that the needle just catches the thread of the fold.
6. Guide the fabric as you sew, making sure the fold of the fabric is always against the guide.
7. Open the fabric and press lightly on the wrong side.
8. Test on a scrap piece of fabric before sewing your project.

Lace:

1. Set the overlock machine for the desired stitch
2. Snap on the Blindhem Foot.
3. Place the wrong side of the lace to the right side of the fabric.
4. Place under the foot with the fabric extending to the right of the guide. The header of the lace will be against the left side of the guide.
5. Loosen the guide screw to adjust the guide so the needle just catches the header of the lace.
6. Guide the fabric as you sew, making sure the header of the lace is always against the guide.
7. When finished, open the lace flat. Fold the seam allowance to the back of the fabric and press.
8. If using insertion lace, repeat on the other side of the lace.



BLIND HEM FOOT

620117096

While stocks last

For

HUSKYLOCK™ s15 machine.

This foot is for sewing cuffs on knit fabrics, and hemming where seam should not be visible.

Preparing the machine

- Needle: Right needle
- Stitch type: Three-thread overlock or three-thread flatlock
- Stitch length: 4-5mm
- Differential feed lever: Normal position
- Upper knife: Working position

Sewing

1. Fold fabric as shown and place it under the presser foot.
2. Loosen screw (A) and adjust edge guide so that needle will penetrate the fabric close to the folded edge.
3. Guide fabric lightly while sewing so that needle will just catch the edge of fold.

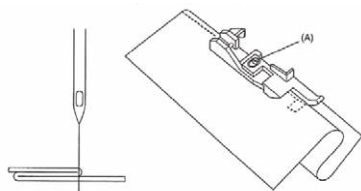

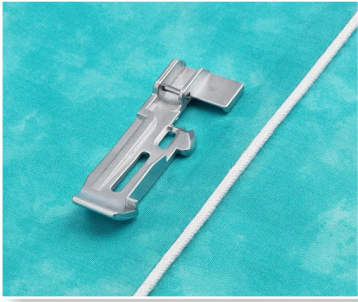

PIPING FOOT

920792096



For

HUSKYLOCK™ s21 and s25 machines and AMBER™ AIR s|600.

The Piping Foot is perfect for inserting packaged piping into seams and on edges for a tailored finish. The trim is sewn between the two layers of fabric in one step. A groove under the foot helps guide the piping. You can also create your own piping for a custom finish. The Piping Foot makes it fast and easy to cover cording with fabric and to insert piping into seams for a professional look!

1. Set the overlock machine for the desired stitch.
2. Snap on the Piping Foot..

To stitch piping into a seam:

3. Place the piping along the seam line on right side of fabric. Place second piece of fabric on top with right sides together.
4. Put fabric and piping layers under the Piping Foot with the piping in the groove on the underside of the foot.
5. Sew piping into the seam.
6. The groove on the underside of the foot will guide the piping as you sew.

To make piping from your fabric:

7. Cut bias or crosswise grain strips wide enough to cover the cord plus the seam allowances.
8. Lay the cord on the wrong side of the fabric strip and fold the fabric over the cord.
9. Place the fabric and cord under the Piping Foot with the cord in the groove on the underside of the foot.
10. Sew. The groove will guide the cord as you sew.



PIPING FOOT

620116996

--	--

For

HUSKYLOCK™ s15 machine.

This presser foot is suited for sewing welting between two layers of fabric.

Preparing the machine

- Needle: Left or both left and right
- Stitch type: Three-thread overlock or four-thread overlock
- Stitch type: 2-5mm
- Differential feed lever: Normal position
- Upper knife: Working position

Sewing

1. Place fabric with right sides facing.
2. Place cording (piping) in between upper and lower fabrics and insert fabrics under cording foot with cording positioned in groove under foot.
3. Sew while guiding both cording (piping) and fabric.

Note: Cording (piping) using bias tape and cord can also be done with this foot.

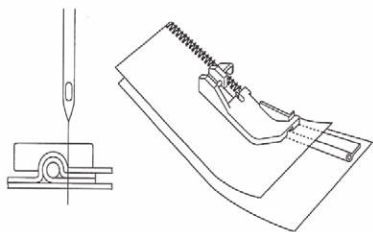

BEADING FOOT

920795096

--	--

For

HUSKYLOCK™ s21 and s25 machine and AMBER™ AIR s|600.

The Beading Foot smoothly guides beads and pearls through a channel on the foot for easy application on garments or crafts.

1. Set the overlock machine for the desired stitch.
2. Pull the bead string through the channel on the underside of the foot.
3. Snap the Beading Foot onto the machine.
4. Turn the handwheel to sew the first two stitches to keep the beads in place.
5. Sew pearls onto the edge of fabric, cutting just a little bit of fabric as you sew. Or sew along the fold without cutting.

Note: The needle should penetrate about $\frac{5}{8}$ " (1.5mm) from the fabric edge.

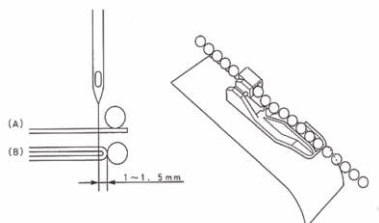

BEADING FOOT

620117196

--	--

While stocks last

For

HUSKYLOCK™ s15 machine.

This foot is used for sewing on beads, spangles, etc.

Preparing the machine

- Needle: Left or right (left is preferable.)
- Stitch type: Three-thread overlock or wrapped edge overlock
- Stitch length: 3-5mm
- Differential feed lever: Normal position
- Upper knife: Working or non-working position

Sewing

1. Select sewing method (A) or (B), then determine needle position and sew 2 or 3 stitches.
2. Turn hand wheel with hand until needle point is level with fabric surface on its upward stroke. Then insert the end of string of beads into guide on presser foot.
3. Sew 2 - 3 stitches by turning hand wheel with hand.
4. Press beads lightly with left finger while sewing.
5. Sew the last few stitches by turning hand wheel with hand to avoid beads interfering with needle and loopers.

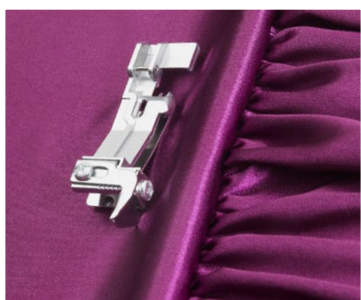

GATHERING FOOT

920793096

--	--

For

HUSKYLOCK™ s21 and s25 machines and AMBER™ AIR s|600.

The Gathering Foot is perfect for gathering a single layer of fabric or simultaneously gathering and stitching two layers of fabric. (The bottom fabric layer will be gathered and the top layer remains flat.) Suitable for light and medium weight woven fabrics.

1. Set the overlock machine for the desired stitch.
2. Snap on the Gathering Foot.
3. Insert the bottom fabric layer (fabric to be gathered) between the needle plate and the Gathering Foot all the way up to the cutter, with right side up.
4. Insert the top fabric layer in the opening of the Gathering Foot and even with the bottom layer right side down.
5. Lower the presser foot and sew. Guide the fabric against the fabric guide, letting the bottom layer feed freely to gather.

Tip:

To increase the fullness of the gathering:

- Increase the needle thread tension
- Set the differential feed to a higher number
- Adjust the stitch length to a higher number

A single layer of fabric may also be gathered by placing it under foot and adjusting stitch length, differential feed and needle thread tension to desired fullness.

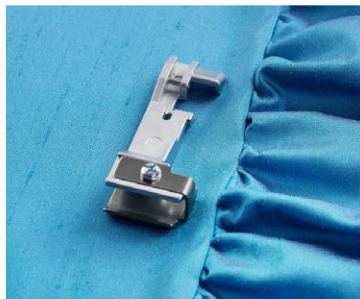

GATHERING FOOT

620116896

While stocks last

For

HUSKYLOCK™ s15 machine.

This foot is most suited for gathering when sewing tiered skirts, yokes, cuffs and frills on skirts, etc. This foot is also suited for sewing two fabrics together and gathering the bottom fabric in one operation.

Preparing the machine

- Needle: Left or right, or both left and right
- Stitch type: Three-thread overlock or four-thread overlock
- Stitch length: 3-5 mm
- Differential feed lever: Gathering position
- Upper knife: Working position

Sewing

1. Place two layers of fabric on machine with separator plate (A) in between the upper and lower fabrics.
2. Sew 2-3 stitches.
3. Hold and lightly guide upper and lower fabrics separately while sewing.

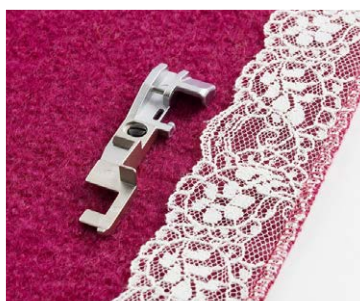
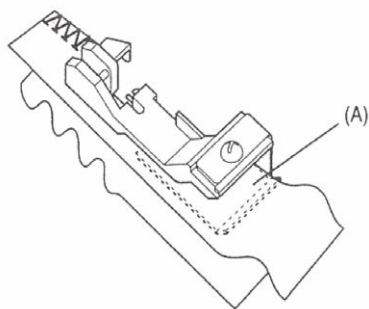

LACE FOOT

620117296

While stocks last

For

HUSKYLOCK™ s15 machine.

This foot is used for sewing lace or borders together or onto the project.

Preparing the machine

- Needle: Right needle
- Stitch type: Three-thread overlock or three-thread standard rolled hem
- Stitch length: 1.5 - 3 mm
- Differential feed lever: Normal position
- Upper knife: Working or non-working position

Sewing

1. Place the fabric under guide finger (A) and lace on top of guide finger (A).
2. If necessary, loosen screw (C) and slide guide plate (B) to the left or right to adjust stitch width.
3. Tighten screw (C).
4. Guide lace along guide plate (B) and sew.

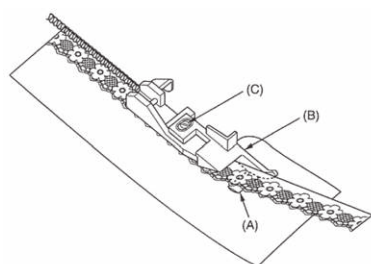

Note: If there is no necessity to cut the fabric edge, place both fabric and lace on top of guide finger (A). Be sure to disengage the upper knife.

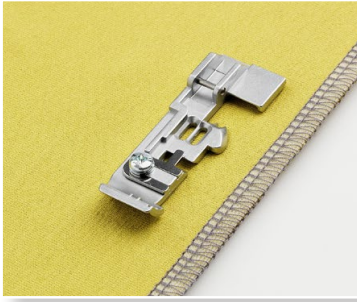

TAPING FOOT

920794096

For

HUSKYLOCK™ s21 and s25 machines and AMBER™ AIR s|600.

The Taping Foot is used to apply seam tapes to seams to prevent stretching. It is especially good for stabilizing shoulder seams. With this foot you can reinforce and construct seams in one step.

1. Set the overlock machine for the 4-thread overlock.
2. Place the seam tape in the guides on the foot.
3. Adjust the screw to fit the width of the tape.
4. Snap the taping foot onto the machine.
5. Sew the seam.

Note: Works best with ¼" (8mm) seam tape.

OVERLOCK FEET KIT

920592096

For

HUSKYLOCK™ s21, s25 and AMBER™ AIR s|600

Includes GATHERING FOOT, ELASTIC FOOT, BLIND HEM FOOT, PIPING FOOT, AND TAPING FOOT.

1. Gather fabric with ease using the Gathering Foot.
2. Add elastic to garments and control the amount of contraction with the Elastic Foot.
3. Sew invisible hems or apply lace with the Blind Hem and Lace Foot.
4. Create and insert piping into home dec projects effortlessly with the Piping Foot.
5. Stabilize and prevent seams stretching with the Taping Foot.

AMBER™ AIR s|400 EMBELISHMENT FEET KIT 111

920574096

For

AMBER™ AIR s|400 machine.

This kit contains 6 accessories, perfect for embellishment, garment sewing, home furnishings and more.

It Includes

- Cording Foot (Type A) For yarn or nylon cord, to secure edges, hems, or create decorative wavy edges
- Cording Foot 9 (Type B) To add cord or seam tape to prevent stretching
- 1/8" Piping Foot For sewing packaged piping into seams and onto edges for a tailored finish
- 3/16" Piping Foot
- Beading Foot & Guide Easily attach strings of beads or pearls to garments



AMBER™ AIR s|400 UTILITY FEET KIT

920573096

For

AMBER™ AIR s|400 machine.

This kit contains 5 accessories, perfect for utility sewing.

It Includes

- Gathering Attachment Perfect for gathering one layer of fabric on to another
- Blind Hem Foot Creates an invisible hem, trims and overcasts in one step
- Gathering Foot Creates gathers in light to medium weight fabrics
- Elastic Gathering Attachment Stretches and sews narrow elastic in place on to the edge of the fabric. Great for active wear, lingerie and other projects
- Cloth Guide For keeping seams straight while sewing and to flatlock seams when knife is lowered







GATHERING FOOT

413306145

For

AMBER™ s|100

The Gathering Foot is perfect for gathering a single layer of fabric or simultaneously gathering and stitching two layers of fabric. (The bottom fabric layer will be gathered and the top layer remains flat.) Suitable for light and medium weight woven fabrics.

1. Set the overlock machine for the desired stitch.
2. Snap on the Gathering Foot.
3. Insert the bottom fabric layer (fabric to be gathered) between the needle plate and the Gathering Foot all the way up to the cutter, with right side up.
4. Insert the top fabric layer in the opening of the Gathering Foot and even with the bottom layer right side down.
5. Lower the presser foot and sew. Guide the fabric against the fabric guide, letting the bottom layer feed freely to gather.

Tip: To increase the fullness of the gathering:

- Increase the needle thread tension
- Set the differential feed to a higher number
- Adjust the stitch length to a higher number

A single layer of fabric may also be gathered by placing it under foot and adjusting stitch length, differential feed and needle thread tension to desired fullness.



PEARL FOOT

413306245

For

AMBER™ s|100

The beading foot smoothly guides beads and pearls through a channel on the foot for easy application on garments or craft projects

1. Set the overlock machine for the desired stitch.
2. Pull the bead string through the channel on the underside of the foot.
3. Snap the Pearl Foot onto the machine.
4. Turn the handwheel to sew the first two stitches to keep the beads in place.
5. Sew pearls onto the edge of fabric, cutting just a little bit of fabric as you sew. Or sew along the fold without cutting.

Note: The needle should penetrate about 5/8" (1.5mm) from the fabric edge.



BLIND HEM FOOT

413305945

For

AMBER™ s|100

The blind hem foot is perfect for sewing invisible hems. The hem is sewn, overcast and trimmed in one easy step.

1. Set the overlock machine for the desired stitch.
2. Snap on the Blind hem Foot.
3. Fold and press the hem in place. Turn the hem back on itself toward the right side of the fabric. Leave ¼" (6mm) of the edge exposed.
4. Place the hem under the foot with the fold against the foot's guide.
5. Loosen the guide screw to adjust the guide so that the needle just catches the thread of the fold.
6. Guide the fabric as you sew, making sure the fold of the fabric is always against the guide.
7. Open the fabric and press lightly on the wrong side.
8. Test on a scrap piece of fabric before sewing your project.



ELASTIC FOOT

413306045

For

AMBER™ s|100

The elastic foot guides and stretches narrow elastic as you sew it to fabric. It is great for sewing activewear, lingerie and other elastic insertion techniques.

1. Set the overlock machine for the desired stitch.
2. Loosen the screw at the front of the Elastic Foot to release the tension on the roller. Insert the elastic into the foot.
3. Snap on the foot and pull the elastic until it reaches behind the foot.
4. Tighten the tension screw to stretch the elastic.
5. Turn the handwheel to sew the first few stitches to secure the elastic.
6. Place the fabric under the foot and sew both the elastic and the fabric together.
7. Check the stitch and adjust the tension if necessary.

Note: To adjust the stretch of the elastic:

- Turn the tension screw to the right for more stretch.
- Turn the screw to the left for less stretch.
- Be careful not to stretch the fabric while sewing.



PIPING FOOT

413305745

For

AMBER™ s|100

The piping foot is perfect for inserting packaged piping into seams and on edges for a tailored finish. The piping foot also makes it fast and easy to cover cording with fabric and insert piping into seams for a professional finish.

1. Set the overlock machine for the desired stitch.
2. Snap on the Piping Foot.

To stitch piping into a seam:

3. Place the piping along the seam line on right side of fabric. Place second piece of fabric on top with right sides together.
4. Put fabric and piping layers under the Piping Foot with the piping in the groove on the underside of the foot.
5. Sew piping into the seam.
6. The groove on the underside of the foot will guide the piping as you sew.

To make piping from your fabric:

1. Cut bias or crosswise grain strips wide enough to cover the cord plus the seam allowances.
2. Lay the cord on the wrong side of the fabric strip and fold the fabric over the cord.
3. Place the fabric and cord under the Piping Foot with the cord in the groove on the underside of the foot.
4. Sew. The groove will guide the cord as you sew.



OVERLOCK SEWING AND COVERSTITCH

The top-of-the-line HUSQVARNA® VIKING® OVERLOCK™ machines features Coverstitch and Chainstitch sewing accessories for the most professional hems, decorative accents and finishing techniques.



COVERSTITCH FEET KIT

920593096

For

HUSKYLOCK™ s21, s25 AND AMBER™ AIR
s|600.

- Increase your visibility while sewing with the Clear Coverstitch Foot.
- Create beautiful decorative edges and effects with the Flat Trim Foot and the Join and Fold Edging Foot.
- Straps and belt loops are effortless to create with the Strap and Belt Loop Foot.
- Add piping, corded tuck and even create wonderful decorative trims with the Piping Foot with Cording Guide.

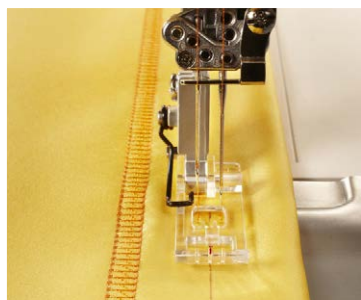

CLEAR COVERSTITCH FOOT

With the Clear Coverstitch foot, you can see your fabric and marked line under the foot as you sew.

1. Set the machine for a Coverstitch or a Chainstitch.
2. With a water soluble marker, draw a line on the fabric to mark the stitching line.
3. Snap on the Clear Coverstitch foot.
4. Use default stitch settings. Adjust if needed.
5. Place the fabric under the presser foot and the needles. Start to sew into the fabric without chaining off first.
6. Use the red center marking on the foot as a guide as you follow a line drawn on the fabric. The Clear Coverstitch foot will give you a great view of the marked line and of your fabric while sewing.

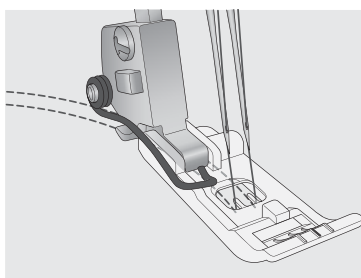



JOIN AND FOLD EDGING FOOT

Use the Join and Fold Edging foot to hem the fabric edge and attach lace at the same time.

1. Set the machine for Coverstitch, wide.
2. Use the default stitch settings. Adjust if needed.
3. Snap on the Join and Fold Edging foot.
4. Slide the raw edge of the fabric right side up, into the fabric guide (illustration 1).
5. Slide the fabric to the back underneath the presser foot and the needles.
6. Insert the lace into the right lace guide and pull a lace tail about 1" (2.5cm) behind the foot (illustration 2). Use tweezers if needed.
7. Lower the presser foot. Hold the fabric in your left hand and the lace in your right hand and start to sew.

Note: Adjust the screw on the guide to adjust the stitch position if needed.

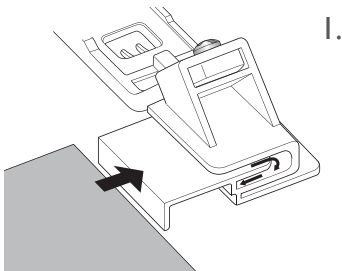

1.

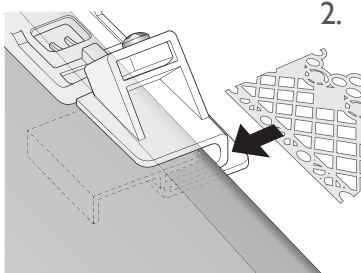

2.

STRAP AND BELT LOOP FOOT

With the Strap and Belt Loop foot, create straps and belt loops easily using a cover stitch. Just put a strip into the foot and the strip is folded automatically and stitched in place.

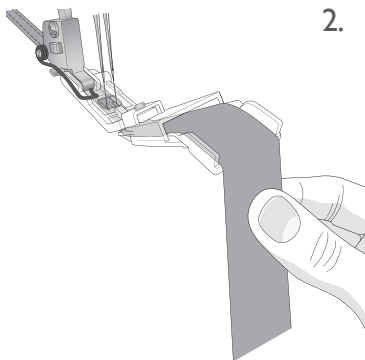
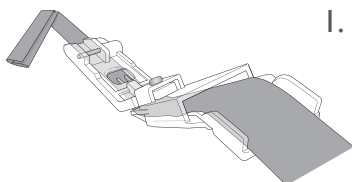

1. Set the machine for a Coverstitch wide.
2. Use the default stitch settings. Adjust if needed.
3. Cut a strip of fabric, 1" (25mm) wide.
4. Cut the top corner of the strip at a 45 degree angle to form a point.
5. Insert the cut angle into the guide, right side of the fabric facing up. Pull the strip through the slot and under the foot. Extend the tail of the strip behind the foot (Illustration 1). Use a tweezers to feed the strip into the foot if needed.
6. Snap the Strap and Belt Loop foot onto the machine.
7. Slide the strip approximately 2" (5cm) behind the foot.
8. Lower the presser foot. Be sure both raw edges of strip are turned under before stitching. Sew the first few stitches. Stop and clip the needle threads close to the presser foot and continue sewing.
9. For even feeding, hold the fabric strip slightly below the first guide in the front of the foot (Illustration 2).
10. Sew at medium speed. Check the fabric as you sew to ensure proper feeding.

Note: Sew the folded fabric strip without additional fabric underneath to create straps and belt loops or sew the folded strip onto another fabric for decorative effects.

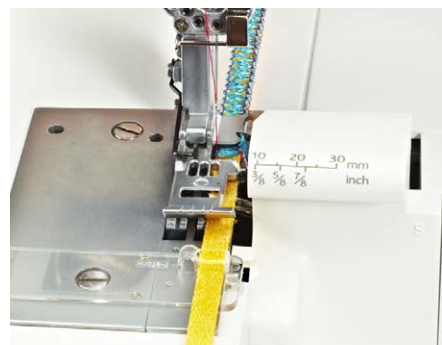
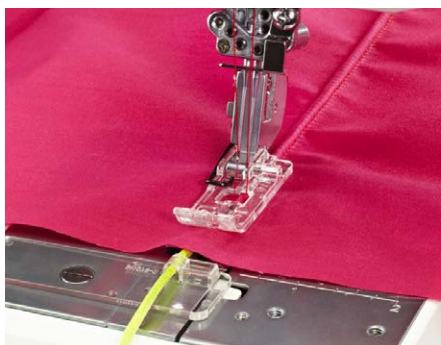

With the Piping foot with Cording guide, you can create piping, corded tucks and decorative trims.



PIPING



CORDED TUCKS



DECORATIVE TRIM

PIPING

Easily create your own piping:

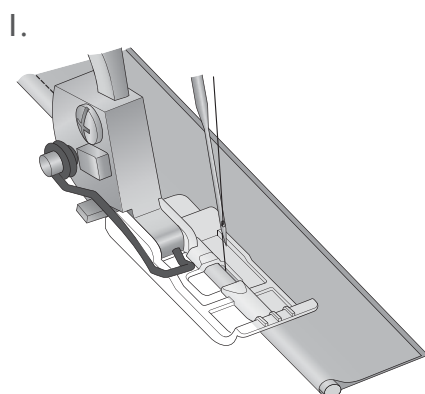

1. Set the machine for Chainstitch.
2. Use the default stitch settings. Adjust if needed.
Note: Although the machine recommends needle D, you will use needle E for this technique instead.
3. Snap on the Piping foot. (The cording guide is not used for this technique.)
4. Place the cord in the groove on the bottom of the foot and pull the cord tail behind the foot about 2½" (5cm).
Note: ¼" - 5/8" (1.5 - 2.0mm) cord can be used.
5. Cut a strip of fabric on the bias, 1" (25mm) wide.
6. Wrap the fabric around the cord in the front of the foot. Slide the fabric under the foot.
7. Lower the presser foot and sew over the cord and fabric (illustration 1). (Hold the cord behind the foot as you begin to sew.)

2.

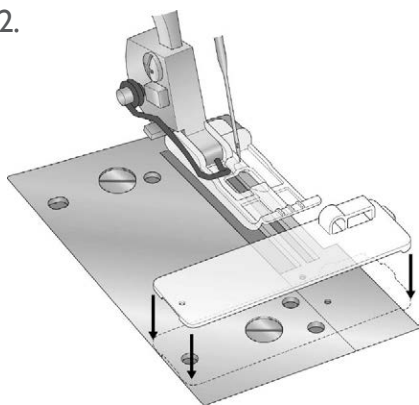

3.

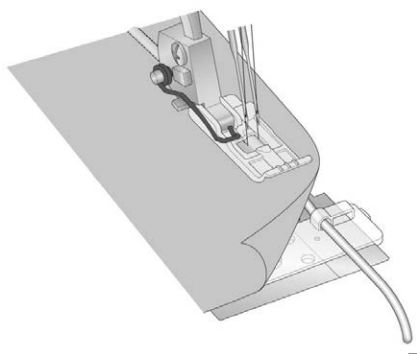

CORDED TUCKS

Achieve a trapunto effect when a coverstitch is sewn over a cord in the guide.

1. Set the machine for coverstitch, wide.
Note: Although the machine recommends needles C and E, you will use needles D and E for this technique instead.
2. Snap on the Piping foot and attach the cording guide as illustrated (illustration 2).
3. Insert the cord into the round hole of the cording guide and position it in the groove on the bottom of the Piping foot.
4. Lay the fabric right side up on top of the cord. Slide it under the foot until it is underneath the needles (illustration 3).
5. Lower the needles into the fabric. Lower the presser foot and start to sew at a medium speed. (Hold the cord behind the foot as you begin to sew.)

DECORATIVE TRIM

Use decorative thread and ribbons to create special effects and unique trims.

4.

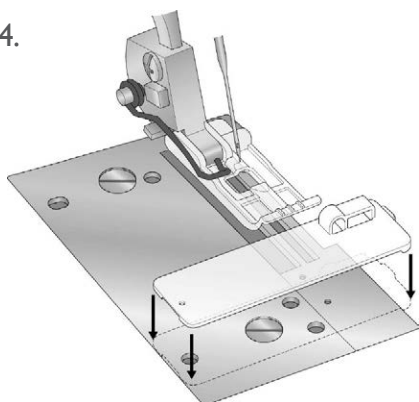

5.

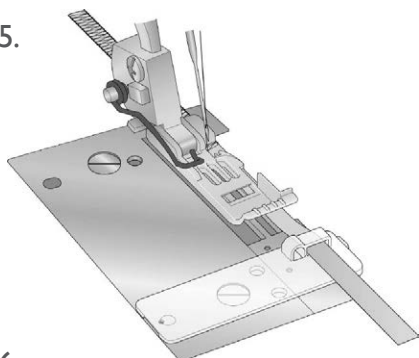

6.



1. Set the machine for 3-thread ornamental flatlock stitch, wide with decorative thread in the loopers.
2. Snap on the standard presser foot and attach the cording guide as illustrated (illustration 4).
3. Insert a ribbon $\frac{1}{4}$ " (6mm) wide right side down into the rectangular opening in the guide.
4. Place the ribbon under the presser foot to the right side of the needle, leaving a 2" (5cm) tail behind the foot.
5. The needle should go down into the machine just beyond, not into, the edge of the ribbon (Illustration 5).
6. Sew over the ribbon to make a decorative trim.

Tip: Make your decorated ribbon long enough to cut it in three pieces, then braid (Illustration 6).

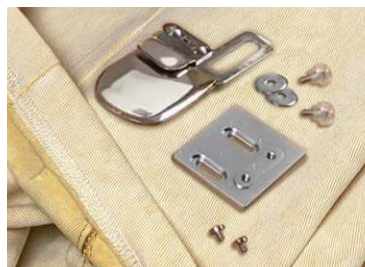

COVERSTITCH HEMMER ATTACHMENT

920634096

For

AMBER™ AIR s|600, HUSKYLOCK™ s21, s25

The Coverstitch hemmer attachment is used to turn under 1 inch (25mm) of fabric, creating a perfectly straight hem without the need for lots of pressing.

Recommended fabric: Woven (light and medium) fabrics and Stretch (light and medium) fabrics.

1. Set the machine for coverstitch either wide, narrow or triple with stitch length 3.0. Place the attachment plate on the machine. Place the two screws in the opening and screw the attachment plate in place.
2. Place the hemmer on the attachment plate and adjust the hemmer to the far right. Secure the hemmer in place with the two thumb screws and washers.
3. Fold under a 1 inch (25mm) hem of fabric and finger press the first few inches in place.
4. Slide the fabric right side up into the hemmer from the right-hand side so that the hem curls under the attachment.
5. Raise the presser foot and pull the fabric under the foot and straight back 1-2" (2-3cm) behind the needle. Lower the presser foot and turn the hand wheel to make a few stitches to secure the stitching in the fabric.
6. Sew a few stitches to see if the coverstitch is in desired position. To change the stitch position, loosen the thumb screws and move the hemmer the left to reach the desired needle position. Test sew a sample before sewing your project.
7. Keep the fabric turned under when feeding into the attachment to ensure the fabric will roll under when sewing.

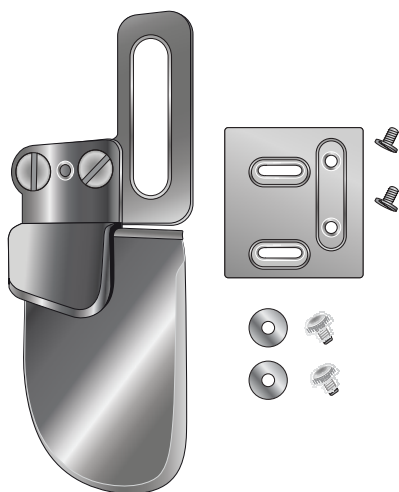

Tips & Hints

1. If free-arm is available on machine, it will make sewing a continuous / circular hem even easier
2. Increase the stitch length up to 4.0 if you have heavier fabric or when crossing a seam.
3. When crossing a seam give the fabric some extra help when it feeds through the hemmer guide.



INSPIRA® COVERSTITCH BINDER

620143096 While stocks last

For

HUSKYLOCK™ s25 and s21 machine and AMBER™ AIR s|600.

The three fold 3/8" (10mm) binder will turn a light weight knitted fabric strip into a binding and attach it to the project edges all in one step.

To bind edges with 3/8" (10mm) Coverstitch Binder, cut a 1 1/8" (28mm) wide strip of light weight knit fabric, such as light weight jersey or interlock.

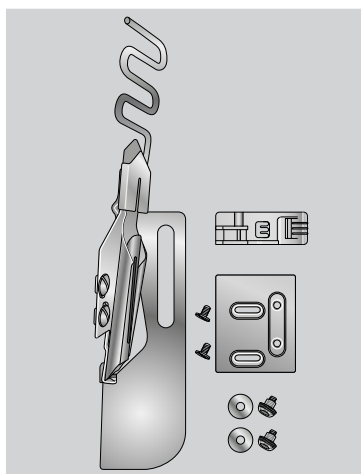



HUSQVARNA® VIKING® LUGGAGE

NEW!

920822096



920821096



920820096

UNIVERSAL MACHINE BAGS

Key Features:

- Fits HUSQVARNA® VIKING® sewing machines and sergers.
- Padded interior protects the machine from dust and damage.
- With four 360° casters and a telescoping handle, traveling is easy and convenient
- Convenient storage.

Available Models:

Large Machine Roller Bag

Small Machine Roller Bag

Serger Roller Bag



HUSQVARNA® VIKING® NOTIONS

NEW!

920728296

QUILTING KIT

The HUSQVARNA® VIKING® Quilting Kit provides a premium assortment of must-have accessories for quilters.

Rotating self healing cutting mat (12" x 12")

Rotary cutting tool + replacement blades

Ruler set (6" x 12" & 6" x 6")

HUSQVARNA® VIKING® Needles:

Universal 80/12 5-pack

Assorted Quilting 5-pack

NEW!

920730096

⑤ ⑥ ⑦ ⑧ ⑨

BOBBIN WINDER

Time Saving - you never have to unthread your machine to wind your bobbin.

- Easy, One-Touch Bobbin Winding with Auto Shut-off when the bobbin is full
- Portable Compact Bobbin Winder Allows You to Easily Take It Anywhere
- Power Adapter (included) or battery-operated
- Custom designed for use with HUSQVARNA® VIKING® Bobbins

Not for

EMERALD™ series, EDEN ROSE™ 250M, TRIBUTE™ 140M, 145M, JADE™ 35, 20, ONYX™ series.



920817096

DESIGNER™ SEWING EMBROIDERY KIT

Key Features includes:

- 8" Bent Tailor Scissors
- 6" Appliqué Scissors
- 4.5" Opposable Curved Tweezers
- 4.5" Thread Ships
- Tape Measure
- 16 R&A Embroidery Thread Spools
- 2 R&A Bobbin Thread Spools
- HUSQVARNA® VIKING® Universal Needle Assorted 5pc
- HUSQVARNA® VIKING® Embroidery Needles Assorted 5pc

Packed in gift box with magnetic closure.



HUSQVARNA® VIKING® SCISSOR COLLECTION

HUSQVARNA® VIKING® SCISSORS

NEW!

3.5" / 8.9CM CURVED EMBROIDERY

Curved blades for hard to reach areas.

Extra-fine sharp point for close cuts and to ensure better accuracy.

920665996

NEW!

4" / 10.2CM MICRO TIP EMBROIDERY

Great for snipping tiny hard to reach places, poking through fabric, snipping tiny tight threads.

Extra-fine sharp point for close cuts and to ensure better accuracy.

920663996

NEW!



920664996

4" / 10.2CM CURVED MICRO TIP EMBROIDERY

Great for snipping tiny hard to reach places, poking through fabric, snipping tiny tight threads.

Curved blades help protect your projects.

Extra-fine sharp point for close cuts and to ensure better accuracy.

NEW!



920666996

4.5" / 11.4CM EASY SNIP

Spring action allows both left handed and right handed people to use.

Perfect for people with ailments that prevent them from using normal thread scissors.

Eliminate those accidental snips of the fabric.

Thin Curved Blade – allows you to get as close as you want without snagging, jabbing or poking your work.

NEW!

4.5" / 11.4CM OPPOSABLE CURVED TWEEZER

Easy Operations- Squeeze to open and let go to close.

Perfect tool for holding your fabric or thread without having to keep the pressure on the tweezers.

Excellent choice for many needle arts and craft projects, and other situations that require a controlled hold of fine objects in place.

920667996

NEW!

6" / 15.2CM DOUBLE CURVED EMBROIDERY

The double-curved design allows comfortable hand positioning above work in the embroidery hoop or at the sewing machine.

The curved blades allow safe controlled cuts ensuring no snagging or gouging of fabric.

920668996

NEW!



920669996

6" / 15.2CM RIGHT HAND APPLIQUÉ

½" duckbill to provide a high degree of precision that makes it possible to trim around edges with ease.

Perfect tool for trimming appliqué and stabilizer from the back of your embroidery as well as cutting close to your seams.

NEW!



920670996

6" / 15.2CM LEFT HAND APPLIQUÉ

True left-handed scissors put your view on the correct side of the cutting blade.

½" duckbill to provide a high degree of precision that makes it possible to trim around edges with ease.

Perfect tool for trimming appliqué and stabilizer from the back of your embroidery as well as cutting close to your seams.

NEW!

920674996

6" / 15.2CM APPLIQUE SCISSOR

Perfect tool for trimming fabric edges and threads closely, accurately and quickly.

Razor sharp edges and tips allow you to cut along the entire length of the blade, all the way to the tip.

NEW!

920671996

6" / 15.2CM SAFETY STILETTO

Compact storage with power lock screw design.

Remove fine stitches and use as a guide for holding or pushing fabric up to the needle.

NEW!



6" / 15.2CM SEAM RIPPER

Extra sharp blade cuts through unwanted stitches easily.

Screw-lock handle for easily replacing blades.

920673996

NEW!



8" / 20.3CM BENT TRIMMER

Bent handle design holds fabric flat.

Long cut ideal for patterns, seams or long cuts.

Sharp edge cuts multiple layers.

Ergonomic, left or right-handed shears make cutting large projects easy and pain-free.

920672996





HUSQVARNA® VIKING® NEEDLES



HUSQVARNA® VIKING® recommends
to change your needle every 6-8 hours
of sewing and/or type of fabric.

NEW!

134R TITANIUM

920709096 (size 100/16 - 10 pack)

920712096 (size 110/18 - 10 pack)

The titanium coating resists adhesives, improves needle wear & penetration of densely woven fabrics.

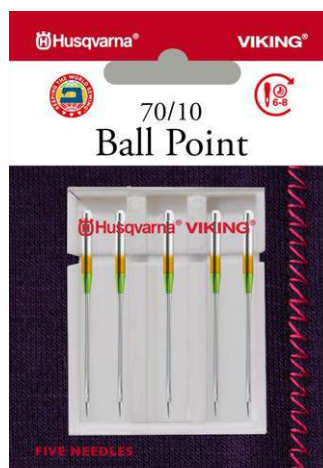
NEW!

BALL POINT

920669096 (size 70/10 - 5 pack)

920670096 (size 80/12 - 5 pack)

920671096 (size 90/14 - 5 pack)

920716096 (size 100/16 - 5 pack)

920672096 (Assorted - 5 pack)

Designed to slide between the yarns of knit fabrics without snagging due to the rounded tip.

NEW!

CUTWORK

920549096 (Assorted - 4 pack)

Create beautiful cutwork and reverse appliqué designs quickly and easily, without any tedious trimming.



HUSQVARNA® VIKING® recommends to change your needle every 6-8 hours of sewing and/or type of fabric.

NEW!



DENIM

920714096 (size 70/10 - 5 pack)

920659096 (size 80/12 - 5 pack)

920660096 (size 90/14 - 5 pack)

920661096 (size 100/16 - 5 pack)

920662096 (size 110/18 - 5 pack)

920551096 (Assorted - 5 pack)

Reduces breakage and skip stitches due do reinforced blade with the rounded tip and tapered end

NEW!



EMBROIDERY (TITANIUM)

920541096 (size 80/12 - 5 pack)

920666096 (size 90/14 - 5 pack)

Guard against excess friction allowing trouble-free embroidery and decorative stitching

NEW!



EMBROIDERY

920664096 (size 80/12 - 5 pack)

920665096 (size 90/14 - 5 pack)

920540096 (Assorted - 5 pack)

Guard against excess friction allowing trouble-free embroidery and decorative stitching



HUSQVARNA® VIKING® recommends to change your needle every 6-8 hours of sewing and/or type of fabric.



LEATHER

920673096 (size 80/12 - 5 pack)

920543096 (size 90/14 - 5 pack)

920674096 (size 100/16 - 5 pack)

920675096 (size 110/18 - 5 pack)

Cuts through leather and other heavy non-woven imitation leathers and suedes without creating large holes due to the needles wedge shape slightly sharp cutting point.



MICROTEX

920676096 (size 60/08 - 5 pack)

920677096 (size 70/10 - 5 pack)

920678096 (size 80/12 - 5 pack)

920679096 (size 90/14 - 5 pack)

920545096 (Assorted - 5 pack)

Perfect for microfibers, polyester and other synthetic fabrics. This needle is indicated for topstitching and precision quilt piecing due do very slim acute point.



OVERLOCK

920680096 (size 80/12 - 5 pack)

920542096 (size 90/14 - 5 pack)

Designed specifically for overlock stitching.



HUSQVARNA® VIKING® recommends to change your needle every 6-8 hours of sewing and/or type of fabric.

NEW!



QUILTING (TITANIUM)

920683096 (size 80/12 - 5 pack)

920684096 (size 90/14 - 5 pack)

Allows easier fabric penetration and helps eliminate skipped stitches with a special tapered tip of the needle.

NEW!



QUILTING

920681096 (size 80/12 - 5 pack)

920682096 (size 90/14 - 5 pack)

920544096 (Assorted - 5 pack)

Allows easier fabric penetration and helps eliminate skipped stitches with a special tapered tip of the needle.

NEW!



STRETCH

920703096 (size 80/12 - 5 pack)

920550096 (size 90/14 - 5 pack)

Perfect for sewing through stretch fabrics, with the rounded point to pierce through thicker fabrics.



HUSQVARNA® VIKING® recommends to change your needle every 6-8 hours of sewing and/or type of fabric.



TOPSTITCH

920686096 (size 80/12 - 5 pack)

920539096 (size 90/14 - 5 pack)

920687096 (size 100/16 - 5 pack)

Achieve perfectly straight stitch lines for heavy or multiple threads with the long eye of the needle.



TWIN DENIM

920713096 (4.0mm - size 100/16 - 1 pack)

Create two rows of stitches simultaneously and uses two spools of thread and one bobbin thread.

Reduces breakage and skipped stitches due to reinforced blade with the rounded tip and tapered end.



TWIN EMBROIDERY

920718096 (2.0mm - size 75/11 - 1 pack)

Create two rows of stitches simultaneously and uses two spools of thread and one bobbin thread.

Large eye and rounded point provide trouble-free embroidery and decorative stitching.



HUSQVARNA® VIKING® recommends to change your needle every 6-8 hours of sewing and/or type of fabric.

NEW!

TWIN STRETCH

920547096 (2.5mm - size 75/11 - 1 pack)

920548096 (4.0mm - size 75/11 - 1 pack)

920685096 (4.0mm - size 80/12 - 1 pack)

Creates a dual stitch through stretch fabric with a rounded tip of the needle to pierce through thicker fabric.

NEW!

TWIN UNIVERSAL

920721096 (1.6mm - size 70/10 - 1 pack)

920654096 (1.6mm - size 80/12 - 1 pack)

920655096 (2.0mm - size 80/12 - 1 pack)

920546096 (2.5mm - size 80/12 - 1 pack)

920657096 (3.0mm - size 90/14 - 1 pack)

920658096 (4.0mm - size 80/12 - 1 pack)

920656096 (4.0mm - size 90/14 - 1 pack)

920717096 (4.0mm - size 100/16 - 1 pack)

Create two rows of stitches simultaneously and uses two spools of thread and one bobbin thread.

NEW!

TWIN WING

920722096 (2.5mm - size 100/16 - 1 pack)

For beautiful hem stitches, a wing needle punches a hole into your fabric while the sewing machine stitches around the piercing.



HUSQVARNA® VIKING® recommends to change your needle every 6-8 hours of sewing and/or type of fabric.

HUSQVARNA® VIKING® NEEDLES

NEW!

UNIVERSAL (TITANIUM)

920697096 (size 80/12 - 5 pack)

920698096 (size 90/14 - 5 pack)

Easily slips through weave of knits and woven fabric with rounded tip and tapered end.

NEW!

UNIVERSAL

920705096 (size 60/08 - 5 pack)

920688096 (size 70/10 - 5 pack)

920537096 (size 80/12 - 5 pack)

920689096 (size 90/14 - 5 pack)

920690096 (size 100/16 - 5 pack)

920691096 (size 110/18 - 5 pack)

920692096 (Assorted - 5 pack)

920693096 (size 70/10 - 10 pack)

920694096 (size 80/12 - 10 pack)

920695096 (size 90/14 - 10 pack)

920696096 (size 100/16 - 10 pack)

920538096 (Assorted - 10 pack)

Easily slips through weave of knits and woven fabric with rounded tip and tapered end.

NEW!

WING

920667096 (size 100/16 - 1 pack)

920668096 (size 120/21 - 1 pack)

For beautiful hem stitches, a wing needle punches a hole into your fabric, while the sewing machine stitches around the piercing.



HUSQVARNA® VIKING® recommends to change your needle every 6-8 hours of sewing and/or type of fabric.



VIKING and KEEPING THE WORLD SEWING are exclusive trademarks of Singer Sourcing Limited LLC or its Affiliates. HUSQVARNA and the "H" Crown Device are trademarks of Husqvarna AB and are used under license. All other trademarks are property of Singer Sourcing Limited LLC or its Affiliates. © 2024 Singer Sourcing Limited LLC or its Affiliates. All rights reserved.

2024-1A

Item #920741096



7 393033 133054